

IRON BALTIC

DOWNLOAD MULTILINGUAL
USER MANUAL

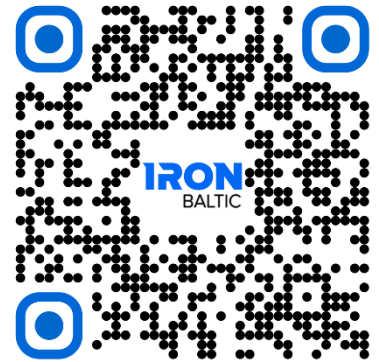

code.ironbaltic.com/u/xKshLOKa

USER MANUAL

Trailer IB-1200 R1A

Code 86.1100
Version 26092024



**This user manual should be considered as part of the machine.
Keep this manual for future reference!**

If you need any spare parts, please send this packaging data to your local dealer or to Iron Baltic
sales@ironbaltic.com



USER MANUAL CONTENTS

- 1. TRAILER IDENTIFICATION 4
- 2. INTRODUCTION 5
- 3. SAFETY INFORMATION 6
 - 3.1. Danger symbol 6
 - 3.2. Meaning of words 6
 - 3.3. General safety rules..... 6
 - 3.4. Safety notes 7
 - 3.5. Safety labels 9
- 4. USER MANUAL 10
 - 4.1. Technical description 10
 - 4.2. Traffic 11
 - 4.3. Before driving 11
 - 4.4. Connecting the trailer..... 11
 - 4.5. Disconnecting the trailer 12
 - 4.6. Loading..... 13
 - 4.7. Lifting with a crane..... 14
 - 4.8. Cargo box / Flatbed 14
 - 4.9. Cleaning 15
- 5. MAINTENANCE 16
 - 5.1. Maintenance intervals..... 16
 - 5.2. Maintenance 16
 - 5.2.1. Lifting points 16
 - 5.2.2. Wheels and tires..... 17
 - 5.2.3. Towing coupling..... 18
 - 5.2.4. Electrical system..... 18
 - 5.2.5. Lubrication..... 19
 - 5.2.6. Tightening torques 19
 - 5.3. Maintenance materials..... 19
 - 5.4. Storage..... 20
- 6. TECHNICAL DATA 21
- 7. WARRANTY CONDITIONS..... 22
- 8. ACCESSORIES 23
- 9. SPARE PARTS LIST 24
- 10. ASSEMBLY INSTRUCTIONS 26



1. TRAILER IDENTIFICATION

This user manual is for Iron Baltic IB-1200 R1A trailer models. The model can be identified by the identification number located on the vehicle:

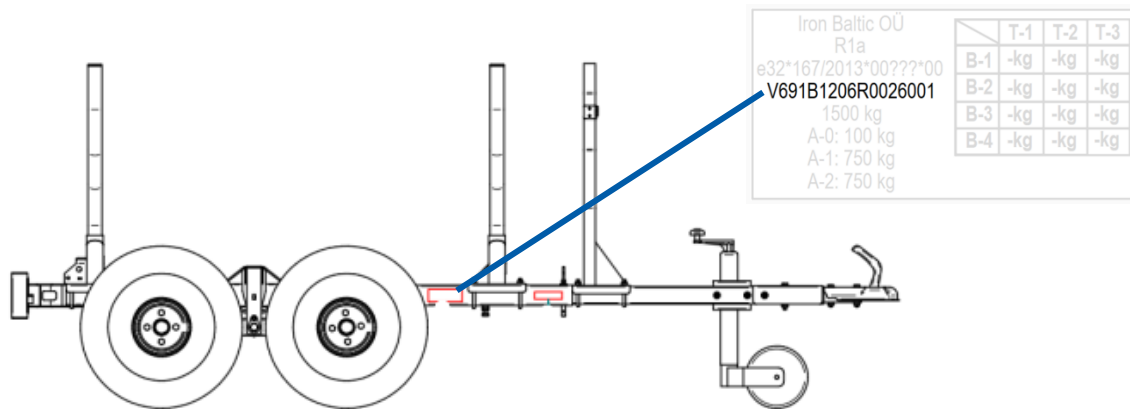

Note the 17-digit trailer identification number from the data plate for future reference and when ordering spare parts:

| 1 | 2 | 3 | 4 | 5 | 6 | 7 | 8 | 9 | 10 | 11 | 12 | 13 | 14 | 15 | 16 | 17 |
|---|---|---|---|---|---|---|---|---|----|----|----|----|----|----|----|----|
| V | 6 | 9 | 1 | B | 1 | 2 | 0 | | | 0 | 0 | 2 | 6 | | | |

Manufacturer details:

Iron Baltic OÜ
 Joa tee 17
 76903 Harku
 ESTONIA
www.ironbaltic.com

Dealer details:

2. INTRODUCTION

Thank you for choosing Iron Baltic product. This manual contains specifications for the trailer IB-1200 R1A and instructions for product assembly, safe operation and maintenance.

This manual covers all the equipment that is provided with the trailer and therefore you may find explanations that are not installed on your trailer.

Unnecessary use of the trailer can result economic damage and personal injury, so it is very important that the person who using the product read and use this manual in accordance with the requirements. Any misuse of the product will release the manufacturer from liability for any damage or expense incurred.

NOTE: Photos and drawings in this manual may not necessarily depict the actual models of trailer or their accessories. They are merely given as a frame of reference and are based on the latest available information at the time of publication.

3. SAFETY INFORMATION

3.1. Danger symbol



This is a danger symbol. This symbol is used throughout this manual and on warning labels to highlight information about potential safety issues. When you see this symbol, be alert to the possibility of injury and carefully read the message following the symbol and inform other users.

3.2. Meaning of words



WARNING indicates a potentially hazardous situation which, if not avoided, could result in death or serious injury.



CAUTION indicates a potentially hazardous situation which, if not avoided, could result in injury.



IMPORTANT: Indicates instructions that, if not followed, could result in damage or destruction to the product or its surroundings.



NOTE: A useful note or tip for handling the product.

3.3. General safety rules



WARNING Before using the trailer, read the safety instructions carefully and make sure you understand them. Follow all instructions and require everyone who uses this equipment to follow them. Improper use can cause injury and damage to the machine.



WARNING If the trailer becomes damaged during use, work must be stopped immediately and the damage must be inspected. Damage (cracks in the structure or welded joints, deformed parts)

can endanger property and human health. Work must not be continued until the damage has been repaired.

Most accidents happen due to carelessness. Avoid accidents by following the instructions below.

The vehicle together with the trailer form a long machine that is difficult to manoeuvre, making it difficult to work in small and narrow areas.

TRAINING

- Read thoroughly the safety instructions and terms of use
- Never allow children to operate the vehicle or the trailer.
- Neither the vehicle nor the trailer can be used while drunk or under the influence of drugs that affect perception or reaction
- Do not allow bystanders, especially children or animals into the work zone.
- Remember that a trailer attached to the vehicle changes the vehicle's handling and manoeuvrability.
- Remember that there is a risk of overturning when driving on slopes.

PROHIBITED ACTIONS

- It is forbidden to use the trailer on steep slopes.
- It is forbidden to use the trailer if all fastening elements are not properly fastened.
- It is forbidden to use the trailer before you have carefully read the entire instruction manual.
- It is forbidden to drive over the 40 km/h or the speed recommended by the towing vehicle manufacturer (whichever is lower), when towing trailer
- It is forbidden to transport people on the trailer.
- It is forbidden to install additional equipment on the trailer that has not been approved by the manufacturer.

MANDATORY ACTIONS

⚠ WARNING Before starting work, check that the trailer is in good technical condition and that the coupling head is properly connected to the vehicle's towbar.

- Follow all the instructions of the towing vehicle manufacturer.
- Always use proper protective equipment (helmet, etc.) when working on the vehicle.
- Make sure that bystanders are moved to a safe distance when operating the trailer.

⚠ WARNING Stay away from the area between the vehicle and trailer.

- Clear the work area of any potential hazards.
- Ensure that all safety decals are in good condition – replace damaged decals with new ones if necessary.
- Always choose the right speed for the situation. Reduce speed when working on a hillside or uneven terrain.

- Be careful when braking and turning.
- Observe the permitted trailer loads.
- Always ensure safe roadholding of the vehicle and use appropriate accessories (chains, counterweights, etc.).
- Distribute the load to the trailer as evenly as possible (it is recommended to place heavy objects in the middle above the axle).
- Always ensure that all components are installed correctly
- Check the tightness of the bolts after the first hour of operation. Later, do this every ten hour of operation.
- When finishing work, stop the vehicle engine and activate the parking brake
- There must be no load in the box when uncoupling the trailer.

3.4. Safety notes

⚠ WARNING Before using the trailer, read the safety instructions carefully and make sure you understand them. Follow all instructions and require everyone who uses this equipment to follow them. Improper use can cause injury and damage to the machine.

⚠ WARNING If the trailer becomes damaged during use, work must be stopped immediately and the damage must be inspected. Damage (cracks in the structure or welded joints, deformed parts) can endanger property and human health. Work must not be continued until the damage has been repaired.

⚠ WARNING Before starting work, check that the trailer is in good technical condition and that the coupling head is properly connected to the vehicle's towbar.

⚠ WARNING Stay away from the area between the vehicle and trailer.

⚠ WARNING Risk of injury if the trailer becomes separated from the towing vehicle for any reason. Install the safety cable before each use.

⚠ WARNING If the hitch pointer is in the "⚠" zone (condition of the towbar is deteriorated) or "OPEN" zone (the hitch is not properly closed), the trailer must not be used. The coupling may come loose while driving.

⚠ WARNING Risk of accident due to unintended contact of the support wheel with the road if it is not fully raised and secured while driving. Before setting off, always make sure that the support wheel is not loose or secured against coming loose. To do this, fully raise the wheel and tighten the retaining clamp.

⚠ IMPORTANT: Do not load the trailer beyond the permitted weights. The maximum permissible gross trailer weight, the permissible towing weight and the permissible axle weights are shown on the data plate.

| | | | |
|----------------------|--|--|--|
| Iron Baltic OU | | | |
| R1a | | | |
| e32*167/2013*00??*00 | | | |
| V691B1206R0026001 | | | |
| 1500 kg | | | |
| A-0: 100 kg | | | |
| A-1: 750 kg | | | |
| A-2: 750 kg | | | |

| | | | |
|-----|-----|-----|-----|
| | T-1 | T-2 | T-3 |
| B-1 | -kg | -kg | -kg |
| B-2 | -kg | -kg | -kg |
| B-3 | -kg | -kg | -kg |
| B-4 | -kg | -kg | -kg |

⚠ IMPORTANT: When cleaning the trailer, avoid using high-pressure washers with too high pressure as they can damage connections, electrical connectors or loose parts.

⚠ IMPORTANT: The following parts must not be directly sprayed with a pressure washer:

- all electrical parts and connections,
- nameplate and safety stickers,
- coupling device

⚠ WARNING Undetected cracks, sidewall damage or punctures can cause a tire to burst unexpectedly

⚠ WARNING Too high a pressure can cause the tire to burst unexpectedly or deform, which reduces tread grip and increases wear. Check the tire sidewall for the maximum allowable pressure values.

⚠ WARNING Driving with underinflated tires causes increased flexing of the tire sidewall, which generates excessive heat and can lead to a tire blowout.

⚠ WARNING Failure to comply with wheel tightening torques can cause serious hazards, such as the risk of the wheel coming loose while driving. Danger can be caused by overtightening, under tightening, or uneven tightening.

⚠ CAUTION It is forbidden to install the cargo / flatbed with a load in it to the trailer!

⚠ IMPORTANT: Moisture can cause rusting.

⚠ IMPORTANT: Only spare parts that meet the trailer manufacturer's specifications may be used for repairs and maintenance.





⚠ IMPORTANT: The tire manufacturer may specify a different tire pressure than the one listed in the table, depending on the characteristics of the specific tire. Always check the tire sidewall for the optimal pressure value and inflate the tire accordingly.





⚠ IMPORTANT: Electrical system repair work may be performed by qualified mechanics.

3.5. Safety labels

The safety labels shall be present on your trailer. If any of those labels is absent or gets damaged, contact your dealer in order to install new labels in place of the absent ones before operating the machine.

Meaning of safety labels:

| | |
|---|---|
|  | Maximum permitted speed 40 km / h! |
|  | Maximum gross weight 1500 kg! |
|  | Never carry any passenger on the trailer! |
|  | It is forbidden to drive slopes over 15°! |
|  | When lowering the box, ensure that the limbs do not fall between the box and the frame! |

| | |
|--|--|
|  | Trace the surroundings when tilting the load and make sure it is safe! |
|  | After tilting the load, there may be an obstacle between the cargo box and ground, which may cause cargo box spontaneous lowering. |
|  | Uneven load distribution may cause the load to move. Make sure that limbs do not get stuck between load and trailer! |
|  | Read the manual before use! |

4. USER MANUAL

4.1. Technical description

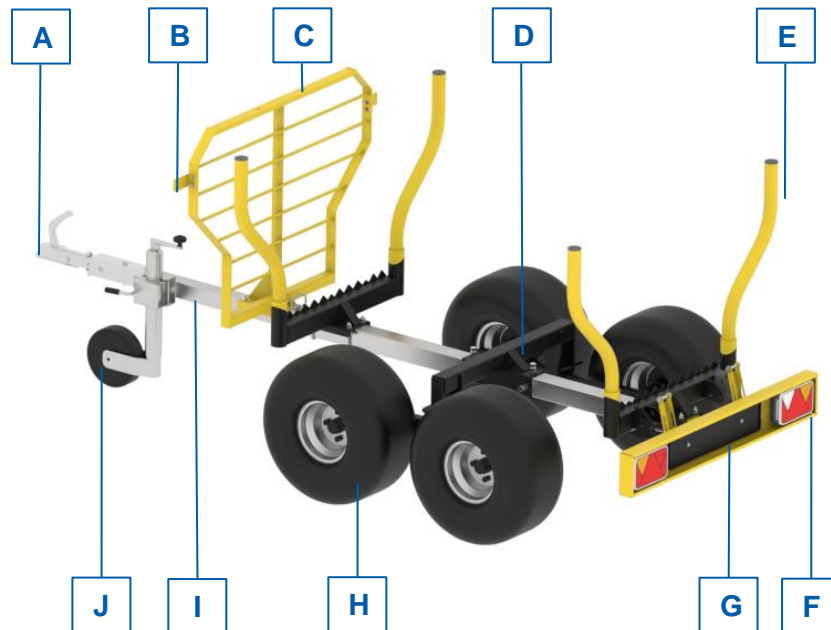

A – tow coupling
 B – front reflector
 C – protective fence
 D – axle
 E – log bolster

F – rear light
 G – license plate
 H – wheel
 I – frame tube
 J – support wheel

The Iron Baltic IB 1200 is a durable timber trailer that can be attached to the ATV or UTV and carry up to 1200 kg load.

Trailer electrical connection uses 7-PIN automotive trailer connector. The trailer is designed for ATVs and UTVs but can be towed with any other vehicle equipped with a 50 mm hitch ball. Trailer does not cause notable damage to the terrain and can be easily manoeuvre between trees, allowing access to places where large tractors are not accessible. The four-wheeled tandem axle, combined with wide tires, gives the trailer excellent off-road capabilities, allowing you to easily move over stumps and ditches.

The length of the trailer is adjustable, which allows to transport logs up to 3,5 meters in length. Trailer log bolsters are removable which is good when loading the trailer. In addition, the log bolsters are turn able, which means that contact with an obstacle does not cause major damage to the trailer. Cargo box (86.2000) is designed for transporting various goods and materials. The front and rear panels of the box are removable and in addition, it is possible to add side extensions (86.2500) to the cargo box which allows to transport oversized loads. Cargo box tilting is possible by assembling the trailer with crane (23.3000).

Flatbed (86.5000) is designed for transporting various goods and materials. Thanks to the flat bottom, it can be used to transport pallets, for example. The side and end panels (86.5100) mounted on the flatbed can be open and are easy to remove, which allows to load the trailer from the side also. As an option, the flatbed can be fitted with side extensions (86.5200), a log and IBC container transport kit (86.5300), watering pipe (91.1030) and PVC cover (86.5400). Flatbed box tilting is possible by assembling the trailer with crane (23.3000).

The trailer crane (23.3000) is equipped with an electric winch and is designed to lift logs and other loads and it can be used to tilt the cargo box also. With the crane, it is easy to mount the cargo box on to a trailer and can be done as a one-man job.

4.2. Traffic

- When driving on public roads, follow the applicable traffic regulations.
- When driving with a trailer, take into account weather conditions, road surface and driver experience.
- The maximum permitted speed when towing a trailer is 40 km/h, or the maximum speed permitted by the manufacturer of the towing vehicle (whichever is lower).

4.3. Before driving

- Before driving, check the attachment of the towbar to the drawbar.
- Before driving, make sure that the support wheel is raised and securely attached.
- Before driving, make sure that all moving parts (load posts, drawbar tube, towbar, box doors) are properly attached and/or locked.
- Before driving, check that the tow ball is securely in the grip of the towbar (the locking status is visible on the towbar indicator).
- Before driving, check the condition of the tires and the tire pressure (recommended pressure is 1.5 bar).
- Before driving, check the tightness of the wheel bolts.

4.4. Connecting the trailer

1. Turn the coupling head to the appropriate height using the support wheel. Place the coupling head over the towing ball of the vehicle.
2. Hang the safety cable on the eye provided on the coupling head or directly on the coupling head carrier (not permitted in some countries) or on the vehicle frame. Make sure that the safety cable is long enough to pass through bends.

⚠ WARNING Risk of injury if the trailer becomes separated from the towing vehicle for any reason. Install the safety cable before each use.

3. Lower the support wheel until the ball joint audibly clicks into place. Check the position of the safety indicator: The pointer must be in the zone marked "OK" or "◀".



⚠ WARNING If the hitch pointer is in the "⚠" zone (condition of the towbar is deteriorated) or "OPEN" zone (the hitch is not properly closed), the trailer must not be used. The coupling may come loose while driving.

4. Check the correctness of the coupling by lifting the drawbar.
5. Connect the electrical plug to the socket of the vehicle.
6. Screw the support wheel completely up. Make sure that the fork of the support wheel fits into the notches in the housing and tighten. Raise the support wheel as high as possible. The wheel must always be placed parallel to the direction of travel.

⚠ WARNING Risk of accident due to unintended contact of the support wheel with the road if it is not fully raised and secured while driving. Before setting off, always make sure that the support wheel is not loose or secured against coming loose. To do this, fully raise the wheel and tighten the retaining clamp.

4.5. Disconnecting the trailer

1. Park the trailer on a flat and stable surface.
2. Disconnect the electrical plug from the towing vehicle's socket.
3. Adjust the support leg to the appropriate height from the clamp and then turning the support wheel handle to move it downwards.
4. Release the coupling head handle lock "R" and pull it up "D" while turning the support leg downwards by turning the crank until the tow ball is fully visible.
5. Release the safety cable from the towing vehicle.

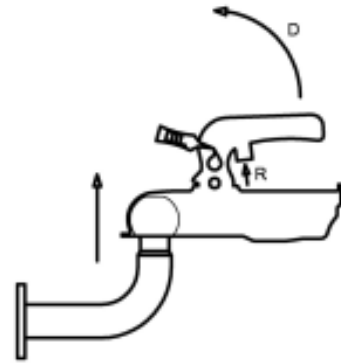

4.6. Loading

The placement of the load on the trailer affects the handling of the trailer and the vehicle. Proper load placement improves safety, handling and reduces wear on both the towing vehicle and the trailer.

! IMPORTANT: Do not load the trailer beyond the permitted weights. The maximum permissible gross trailer weight, the permissible towing weight and the permissible axle weights are shown on the data plate.

| | | | |
|----------------------|--|--|--|
| Iron Baltic OÜ | | | |
| R1a | | | |
| e32*167/2013*00??*00 | | | |
| V691B1206R0026001 | | | |
| 1500 kg | | | |
| A-0: 100 kg | | | |
| A-1: 750 kg | | | |
| A-2: 750 kg | | | |

| | | | |
|-----|-----|-----|-----|
| | T-1 | T-2 | T-3 |
| B-1 | -kg | -kg | -kg |
| B-2 | -kg | -kg | -kg |
| B-3 | -kg | -kg | -kg |
| B-4 | -kg | -kg | -kg |

- Load the trailer evenly and in such way that the center of the load is as close to the axle as possible. If necessary, extend the trailer by changing the length of the drawbar. To adjust, loosen the locking nuts and tightening bolts on the frame tube and remove the pin. Then select the appropriate drawbar length according to the load being transported. Secure the length with a pin and tighten the tightening bolts and the locking nuts. The drawbar tube can be set to five different lengths:

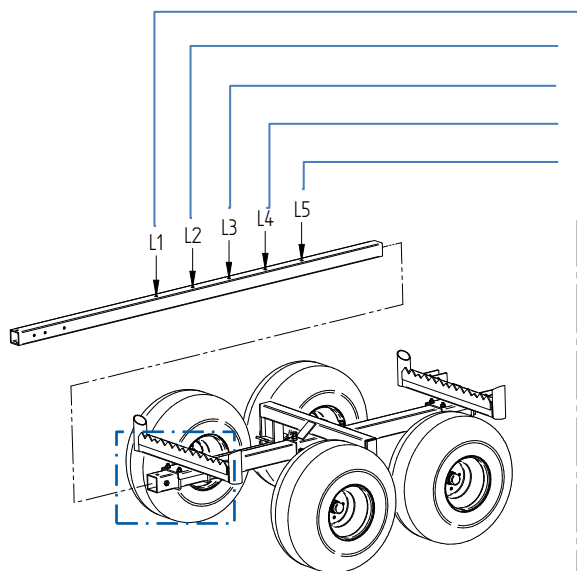

- for carrying loads up to 1900 mm in length
- for carrying loads between 1900 mm and 2300 mm
- for carrying loads between 2300 mm and 2700 mm
- for carrying loads between 2700 mm and 3100 mm
- for carrying loads between 3100 mm and 3500 mm

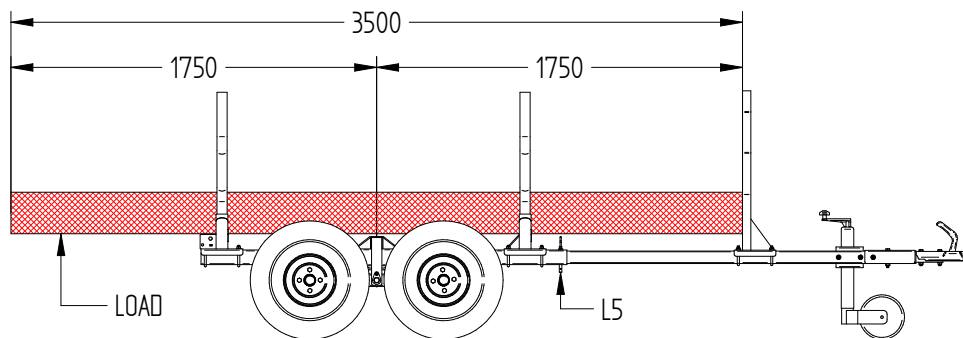
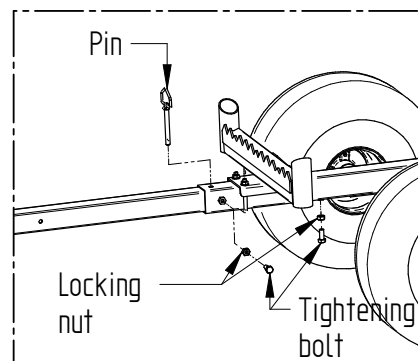

Example: Drawbar length L5, load length 3500 mm

- When loading take into account that the load to the hitch ball should not exceed 100 kg, or the weight specified by the manufacturer of the vehicle (lower weight must be observed).
- Make sure that the load does not extend over the edges.
- If load extends more than one meter beyond the rear of the trailer, a red and white striped overhanging load sign and a

red light must be attached to it. If the load obscures the vehicle's lights and/or registration plate, additional rear lights and/or a duplicate sign must be used.

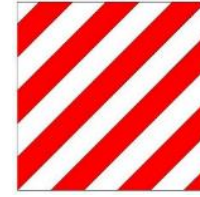

4.7. Lifting with a crane

- Before starting work with a crane, apply the parking brake of the vehicle and fix the crane support legs on a hard and level surface.
- When installing the fastening devices required for lifting the load, take into account the center of gravity of the load. Stop the lift at a height of half a meter and check the balance of the load being lifted and the strength of the fastenings.
- When lifting with a crane, make sure that the load cannot slip on the lifting ropes.
- Do not start lifting with a crane if you are not sure of the strength of the connection.
- Do not exceed the maximum lifting capacity of the crane.

4.8. Cargo box / Flatbed

- To install cargo box/flatbed with crane:
 - a. Stop the trailer as close to the side of the cargo / flatbed as possible
 - b. Apply the vehicle parking brake.
 - c. Set drawbar length to length L1.
 - d. Fix the crane support legs to a hard and level surface.
 - e. Set the crane boom to the highest position and remove the pin that restricts lateral movement.
 - f. Attach the 4-prong lifting strap to the lifting points on the box/flatbed. In case of the flatbed, side panels must be removed before.
 - g. Start lifting, if necessary, guide the movement of the box/flatbed by hand.
 - h. Fix the box/flatbed to the rear carrier with pins.

CAUTION It is forbidden to lift the cargo / flatbed with a load in it!

- When using a box/flatbed, make sure that the box clamps are locked before loading the load.
- To tilt the load from the box/flatbed, open the box clamps and lift the box.
- When tilting the box/flatbed with a crane, use the highest crane boom position and the shortest boom length.
- When tilting the box, prefer to use the lifting adapter on the front of the box and use the lifting eye inside the box only when necessary.

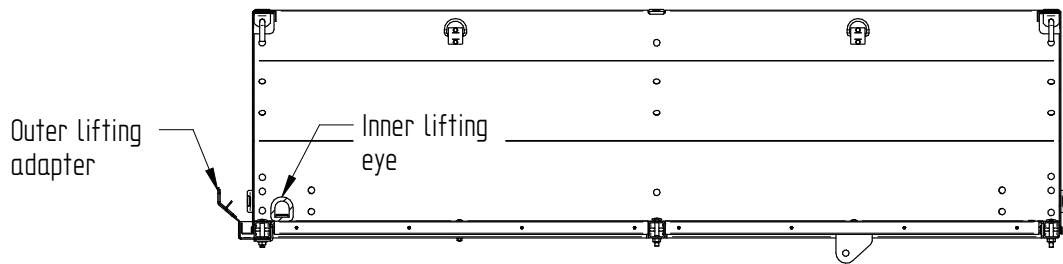

4.9. Cleaning

Cleaning the trailer after use is important to ensure its long service life, appearance and technical condition. The trailer should be cleaned as needed and before longer breaks in use.

- Remove any load residue.
- Use running water to remove heavy dirt. Car shampoo is very suitable for washing the trailer.
- Pressure washer can be used to clean the trailer. Before using a pressure washer, familiarize yourself with the safe operation of this device.

! IMPORTANT: Avoid using pressure washers with too high pressure, as they can damage connections, electrical connectors or loose parts.

! IMPORTANT: Do not spray the following parts directly with a pressure washer:

- all electrical parts and connections,
- data label and safety labels
- tow coupling

- Clean the wheels and chassis, as they often accumulate mud, road dust and salt. This is especially important after winter use or if the trailer has been on salted roads.
- Clean the coupling from dirt and lubricate it with a special lubricant to prevent corrosion.
- Clean the connectors. Dry thoroughly and lubricate the contacts with electrical contact grease if necessary.
- After washing, dry the trailer carefully, especially if it will be stored for a long time.

! IMPORTANT: Moisture can cause rusting.

5. MAINTENANCE

⚠ WARNING During any maintenance or repair work there must not be load in trailer.

⚠ IMPORTANT: Only parts that meet the trailer manufacturer’s specifications may be used for repairs and maintenance.

5.1. Maintenance intervals

To keep your trailer in good condition, it must be maintained regularly. Regular and correctly performed maintenance is a prerequisite for the validity of the warranty.

| Maintenance activity: | Interval | | | |
|--|-----------------------|--------|---------|------------|
| | Before and after work | Weekly | Monthly | Seasonally |
| Wheels | | | | |
| Check tire pressure | x | x | x | x |
| Check tire tread wear | | x | x | x |
| Check tires for damage | | x | x | x |
| Check wheel nuts for correct tightening torque | | | x | x |
| Wheel bearing play and freedom of movement | | | | x |
| Lubrication of wheel swing | | | x | x |
| Body | | | | |
| Check lights | x | x | x | x |
| Check condition of all connecting parts | | x | x | x |
| Check bolted connections | | | | x |
| Electrical system | | | | x |
| Check safety stickers | | x | x | x |
| Tow coupling | | | | |
| Check hitch mounting bolts | | x | x | x |
| Lubrication of tow coupling | | | x | x |
| Lubrication of rotating tow coupling | | | | x |

5.2. Maintenance

5.2.1. Lifting points

When lifting the trailer to change a wheel and/or perform other maintenance, connect the trailer to the vehicle and block the wheels with suitable chocks. Place the jack under the axle beam.

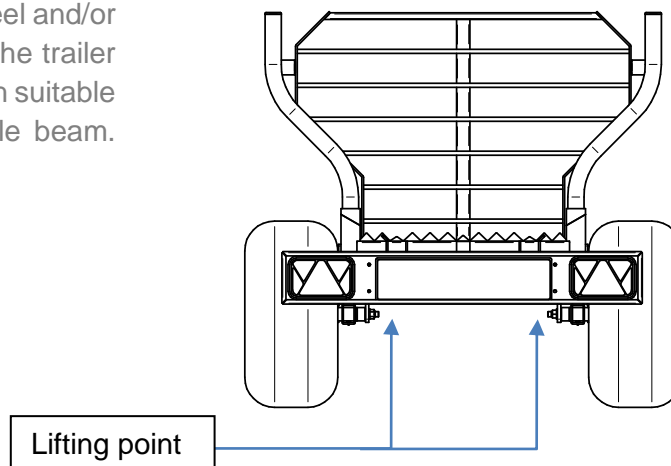

5. MAINTENANCE

5.2.2. Wheels and tires

Regularly checking the condition of your tires is critical for safety and driving comfort.

Check the tires for even wear. Uneven wear indicates incorrect tire pressure or problems with the axles.

Visually inspect for damage such as cracks, splits, sidewall damage, foreign objects or other damage.

Changing a wheel

Only change a trailer wheel on level, hard ground by placing a jack under the end of the vertical tube of the axle frame

Tire pressures

Check tire pressure regularly and especially after each tire change. Check tire pressure with cold tires.

Only use rims and tires of the correct size. The load and speed ratings of the tires used on the trailer must meet the following minimum values:

| Tire size | Load rating | Speed rating (40 km/h) | Nominal pressure (bar) |
|------------|-------------|------------------------|------------------------|
| 22x11.00-8 | 74 | A8 | 1,5 |

IMPORTANT: The tire manufacturer may specify tire pressures that differ from the table above, depending on the characteristics and use of the tire. Always check the tire manufacturer's specified pressure value and inflate the tire accordingly.

WARNING Unnoticed cracks, sidewall damage or penetrating damage can cause the tire to burst unexpectedly.

Repair only suitable damage (e.g. small punctures in the center of the tread); sidewall damage should not be repaired.

Check the tread depth according to the requirements of the country of use.

WARNING Too high a pressure can cause the tire to burst unexpectedly or change the tire's shape, which reduces tread grip and increases wear. Check the tire sidewall for the maximum permissible pressure values.

WARNING Driving with underinflated tires causes increased flexing of the tire sidewall, which generates excessive heat and can lead to a tire blowout.

Tightening torques

⚠ WARNING Failure to observe the wheel tightening torques can cause serious danger, for example, the risk of the wheel coming loose while driving. Danger can be caused by overtightening, under tightening, or uneven tightening.

Tightening torque of the wheel bolts must be checked after removing and reinstalling the wheels, then after the first 50 km and subsequently according to the maintenance schedule. The contact surfaces of the wheels

and hubs must be clean to secure the wheels:

Tighten the wheel bolts with a torque wrench to the specified tightening torque:

| Wheel bolt | Torque |
|----------------|------------|
| M12 x 1.5 x 25 | 80 – 90 Nm |

If the trailer has been used with loose wheel bolts, the bolts and the rim mounting holes must be checked for damage. If damaged, the bolts or rim must be replaced.

5.2.3. Towing coupling

Proper maintenance ensures easy use and proper functioning of the towing coupling.

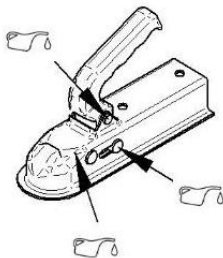

According to the maintenance interval and if the towing coupling is difficult to operate, all joints must be cleaned and lubricated at the indicated points (see diagram).

Clean the surface before lubrication. Remove dirt, old grease and corrosion so that the new grease layer can work effectively. Do not overlubricate, as excess grease can collect dirt and reduce the efficiency of the components.

If the towing device indicator shows ("⚠"), first check the wear of the coupling ball (minimum Ø 49 mm). If the ball has not worn beyond the permissible limit, the coupling ball is worn and must be replaced.

⚠ WARNING If the pointer is in the „⚠“, zone, the trailer must not be used. The coupling may come loose while driving.

5.2.4. Electrical system

⚠ IMPORTANT: Repairs or modifications to the electrical system may only be carried out by qualified mechanics.

- Check that the trailer is disconnected from the towing vehicle's electrical system (remove the plug).
- Check the wiring for cracks or mechanical damage.
- Check that the wiring is securely fastened and does not come into contact with sharp edges or moving parts.
- Check the connections (terminals, sockets)
 - make sure they are securely fastened,

undamaged and free of corrosion. If necessary, use contact cleaner and a soft brush to remove dirt and corrosion. If necessary, lubricate the connector contacts with special contact grease to prevent moisture damage.

- Functional test of the lamps:
 - Connect the trailer to the vehicle and switch on the lights (tail lights, direction indicators, brake lights, position lights). Check that all lights are working.
 - The trailer is equipped with LED rear lights. If any function of the lamp is not working, the entire lamp must be replaced.

5.2.5. Lubrication

According to the maintenance interval, all moving parts must be lubricated at the indicated points (see diagram)

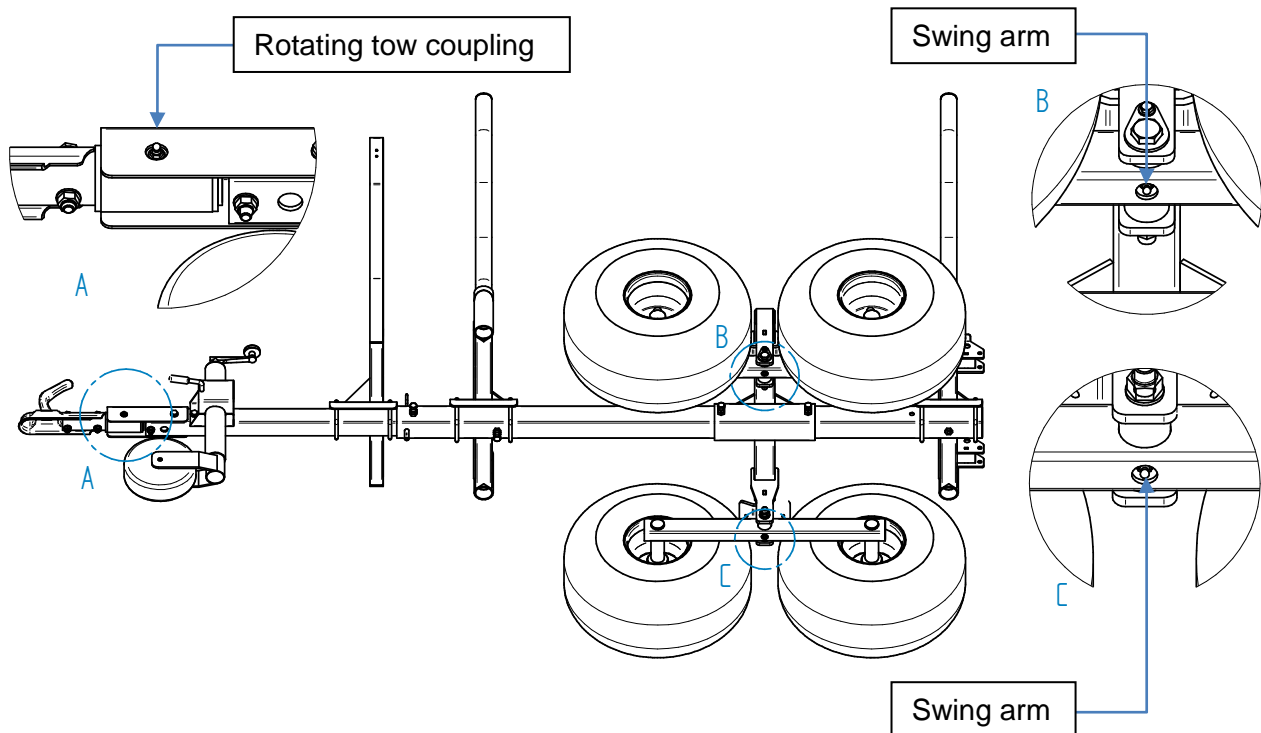

5. MAINTENANCE

5.2.6. Tightening torques

Tightening torque for bolts:

| Thread size | Strength class | | |
|------------------------|----------------|-----|------|
| | 4.8 | 8.8 | 10.9 |
| Tightening torque (Nm) | | | |
| M6 | 5,5 | 10 | 15 |
| M8 | 13 | 25 | 35 |
| M10 | 25 | 50 | 75 |
| M12 | 45 | 85 | 130 |
| M16 | 115 | 215 | 315 |

5.3. Maintenance materials

When selecting lubricants, follow the lubricant manufacturer's recommendations.

Use a special electrical connector protection grease for electrical connectors to prevent corrosion and ensure good electrical conductivity.

Use a universal aerosol lubricant or silicone lubricant to lubricate joints.

Use a universal lithium complex grease to lubricate the inside of the coupling head.

5.4. Storage

Storing your trailer properly during extended periods of storage will help prevent damage, rust, and component problems.

Store the trailer indoors if possible.

Wash and dry the trailer.

Check the connectors and wiring for corrosion. Clean and grease the contacts if necessary.

Check the tire pressure and inflate according to the manufacturer's recommendations.

Move the trailer once a month to prevent the tires from deforming.

After storage, inspect all major components and make sure all moving parts are in good working order and properly lubricated.

6. TECHNICAL DATA

Basic technical data of a standard trailer

| DESCRIPTION | SIZE |
|--|--|
| Trade name | IB-1200 R1A |
| Length, mm (extension in / out) | 3070 / 3870 |
| Width, mm | 1320 |
| Height, mm (without crane / with crane) | 1190 / 1710 |
| Max load length, mm | 3500 |
| Gross weight, kg | 1500 |
| Load on hitch, kg | 100 |
| Load capacity, kg | 1320 |
| Tail weight, kg | 180 |
| Tires | 22x11.00-8 |
| Maximum speed, km/h | 40 |
| Electrical system | 12 V DC (7-PIN automotive trailer connector) |

7. WARRANTY CONDITIONS

Iron Baltic Ltd. (“the Manufacturer”) provides a limited warranty against defects in materials and workmanship for a period of 24 months from the original date of purchase by the first retail customer, in accordance with the Law of Obligations Act of the Republic of Estonia and applicable EU consumer protection laws.

More info about Warranty Conditions, Covered Components and Exclusions can be found on the website www.ironbaltic.com

8. ACCESSORIES

| | Standard equipment | Optional equipment |
|--------------------------------------|--------------------|--------------------|
| User manual | x | |
| Log bolster | x | |
| Additional pair of log bolsters | | x |
| Electric winch set | | x |
| Lifting grapple | | x |
| Accessory box with chainsaw holder | | x |
| Cargo box | | x |
| Cargo box extension panels (+300 mm) | | x |
| Cargo box PVC cover | | x |
| Flatbed | | x |
| Flatbed hatches (350 mm) | | x |
| Flatbed extension panels (+350 mm) | | x |
| Flatbed PVC cover | | x |
| Water tank mounting module | | x |
| Water tank 1000L (IBC container) | | x |
| Watering pipe | | x |
| 360° rotating D50 mm coupling | x | |
| Rear lights | x | |
| Crane | | x |

9. SPARE PARTS LIST

| Pos. | Description | Code | Amount |
|------|---|--------------|--------|
| 1 | Axle | 86.1001K | 1 |
| 2 | Frame tube VIN-code | 86.1103K | 1 |
| 3 | Front carrier | 86.1005K | 1 |
| 4 | Rear carrier | 86.1006K | 1 |
| 5 | Log bolster | 86.1010K | 4 |
| 6 | Drawbar with cables | 86.1014K | 1 |
| 7 | U-bolt 70x70 | 86.1015 | 4 |
| 8 | Tow coupling 1700 | 86.1050 | 1 |
| 9 | Reflector | 86.1101K | 2 |
| 10 | Rear light profile mounting bracket 1 | 86.6201 | 1 |
| 11 | Rear light profile mounting bracket 2 | 86.6202K | 1 |
| 12 | Rear light profile | 86.6205 | 1 |
| 13 | Distance washer 20-35-3 | 86.6206 | 1 |
| 14 | Rear light profile connection bracket 1 | 86.6207 | 2 |
| 15 | Distance bush | 05.5405 | 1 |
| 16 | Bolt fixing plate | 23.1005 | 2 |
| 17 | U-bolt 60x60 | 23.1006 | 2 |
| 18 | Swing arm | 23.1040 | 2 |
| 19 | Protective fence | 23.1080 | 1 |
| 20 | Rear light left FT-270 | OT.10.13.050 | 1 |
| 21 | Rear light right FT-270 | OT.10.13.040 | 1 |
| 22 | License plate base | OT.10.12.010 | 1 |
| 23 | Clamp LSF08 | OT.34.00.012 | 4 |
| 24 | Spring loaded pin 9,5x40x70mm | OT.10.11.012 | 2 |
| 25 | Pin with chain 1/2" x 3-1/2" | OT.53.01.010 | 2 |
| 26 | Support wheel bracket | OT.10.02.058 | 1 |
| 27 | Support wheel | OT.10.02.057 | 1 |
| 28 | Wheel 22x11x8 (E4-106R) (left) | OT.10.03.140 | 2 |
| 29 | Wheel 22x11x8 (E4-106R) (right) | OT.10.03.140 | 2 |
| 30 | Wheel bolt M12x1,5x25 | OT.02.09.010 | 16 |
| 31 | Pipe cap 48,3x2-3,6 | OT.25.00.100 | 4 |
| 32 | Grease nipple M6 | OT.17.00.005 | 2 |
| 33 | Bolt M6x16 DIN933 | OT.02.02.050 | 4 |
| 34 | Bolt M6x20 DIN933 | OT.02.02.060 | 6 |
| 35 | Bolt M8x20 DIN933 | OT.02.02.180 | 4 |
| 36 | Bolt M8x25 DIN933 | OT.02.02.190 | 1 |
| 37 | Bolt M12x30 DIN933 | OT.02.02.390 | 6 |
| 38 | Bolt M10x65 DIN931 | OT.02.01.045 | 2 |
| 39 | Bolt M10x85 DIN931 | OT.02.01.049 | 4 |
| 40 | Bolt M16x130 DIN931 | OT.02.01.160 | 2 |
| 41 | Washer Ø6/15 SFS3738 | OT.04.03.020 | 18 |
| 42 | Washer Ø8/20 SFS3738 | OT.04.03.030 | 8 |
| 43 | Washer M8 DIN9021 | OT.04.02.040 | 2 |
| 44 | Washer M10 DIN125 | OT.04.01.040 | 24 |
| 45 | Washer M16 DIN125 | OT.04.01.060 | 2 |
| 46 | Nut M12 DIN934 | OT.03.01.050 | 6 |
| 47 | Nyloc nut M6 DIN985 | OT.03.02.030 | 8 |
| 48 | Nyloc nut M8 DIN985 | OT.03.02.040 | 5 |
| 49 | Nyloc nut M10 DIN985 | OT.03.02.050 | 18 |
| 50 | Nyloc nut M16 DIN985 | OT.03.02.070 | 2 |

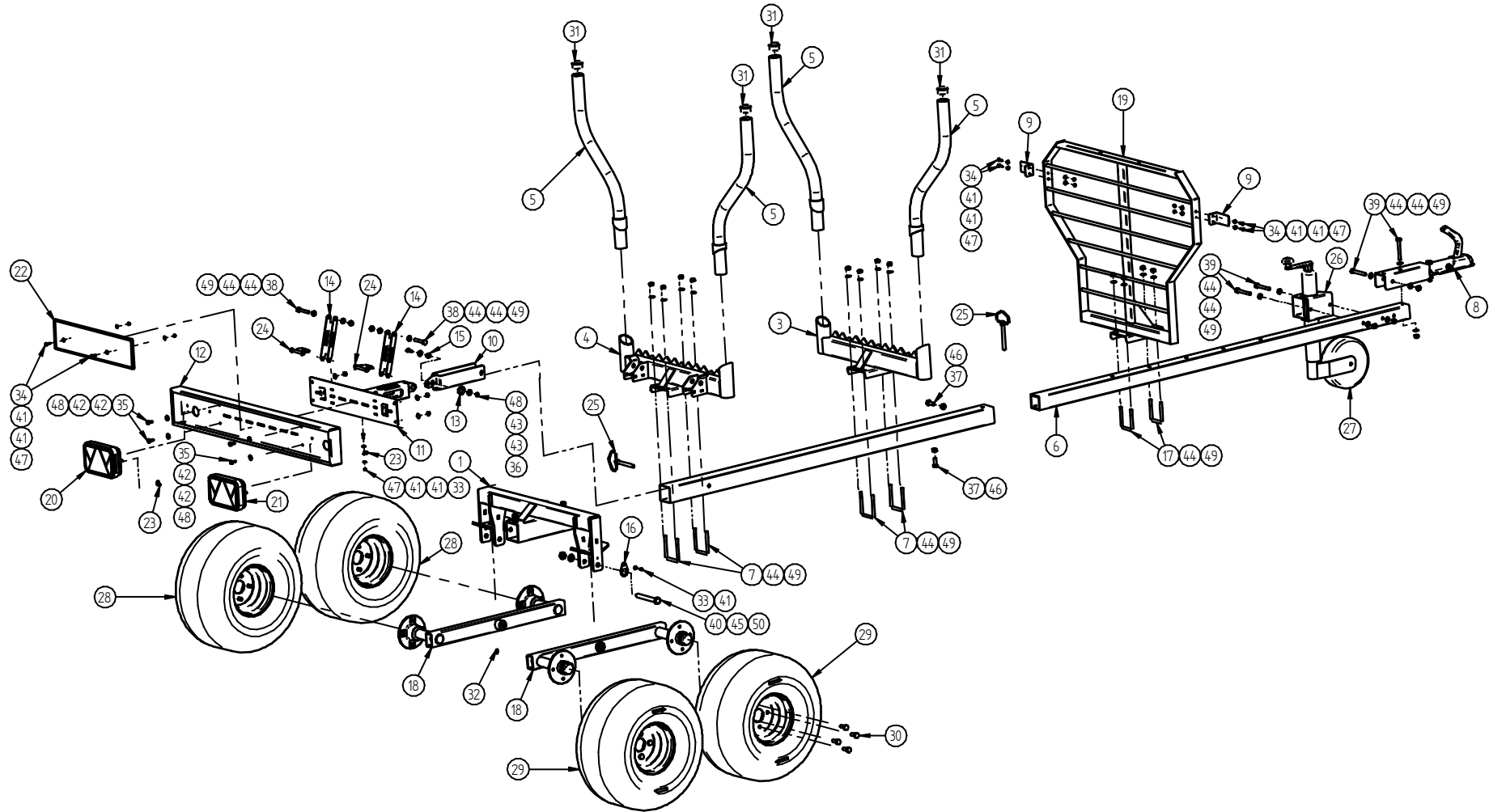

10. ASSEMBLY INSTRUCTIONS

1

Install swing arms (**18**) to axle beam (**1**). Make sure that the grease nipple (**32**) of the swing arm is facing downwards. For fastening use M16x130 bolt (**40**), Ø16 mm washer (**45**) and M16 nyloc nut (**50**). Before tightening the swing-arm mounting bolt, fix its position with bolt fixing plate (**16**) by attaching it to the axle with M6x16 bolt (**33**) and Ø6 mm washer (**41**).

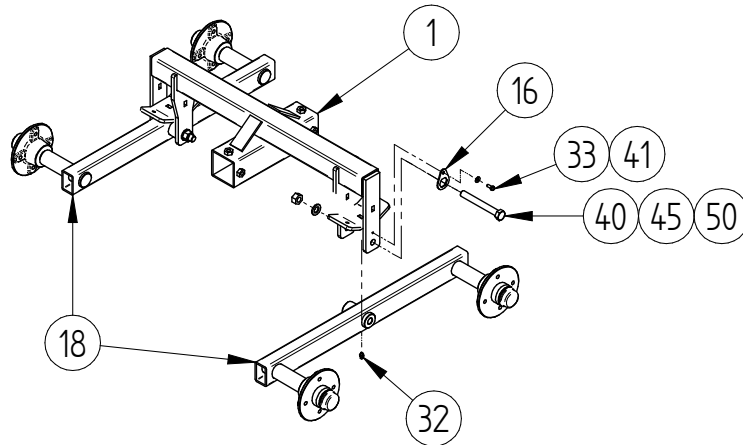

2

Install wheels (**28 and 29**). Watch tire direction and that the tire valve is facing outside.

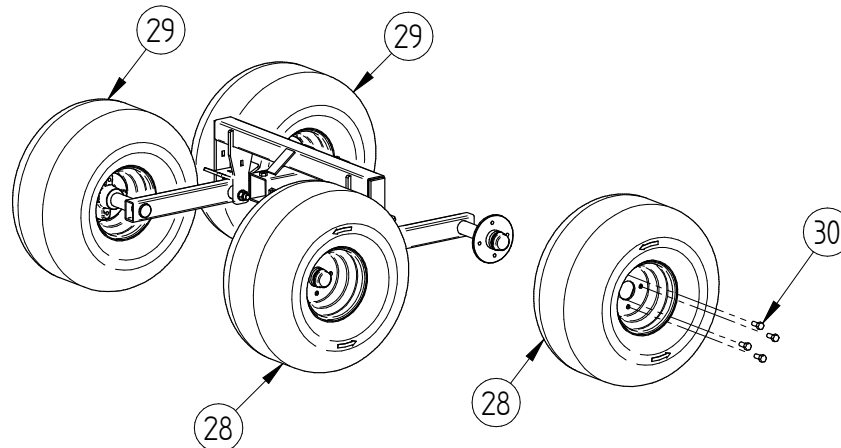

3

Install frame tube (2) to axle beam. Make sure that the pin hole (drawbar mounting hole) in the frame tube is vertical to ground and is on the front side of trailer! If you are using the trailer as timber trailer then place the axle beam in the middle of the expected load to be carried. If you use trailer with a cargo box, the position of the axle beam is 1085 mm from the front edge of the frame tube. If you use trailer with a flatbed box, the position of the axle is 1125 mm from the front edge of the frame tube. Secure frame tube position with M12x30 bolts (37) and lock the bolts with M12 nuts (46).

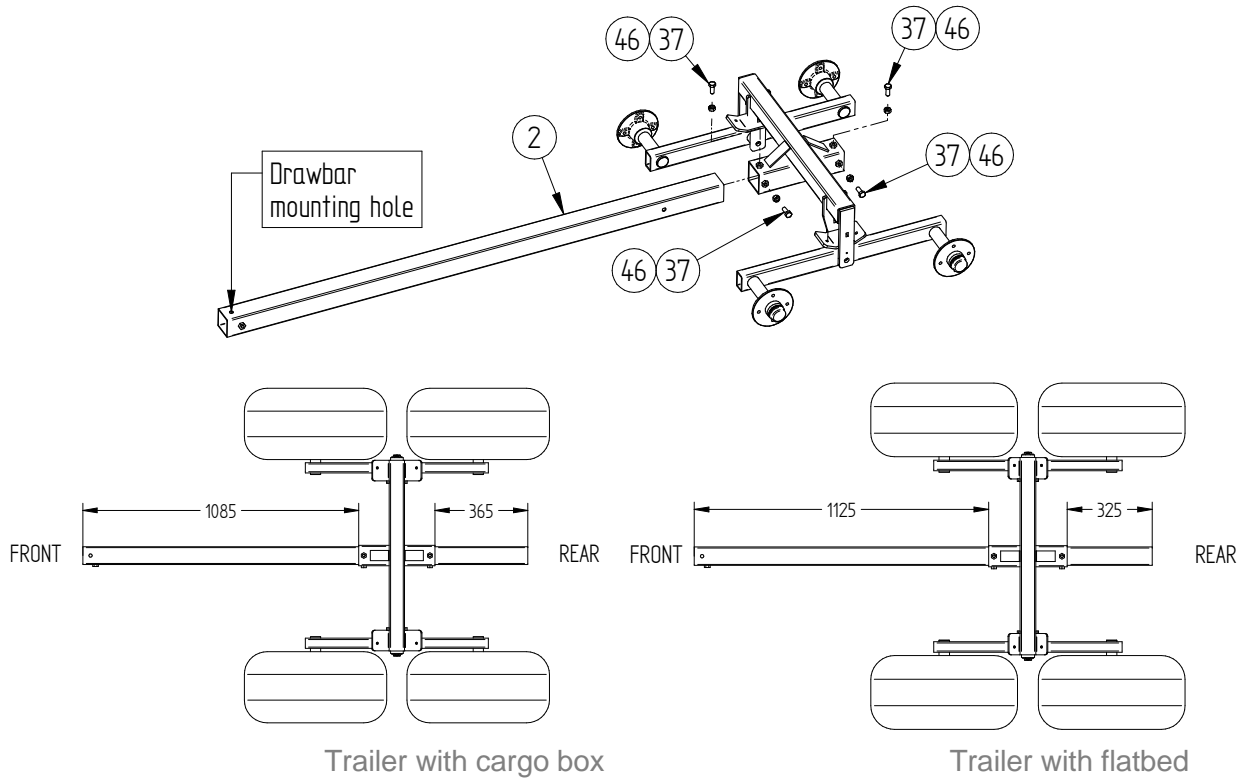

4

Install rear carrier (4) to frame tube so that the edge of the carrier is equal to edge of the frame tube. Make sure that cargo box mounting holes are on the rear side of the trailer. For fastening use 70x70 U-bolts (7), Ø10 mm washers (44) and M10 nyloc nuts (49).

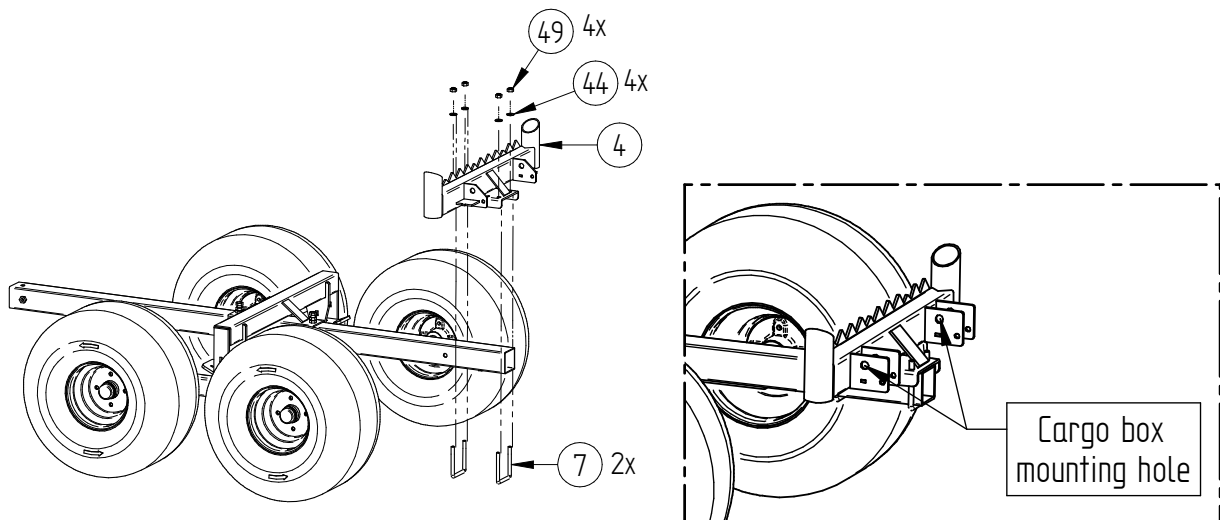

5

Install front carrier (3) to frame tube. For fastening use 70x70 U-bolts (7), Ø10 mm washers (44) and M10 nyloc nuts (49).

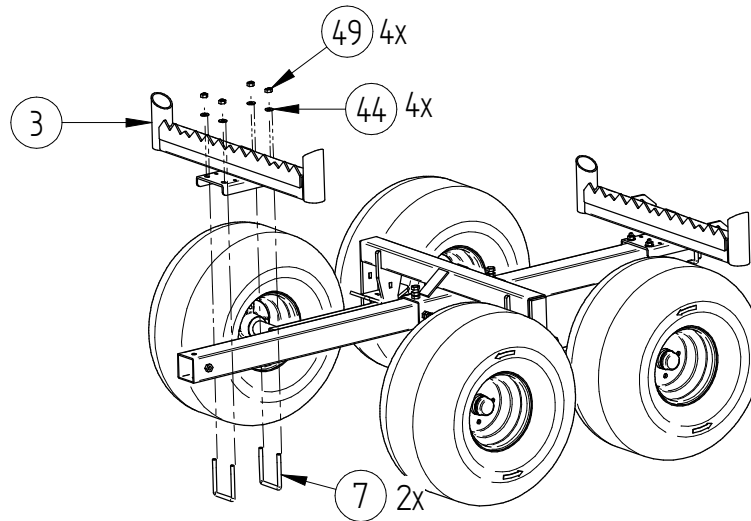

6

Install drawbar (6). Fix the length of the drawbar to the first (L1) position with the pin (25) (required for correct installation of the protective grille in step 9). Then tighten the M12x30 bolts (37) and lock the bolts with the M12 nuts (46).

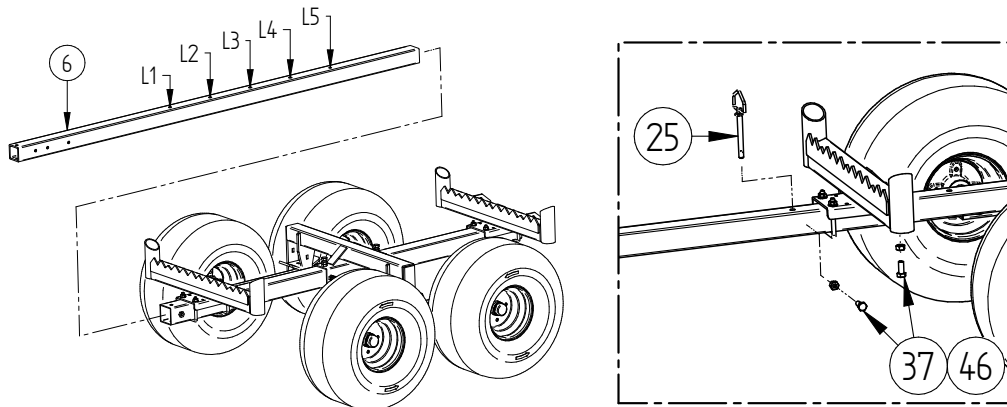

7

Install tow coupling (8) For fastening use M10x85 bolts (39), Ø10 mm washers (44) and M10 nyloc nuts (49).

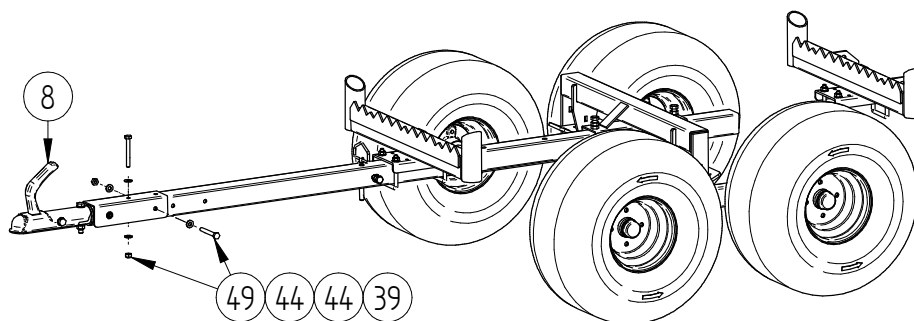

8

Install support wheel bracket (26) and support wheel (27). For fastening use M10x85 bolts (39), Ø10 mm washers (44) and M10 nyloc nuts (49).

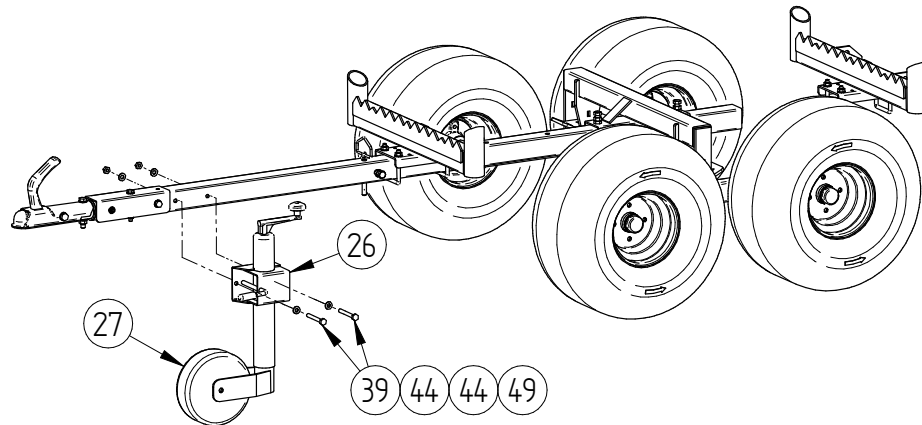

9

Install protective fence (19) to drawbar (6). Place protective fence so that rear edge is against the frame tube (2). NB! The drawbar tube must be locked in position L1 (see step 6). Use 60x60 U-bolts (17), Ø10 mm washers (44) and M10 nyloc nuts (49) to fasten the protective grille.

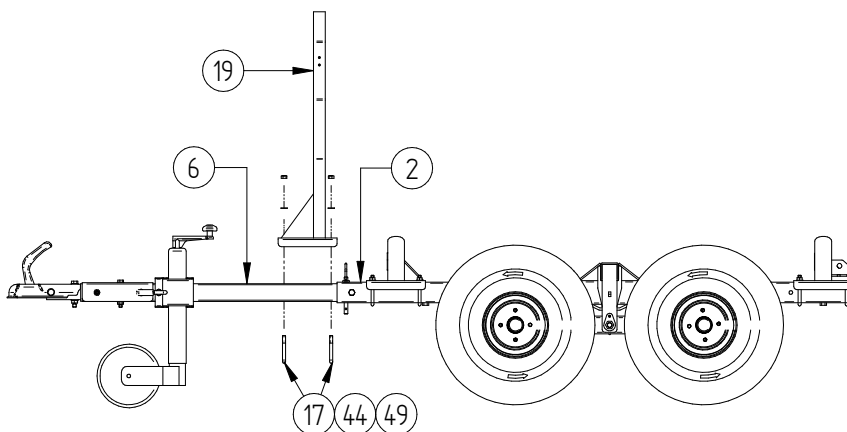

10

Install reflectors (9) to the protective fence. For fastening use M6x20 bolts (34), Ø6 mm washers (41) and M6 nyloc nuts (47).

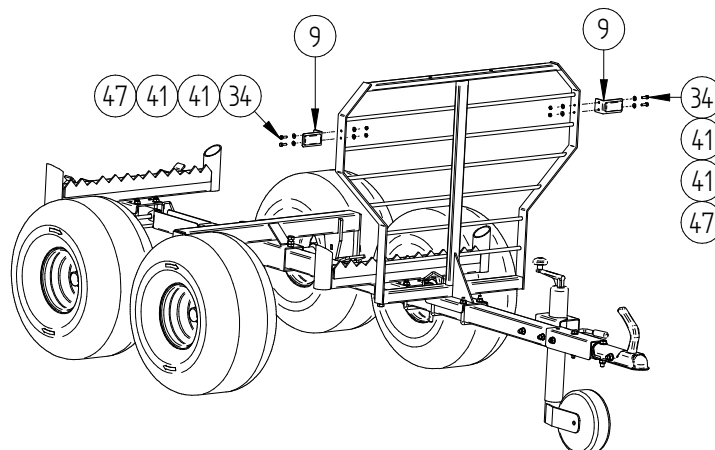

11

Install log bolsters (5) and pipe caps (31).

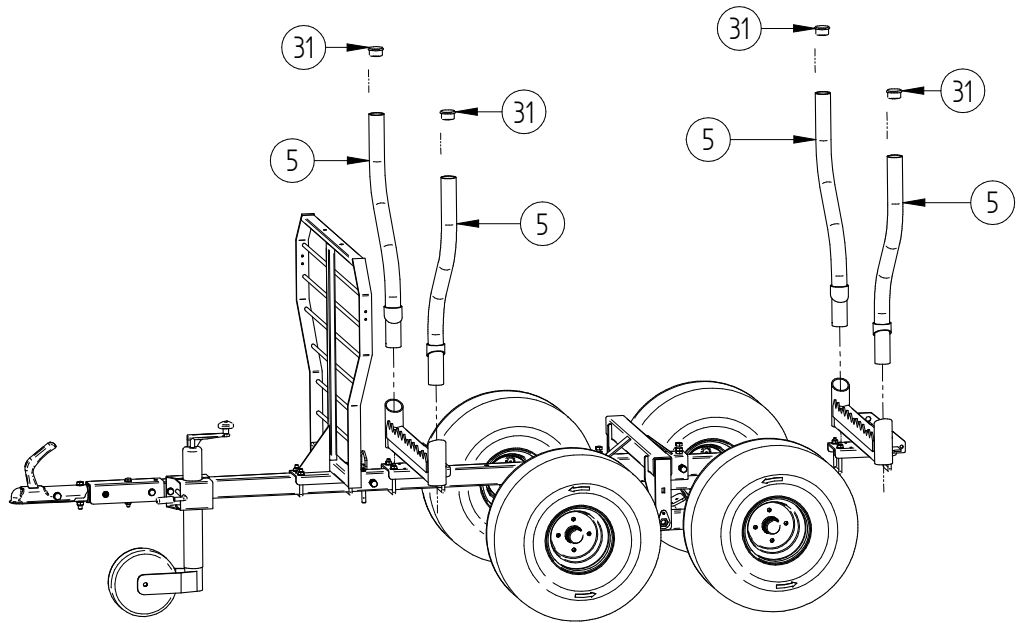

12

Assemble the rear light profile mounting brackets (10 and 11). For fastening use M8x25 bolt (36), Ø8 mm washer (43) and M8 nyloc nuts (48). Add a distance washer (13) and a bush (15) between the brackets (10 and 11). Make sure the opening for cable is facing down and that the brackets (10 and 11) are in line when viewed from above.

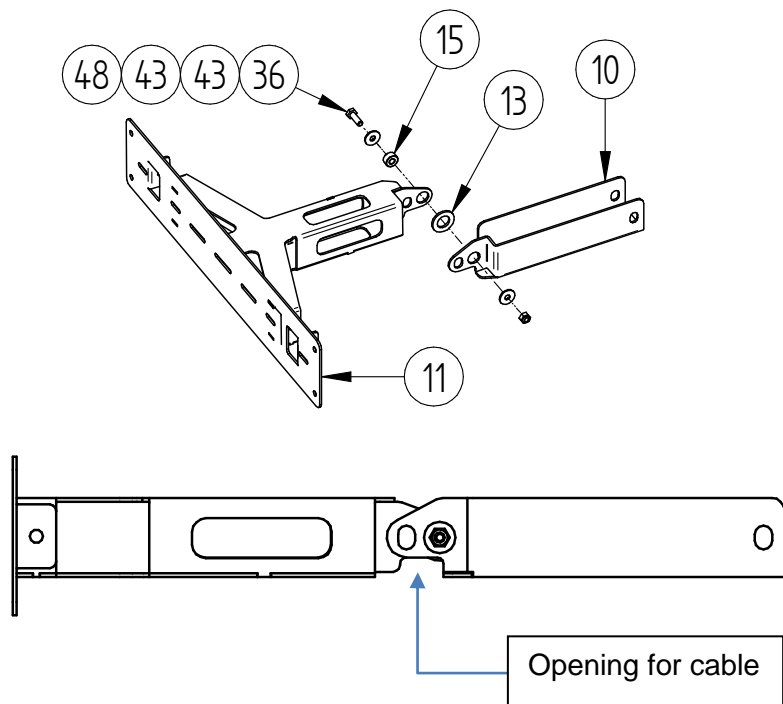

13

Install the complete rear light profile brackets to the trailer. If you use the trailer as a timber trailer, push the attachment as far into the frame as possible. If you are using a trailer with a cargo box or platform, leave the rear bracket (**11**) out of the frame tube. Fix the mounting with a pin (**25**).

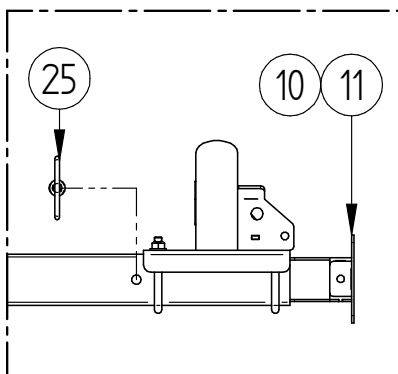
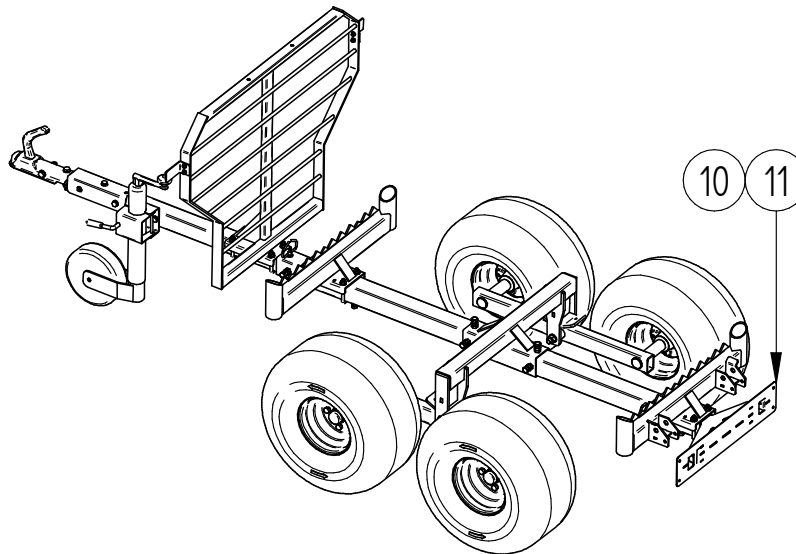

Timber trailer

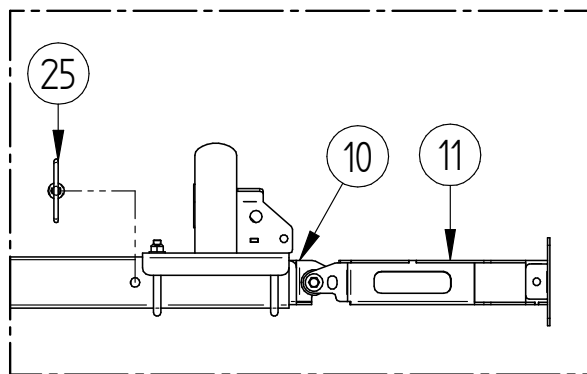

Trailer with cargo box / flatbed

14

Attach the taillight cables. For fastening use wire clips (**23**), M6x14 bolts (**33**), Ø6 mm washers (**41**) and M6 nuts (**47**).

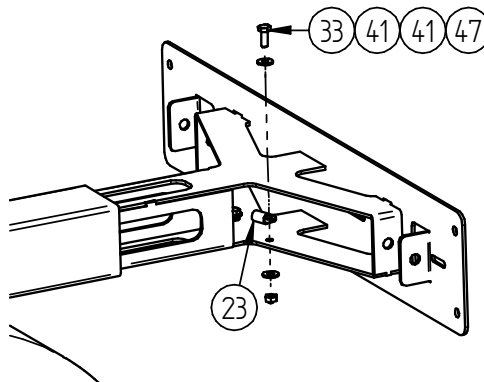

15

Install rear light profile (12). For fastening, use M8x20 (35), Ø8 mm washer (42) and M8 nyloc nuts (48).

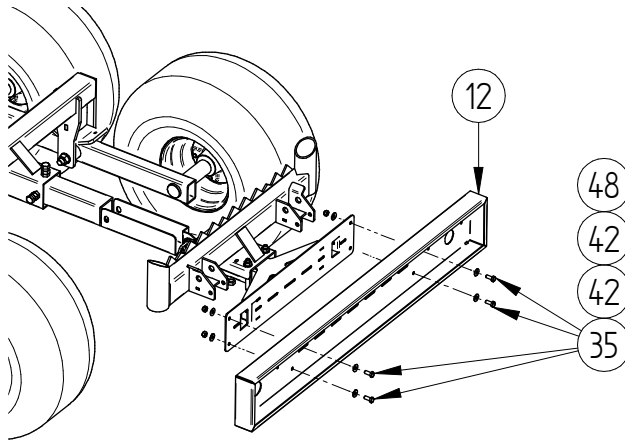

16

Install rear lights (20 and 21) and license plate base (22). For fastening the lights, use the nuts that come with the lights. For fastening the license plate base use M6x20 bolts (34), Ø6 mm washers (41) and M6 nyloc nuts (47). Attach the wire clamps (23) under the inner nuts of the taillight.

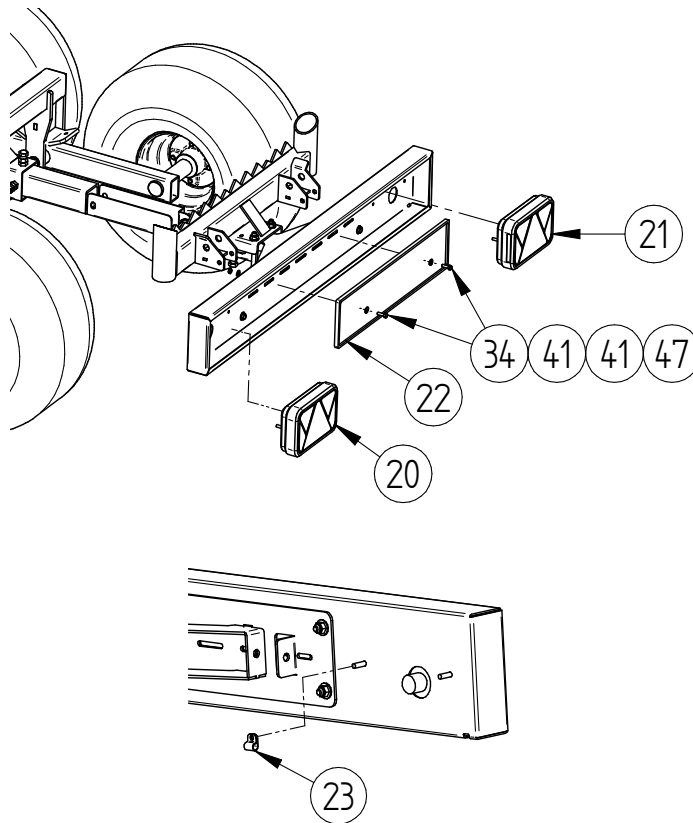

17

If you are using the trailer as a timber trailer, skip this step. If you use a trailer with a cargo box or platform, install the connection brackets (**14**) to the cargo box/platform. For fastening, use M10x65 (**38**), Ø10 mm washers (**44**) and M10 nyloc nuts (**49**). To connect to the trailer, use spring-loaded pins (**24**).

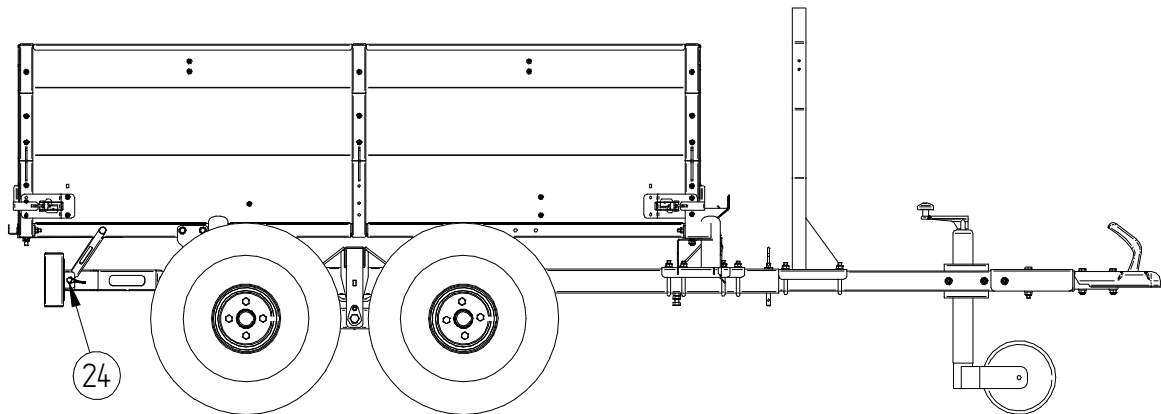
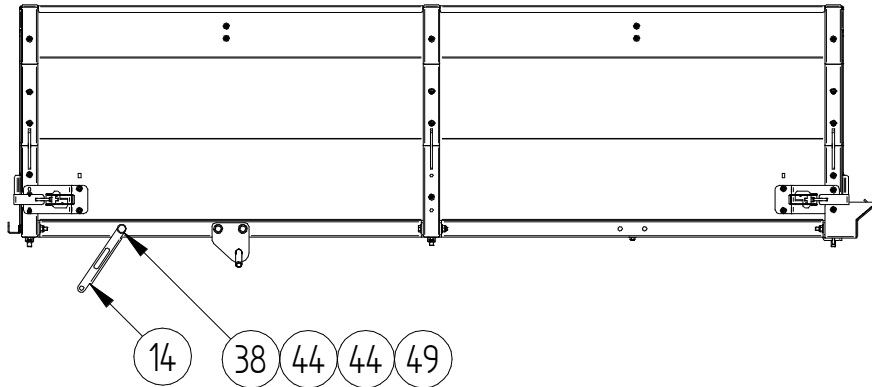

IRON BALTIC

IRON BALTIC OÜ
Joa tee 17, Vääna, Harku vald, 76903
Estonia, Europe

+372 6 533 711
sales@ironbaltic.com

www.ironbaltic.com
www.facebook.com/ironbaltic
www.youtube.com/user/ironbalticLtd

