

IRON BALTIC

DOWNLOAD MULTILINGUAL
USER MANUAL



code.ironbaltic.com/u/2u5UeqE8

USER MANUAL

Trailer

OFFROAD PRO 1200 R1A

Code 86.10100
Version 28112024



**This user manual should be considered as part of the machine.
Keep this manual for future reference!**

If you need any spare parts, please send this packaging data to your local dealer or to Iron Baltic
sales@ironbaltic.com

USER MANUAL CONTENTS

1. TRAILER IDENTIFICATION	4
2. INTRODUCTION	5
3. SAFETY INFORMATION	6
3.1. Danger symbol	6
3.2. Meaning of words	6
3.3. General safety rules.....	6
3.4. Safety notes	7
3.5. Safety labels.....	9
4. USER MANUAL	10
4.1. Technical description	10
4.2. Traffic	11
4.3. Before driving	11
4.4. Connecting the trailer.....	11
4.5. Disconnecting the trailer	12
4.6. Loading.....	13
4.7. Cleaning	13
5. MAINTENANCE	14
5.1. Maintenance intervals.....	14
5.2. Maintenance.....	14
5.2.1. Lifting points	14
5.2.2. Wheels and tires.....	15
5.2.3. Towing coupling.....	16
5.2.4. Electrical system.....	16
5.2.5. Lubrication.....	17
5.2.6. Tightening torques.....	17
5.3. Maintenance materials.....	17
5.4. Storage.....	18
6. TECHNICAL DATA	19
7. WARRANTY CONDITIONS.....	20
8. ACCESSORIES.....	21
9. SPARE PARTS LIST	22
9.1. Trailer	22
9.2. Cargo box.....	24
10. ASSEMBLY INSTRUCTIONS	26
10.1. Trailer.....	26
10.2. Cargo box	31

1. TRAILER IDENTIFICATION

This user manual is for Iron Baltic OFFROAD PRO 1200 R1A trailer models. The model can be identified by the identification number located on the vehicle:

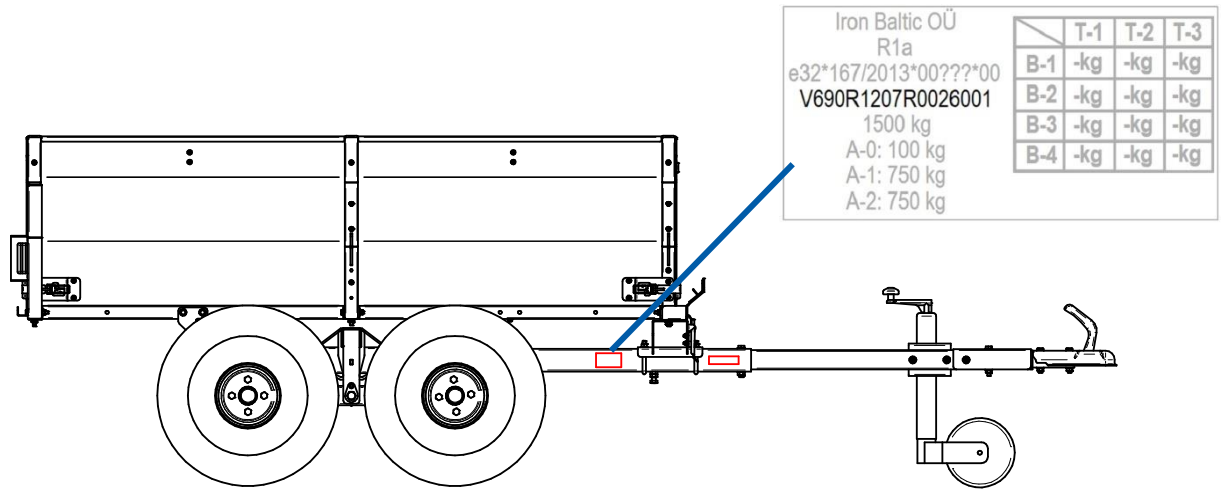

Note the 17-digit trailer identification number from the data plate for future reference and when ordering spare parts:

1	2	3	4	5	6	7	8	9	10	11	12	13	14	15	16	17
V	6	9	0	R	1	2	0			0	0	2	6			

Manufacturer details:

Iron Baltic OÜ
 Joa tee 17
 76903 Harku
 ESTONIA
 www.ironbaltic.com

Dealer details:

2. INTRODUCTION

Thank you for choosing Iron Baltic product. This manual contains specifications for the trailer OFFROAD PRO 1200 R1A and instructions for product assembly, safe operation and maintenance.

This manual covers all the equipment that is provided with the trailer and therefore you may find explanations that are not installed on your trailer.

Unnecessary use of the trailer can result economic damage and personal injury, so it is very important that the person who using the product read and use this manual in accordance with the requirements. Any misuse

of the product will release the manufacturer from liability for any damage or expense incurred.

NOTE: Photos and drawings in this manual may not necessarily depict the actual models of trailer or their accessories. They are merely given as a frame of reference and are based on the latest available information at the time of publication.

3. SAFETY INFORMATION

3.1. Danger symbol



This is a danger symbol. This symbol is used throughout this manual and on warning labels to highlight information about potential safety issues. When you see this symbol, be alert to the possibility of injury and carefully read the message following the symbol and inform other users.

3.2. Meaning of words



WARNING indicates a potentially hazardous situation which, if not avoided, could result in death or serious injury.



CAUTION indicates a potentially hazardous situation which, if not avoided, could result in injury.



IMPORTANT: Indicates instructions that, if not followed, could result in damage or destruction to the product or its surroundings.



NOTE: A useful note or tip for handling the product.

3.3. General safety rules



WARNING Before using the trailer, read the safety instructions carefully and make sure you understand them. Follow all instructions and require everyone who uses this equipment to follow them. Improper use can cause injury and damage to the machine.



WARNING If the trailer becomes damaged during use, work must be stopped immediately and the damage must be inspected. Damage (cracks in the structure or welded joints, deformed parts)

can endanger property and human health. Work must not be continued until the damage has been repaired.

Most accidents happen due to carelessness. Avoid accidents by following the instructions below.

The vehicle together with the trailer form a long machine that is difficult to manoeuvre, making it difficult to work in small and narrow areas.

TRAINING

- Read thoroughly the safety instructions and terms of use
- Never allow children to operate the vehicle or the trailer.
- Neither the vehicle nor the trailer can be used while drunk or under the influence of drugs that affect perception or reaction
- Do not allow bystanders, especially children or animals into the work zone.
- Remember that a trailer attached to the vehicle changes the vehicle's handling and manoeuvrability.
- Remember that there is a risk of overturning when driving on slopes.

PROHIBITED ACTIONS

- It is forbidden to use the trailer on steep slopes.
- It is forbidden to use the trailer if all fastening elements are not properly fastened.
- It is forbidden to use the trailer before you have carefully read the entire instruction manual.
- It is forbidden to drive over the 40 km/h or the speed recommended by the towing vehicle manufacturer (whichever is lower), when towing trailer
- It is forbidden to transport people on the trailer.
- It is forbidden to install additional equipment on the trailer that has not been approved by the manufacturer.

MANDATORY ACTIONS

⚠ WARNING Before starting work, check that the trailer is in good technical condition and that the coupling head is properly connected to the vehicle's towbar.

- Follow all the instructions of the towing vehicle manufacturer.
- Always use proper protective equipment (helmet, etc.) when working on the vehicle.
- Make sure that bystanders are moved to a safe distance when operating the trailer.

⚠ WARNING Stay away from the area between the vehicle and trailer.

- Clear the work area of any potential hazards.
- Ensure that all safety decals are in good condition – replace damaged decals with new ones if necessary.
- Always choose the right speed for the situation. Reduce speed when working on a hillside or uneven terrain.

- Be careful when braking and turning.
- Observe the permitted trailer loads.
- Always ensure safe roadholding of the vehicle and use appropriate accessories (chains, counterweights, etc.).
- Distribute the load to the trailer as evenly as possible (it is recommended to place heavy objects in the middle above the axle).
- Always ensure that all components are installed correctly
- Check the tightness of the bolts after the first hour of operation. Later, do this every ten hour of operation.
- When finishing work, stop the vehicle engine and activate the parking brake
- There must be no load in the box when uncoupling the trailer.

3.4. Safety notes

⚠ WARNING Before using the trailer, read the safety instructions carefully and make sure you understand them. Follow all instructions and require everyone who uses this equipment to follow them. Improper use can cause injury and damage to the machine.

⚠ WARNING If the trailer becomes damaged during use, work must be stopped immediately and the damage must be inspected. Damage (cracks in the structure or welded joints, deformed parts) can endanger property and human health. Work must not be continued until the damage has been repaired.

⚠ WARNING Before starting work, check that the trailer is in good technical condition and that the coupling head is properly connected to the vehicle's towbar.

⚠ WARNING Stay away from the area between the vehicle and trailer.

⚠ WARNING Risk of injury if the trailer becomes separated from the towing vehicle for any reason. Install the safety cable before each use.

⚠ WARNING If the hitch pointer is in the "⚠" zone (condition of the towbar is deteriorated) or "OPEN" zone (the hitch is not properly closed), the trailer must not be used. The coupling may come loose while driving.

⚠ WARNING Risk of accident due to unintended contact of the support wheel with the road if it is not fully raised and secured while driving. Before setting off, always make sure that the support wheel is not loose or secured against coming loose. To do this, fully raise the wheel and tighten the retaining clamp.

⚠ IMPORTANT: Do not load the trailer beyond the permitted weights. The maximum permissible gross trailer weight, the permissible towing weight and the permissible axle weights are shown on the data plate.

Iron Baltic OU			
R1a			
e32*167/2013*00??*00			
V691B1206R0026001			
1500 kg			
A-0: 100 kg			
A-1: 750 kg			
A-2: 750 kg			
	T-1	T-2	T-3
B-1	-kg	-kg	-kg
B-2	-kg	-kg	-kg
B-3	-kg	-kg	-kg
B-4	-kg	-kg	-kg

⚠ IMPORTANT: When cleaning the trailer, avoid using high-pressure washers with too high pressure as they can damage connections, electrical connectors or loose parts.

⚠ IMPORTANT: The following parts must not be directly sprayed with a pressure washer:

- all electrical parts and connections,
- nameplate and safety stickers,
- coupling device

⚠ WARNING Undetected cracks, sidewall damage or punctures can cause a tire to burst unexpectedly

⚠ WARNING Too high a pressure can cause the tire to burst unexpectedly or deform, which reduces tread grip and increases wear. Check the tire sidewall for the maximum allowable pressure values.

⚠ WARNING Driving with underinflated tires causes increased flexing of the tire sidewall, which generates excessive heat and can lead to a tire blowout.

⚠ WARNING Failure to comply with wheel tightening torques can cause serious hazards, such as the risk of the wheel coming loose while driving. Danger can be caused by overtightening, under tightening, or uneven tightening.

⚠ IMPORTANT: Moisture can cause rusting.

⚠ IMPORTANT: Only spare parts that meet the trailer manufacturer's specifications may be used for repairs and maintenance.





⚠ IMPORTANT: The tire manufacturer may specify a different tire pressure than the one listed in the table, depending on the characteristics of the specific tire. Always check the tire sidewall for the optimal pressure value and inflate the tire accordingly.





⚠ IMPORTANT: Electrical system repair work may be performed by qualified mechanics.

3.5. Safety labels

The safety labels shall be present on your trailer. If any of those labels is absent or gets damaged, contact your dealer in order to install new labels in place of the absent ones before operating the machine.

Meaning of safety labels:

	Maximum permitted speed 40 km / h!
	Maximum gross weight 1500 kg!
	Never carry any passenger on the trailer!
	It is forbidden to drive slopes over 15°!
	When lowering the box, ensure that the limbs do not fall between the box and the frame!

	Trace the surroundings when tilting the load and make sure it is safe!
	After tilting the load, there may be an obstacle between the cargo box and ground, which may cause cargo box spontaneous lowering.
	Uneven load distribution may cause the load to move. Make sure that limbs do not get stuck between load and trailer!
	Read the manual before use!

4. USER MANUAL

4.1. Technical description

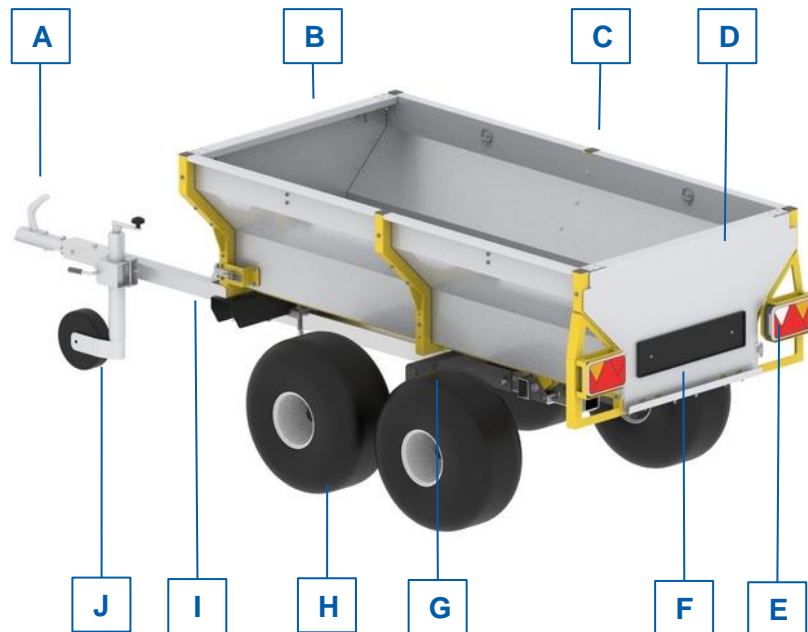

A – tow coupling
 B – cargo box front hatch
 C – cargo box
 D – cargo box rear hatch
 E – rear light

F – license plate
 G – axle
 H – wheel
 I – frame tube
 J – support wheel

The Iron Baltic OFFROAD PRO 1200 R1A is a durable trailer that can be attached to the ATV or UTV and carry up to 1200 kg load.

Trailer electrical connection uses 7-PIN automotive trailer connector.

The trailer is designed for ATVs and UTVs to be used but can be towed with any other vehicle equipped with a 50 mm hitch ball. Trailer does not cause notable damage to the terrain and can be easily manoeuvre between trees, allowing access to places where large tractors are not accessible. The four-wheeled tandem axle, combined with wide tires, gives the trailer excellent off-road capabilities, allowing you to easily move over stumps and ditches.

Cargo box is designed for transporting various goods and materials. The front and rear panels of the box are removable and in addition, it is possible to add side extensions to the cargo box which allows to transport oversized loads. Cargo box tilting is possible by assembling the trailer with the box tilting mechanism.

In addition to the box side extensions, there is also PVC cover and a box tilting mechanism, which allows the box to be tilted manually or using an electric winch.

4.2. Traffic

- When driving on public roads, follow the applicable traffic regulations.
- When driving with a trailer, take into account weather conditions, road surface and driver experience.
- The maximum permitted speed when towing a trailer is 40 km/h, or the maximum speed permitted by the manufacturer of the towing vehicle (whichever is lower).

4.3. Before driving

- Before driving, check the attachment of the towbar to the drawbar.
- Before driving, make sure that the support wheel is raised and securely attached.
- Before driving, make sure that all moving parts (load posts, drawbar tube, towbar, box doors) are properly attached and/or locked.
- Before driving, check that the tow ball is securely in the grip of the towbar (the locking status is visible on the towbar indicator).
- Before driving, check the condition of the tires and the tire pressure (recommended pressure is 1.5 bar).
- Before driving, check the tightness of the wheel bolts.

4.4. Connecting the trailer

1. Turn the coupling head to the appropriate height using the support wheel. Place the coupling head over the towing ball of the vehicle.
2. Hang the safety cable on the eye provided on the coupling head or directly on the coupling head carrier (not permitted in some countries) or on the vehicle frame. Make sure that the safety cable is long enough to pass through bends.

⚠ WARNING Risk of injury if the trailer becomes separated from the towing vehicle for any reason. Install the safety cable before each use.

3. Lower the support wheel until the ball joint audibly clicks into place. Check the position of the safety indicator: The pointer must be in the zone marked "OK" or "◀".



⚠ WARNING If the hitch pointer is in the "⚠" zone (condition of the towbar is deteriorated) or "OPEN" zone (the hitch is not properly closed), the trailer must not be used. The coupling may come loose while driving.

4. Check the correctness of the coupling by lifting the drawbar.
5. Connect the electrical plug to the socket of the vehicle.
6. Screw the support wheel completely up. Make sure that the fork of the support wheel fits into the notches in the housing and tighten. Raise the support wheel as high as possible. The wheel must always be placed parallel to the direction of travel.

⚠ WARNING Risk of accident due to unintended contact of the support wheel with the road if it is not fully raised and secured while driving. Before setting off, always make sure that the support wheel is not loose or secured against coming loose. To do this, fully raise the wheel and tighten the retaining clamp.

4.5. Disconnecting the trailer

1. Park the trailer on a flat and stable surface.
2. Disconnect the electrical plug from the towing vehicle's socket.
3. Adjust the support leg to the appropriate height from the clamp and then turning the support wheel handle to move it downwards.
4. Release the coupling head handle lock "R" and pull it up "D" while turning the support leg downwards by turning the crank until the tow ball is fully visible.
5. Release the safety cable from the towing vehicle.

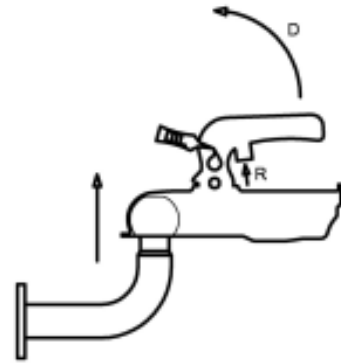

4.6. Loading

The placement of the load on the trailer affects the handling of the trailer and the vehicle. Proper load placement improves safety, handling and reduces wear on both the towing vehicle and the trailer.

! IMPORTANT: Do not load the trailer beyond the permitted weights. The maximum permissible gross trailer weight, the permissible towing weight and the permissible axle weights are shown on the data plate.

Iron Baltic OU R1a e32*167/2013*00??*00 V691B1206R0026001 1500 kg A-0: 100 kg A-1: 750 kg A-2: 750 kg			
	T-1	T-2	T-3
B-1	-kg	-kg	-kg
B-2	-kg	-kg	-kg
B-3	-kg	-kg	-kg
B-4	-kg	-kg	-kg

- When loading take into account that the load to the hitch ball should not exceed 100 kg, or the weight specified by the manufacturer of the vehicle (lower weight

must be observed).

- Make sure that the load does not extend over the edges.
- If load extends more than one meter beyond the rear of the trailer, a red and white striped overhanging load sign and a red light must be attached to it. If the load obscures the vehicle's lights and/or registration plate, additional rear lights and/or a duplicate sign must be used.

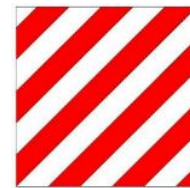

4.7. Cleaning

Cleaning the trailer after use is important to ensure its long service life, appearance and technical condition. The trailer should be cleaned as needed and before longer breaks in use.

- Remove any load residue.
- Use running water to remove heavy dirt. Car shampoo is very suitable for washing the trailer.
- Pressure washer can be used to clean the trailer. Before using a pressure washer, familiarize yourself with the safe operation of this device.

! IMPORTANT: Avoid using pressure washers with too high a pressure, as they can damage connections, electrical connectors or loose parts.

! IMPORTANT: Do not spray the following parts directly with a pressure washer:

- all electrical parts and connections,
- data label and safety labels
- tow coupling

- Clean the wheels and chassis, as they often accumulate mud, road dust and salt. This is especially important after winter use or if the trailer has been on salted roads.
- Clean the coupling from dirt and lubricate it with a special lubricant to prevent corrosion.
- Clean the connectors. Dry thoroughly and lubricate the contacts with electrical contact grease if necessary.
- After washing, dry the trailer carefully, especially if it will be stored for a long time.

! IMPORTANT: Moisture can cause rusting.

5. MAINTENANCE

⚠ WARNING During any maintenance or repair work there must not be load in trailer.

⚠ IMPORTANT: Only parts that meet the trailer manufacturer’s specifications may be used for repairs and maintenance.

5.1. Maintenance intervals

To keep your trailer in good condition, it must be maintained regularly. Regular and correctly performed maintenance is a prerequisite for the validity of the warranty.

Maintenance activity:	Interval			
	Before and after work	Weekly	Monthly	Seasonally
Wheels				
Check tire pressure	x	x	x	x
Check tire tread wear		x	x	x
Check tires for damage		x	x	x
Check wheel nuts for correct tightening torque			x	x
Wheel bearing play and freedom of movement				x
Lubrication of wheel swing arm			x	x
Body				
Check lights	x	x	x	x
Check condition of all connecting parts		x	x	x
Check bolted connections				x
Electrical system				x
Check safety stickers		x	x	x
Tow coupling				
Check hitch mounting bolts		x	x	x
Lubrication of tow coupling			x	x
Lubrication of rotating tow coupling				x

5.2. Maintenance

5.2.1. Lifting points

When lifting the trailer to change a wheel and/or perform other maintenance, connect the trailer to the vehicle and block the wheels with suitable chocks. Place the jack under the axle beam.

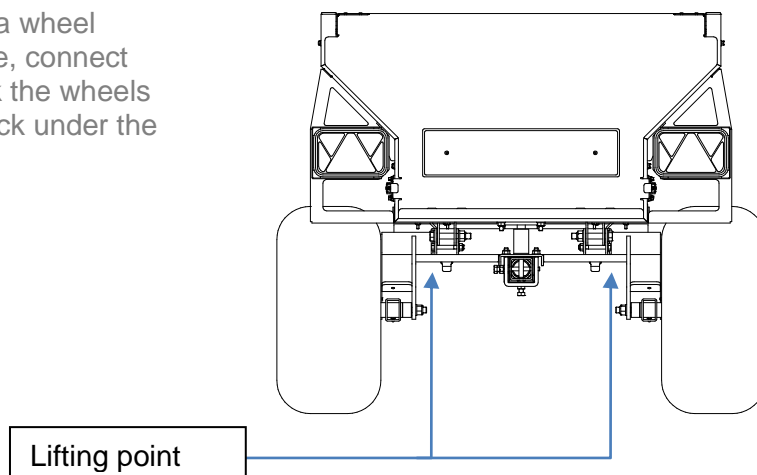

5. MAINTENANCE

5.2.2. Wheels and tires

Regularly checking the condition of your tires is critical for safety and driving comfort.

Check the tires for even wear. Uneven wear indicates incorrect tire pressure or problems with the axles.

Visually inspect for damage such as cracks, splits, sidewall damage, foreign objects or other damage.

Changing a wheel

Only change a trailer wheel on level, hard ground by placing a jack under the end of the vertical tube of the axle frame

Tire pressures

Check tire pressure regularly and especially after each tire change. Check tire pressure with cold tires.

Only use rims and tires of the correct size. The load and speed ratings of the tires used on the trailer must meet the following minimum values:

Tire size	Load rating	Speed rating (40 km/h)	Nominal pressure (bar)
22x11.00-8	74	A8	1,5

IMPORTANT: The tire manufacturer may specify tire pressures that differ from the table above, depending on the characteristics and use of the tire. Always check the tire manufacturer's specified pressure value and inflate the tire accordingly.

WARNING Unnoticed cracks, sidewall damage or penetrating damage can cause the tire to burst unexpectedly.

Repair only suitable damage (e.g. small punctures in the center of the tread); sidewall damage should not be repaired.

Check the tread depth according to the requirements of the country of use.

WARNING Too high a pressure can cause the tire to burst unexpectedly or change the tire's shape, which reduces tread grip and increases wear. Check the tire sidewall for the maximum permissible pressure values.

WARNING Driving with underinflated tires causes increased flexing of the tire sidewall, which generates excessive heat and can lead to a tire blowout.

Tightening torques

⚠ WARNING Failure to observe the wheel tightening torques can cause serious danger, for example, the risk of the wheel coming loose while driving. Danger can be caused by overtightening, under tightening, or uneven tightening.

Tightening torque of the wheel bolts must be checked after removing and reinstalling the wheels, then after the first 50 km and subsequently according to the maintenance schedule. The contact surfaces of the wheels

5.2.3. Towing coupling

Proper maintenance ensures easy use and proper functioning of the towing coupling.

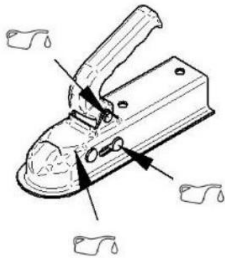

According to the maintenance interval and if the towing coupling is difficult to operate, all joints must be cleaned and lubricated at the indicated points (see diagram).

5.2.4. Electrical system

⚠ IMPORTANT: Repairs or modifications to the electrical system may only be carried out by qualified mechanics.

- Check that the trailer is disconnected from the towing vehicle's electrical system (remove the plug).
- Check the wiring for cracks or mechanical damage.
- Check that the wiring is securely fastened and does not come into contact with sharp edges or moving parts.
- Check the connections (terminals, sockets)
 - make sure they are securely fastened,

and hubs must be clean to secure the wheels:

Tighten the wheel bolts with a torque wrench to the specified tightening torque:

Wheel bolt	Torque
M12 x 1.5 x 25	80 – 90 Nm

If the trailer has been used with loose wheel bolts, the bolts and the rim mounting holes must be checked for damage. If damaged, the bolts or rim must be replaced.

Clean the surface before lubrication. Remove dirt, old grease and corrosion so that the new grease layer can work effectively. Do not overlubricate, as excess grease can collect dirt and reduce the efficiency of the components.

If the towing device indicator shows ("⚠"), first check the wear of the coupling ball (minimum \varnothing 49 mm). If the ball has not worn beyond the permissible limit, the coupling ball is worn and must be replaced.

⚠ WARNING If the pointer is in the „⚠“, zone, the trailer must not be used. The coupling may come loose while driving.

undamaged and free of corrosion. If necessary, use contact cleaner and a soft brush to remove dirt and corrosion. If necessary, lubricate the connector contacts with special contact grease to prevent moisture damage.

- Functional test of the lamps:
 - Connect the trailer to the vehicle and switch on the lights (tail lights, direction indicators, brake lights, position lights). Check that all lights are working.
 - The trailer is equipped with LED rear lights. If any function of the lamp is not working, the entire lamp must be replaced.

5.2.5. Lubrication

According to the maintenance interval, all moving parts must be lubricated at the indicated points (see diagram)

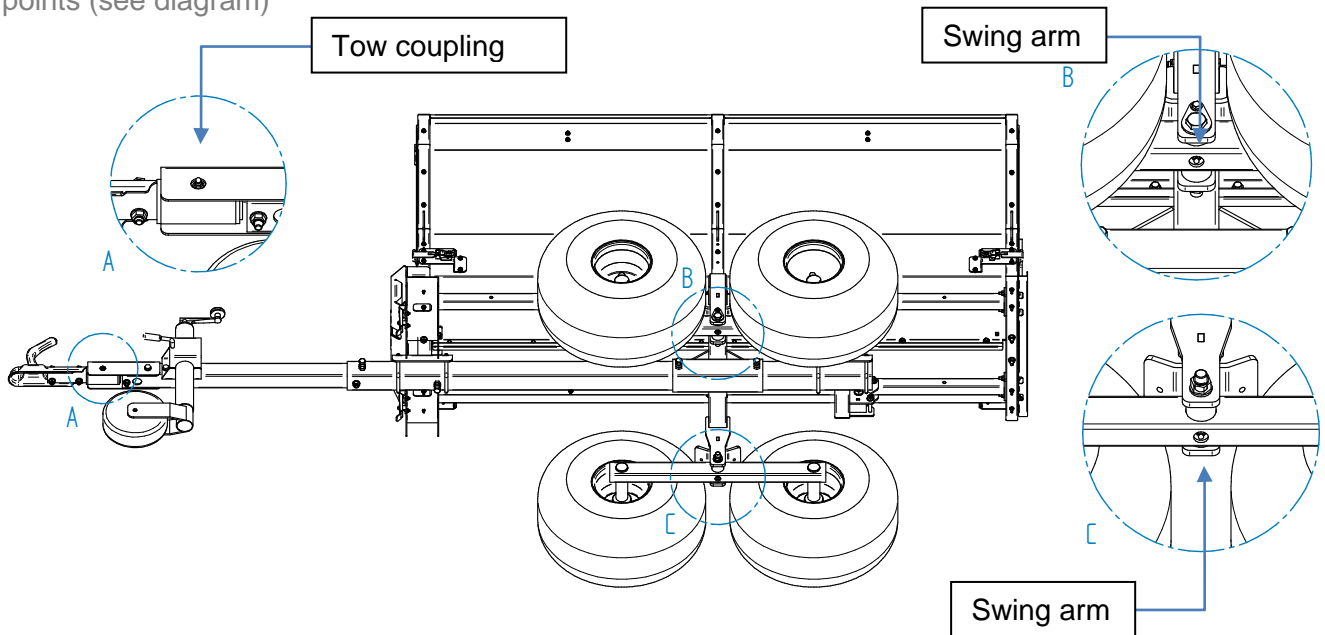

5. MAINTENANCE

5.2.6. Tightening torques

Tightening torque for bolts:

Thread size	Strength class		
	4.8	8.8	10.9
Tightening torque (Nm)			
M6	5,5	10	15
M8	13	25	35
M10	25	50	75
M12	45	85	130
M16	115	215	315

5.3. Maintenance materials

When selecting lubricants, follow the lubricant manufacturer's recommendations.

Use a special electrical connector protection grease for electrical connectors to prevent corrosion and ensure good electrical conductivity.

Use a universal aerosol lubricant or silicone

lubricant to lubricate joints.

Use a universal lithium complex grease to lubricate the inside of the coupling head.

5.4. Storage

Storing your trailer properly during extended periods of storage will help prevent damage, rust, and component problems.

Store the trailer indoors if possible.

Wash and dry the trailer.

Check the connectors and wiring for corrosion.
Clean and grease the contacts if necessary.

Check the tire pressure and inflate according to the manufacturer's recommendations.

Move the trailer once a month to prevent the tires from deforming.

After storage, inspect all major components and make sure all moving parts are in good working order and properly lubricated.

6. TECHNICAL DATA

Basic technical data of a standard trailer

DESCRIPTION	SIZE
Trade name	OFFROAD PRO 1200 R1A
Length, mm	3420
Width, mm	1320
Height, mm (without extensions / with extensions)	1080 / 1380
Max load length, mm	2000
Gross weight, kg	1500
Load on hitch, kg	100
Load capacity, kg	1260
Tail weight, kg	240
Tires	22x11.00-8
Maximum speed, km/h	40
Electrical system	12 V DC (7-PIN automotive trailer connector)

7. WARRANTY CONDITIONS

Iron Baltic Ltd. (“the Manufacturer”) provides a limited warranty against defects in materials and workmanship for a period of 24 months from the original date of purchase by the first retail customer, in accordance with the Law of Obligations Act of the Republic of Estonia and applicable EU consumer protection laws.

More info about Warranty Conditions, Covered Components and Exclusions can be found on the website www.ironbaltic.com

8. ACCESSORIES

	Standard equipment	Optional equipment
User manual	x	
Cargo box	x	
Cargo box extension panels (+300 mm)		x
Cargo box PVC cover		x
360° rotating D50 mm coupling	x	
Rear lights	x	
Box tilting mechanism with hand winch		x
Box tilting mechanism with hand winch		x

9. SPARE PARTS LIST

9.1. Trailer

Pos.	Description	Code	Amount
1	Drawbar with cables	86.10011K	1
2	Rear carrier	86.10002K	1
3	Frame tube with VIN-code	86.10105K	1
4	Cargo box with rear lights	86.10150	1
5	Axle	86.1001K	1
6	U-bolt 70x70	86.1015	4
7	Tow coupling 1700 kg	86.1050	1
8	Front carrier	86.2015K	1
9	Bolt fixing plate	23.1005	2
10	Swing arm	23.1040	2
11	Clamp	23.2070	2
12	Wheel 22X11-8 (E4-106R) (left)	OT.10.03.140	2
13	Wheel 22X11-8 (E4-106R) (right)	OT.10.03.140	2
14	Wheel bolt M12x1,5x25	OT.02.09.010	16
15	Support wheel bracket	OT.10.02.058	1
16	Support wheel	OT.10.02.057	1
17	Tube cap 70x50	OT.10.07.075	2
18	Grease nipple M6	OT.17.00.005	2
19	Bolt M6x16 DIN7991	OT.02.04.020	4
20	Bolt M6x16 DIN933	OT.02.02.050	2
21	Bolt M12x30 DIN933	OT.02.02.390	6
22	Bolt M10x80 DIN931	OT.02.01.048	2
23	Bolt M10x85 DIN931	OT.02.01.049	4
24	Bolt M12x90 DIN931	OT.02.01.120	1
25	Bolt M16x100 DIN931	OT.02.01.150	2
26	Bolt M16x130 DIN931	OT.02.01.160	2
27	Washer Ø6/15 SFS3738	OT.04.03.020	6
28	Washer Ø 10 DIN125	OT.04.01.040	20
29	Washer Ø 12 DIN125	OT.04.01.050	2
30	Washer Ø 16 DIN125	OT.04.01.060	6
31	Nut M12 DIN934	OT.03.01.050	6
32	Nyloc nut M6 DIN985	OT.03.02.030	4
33	Nyloc nut M10 DIN985	OT.03.02.050	14
34	Nyloc nut M12 DIN985	OT.03.02.060	1
35	Nyloc nut M16 DIN985	OT.03.02.070	4

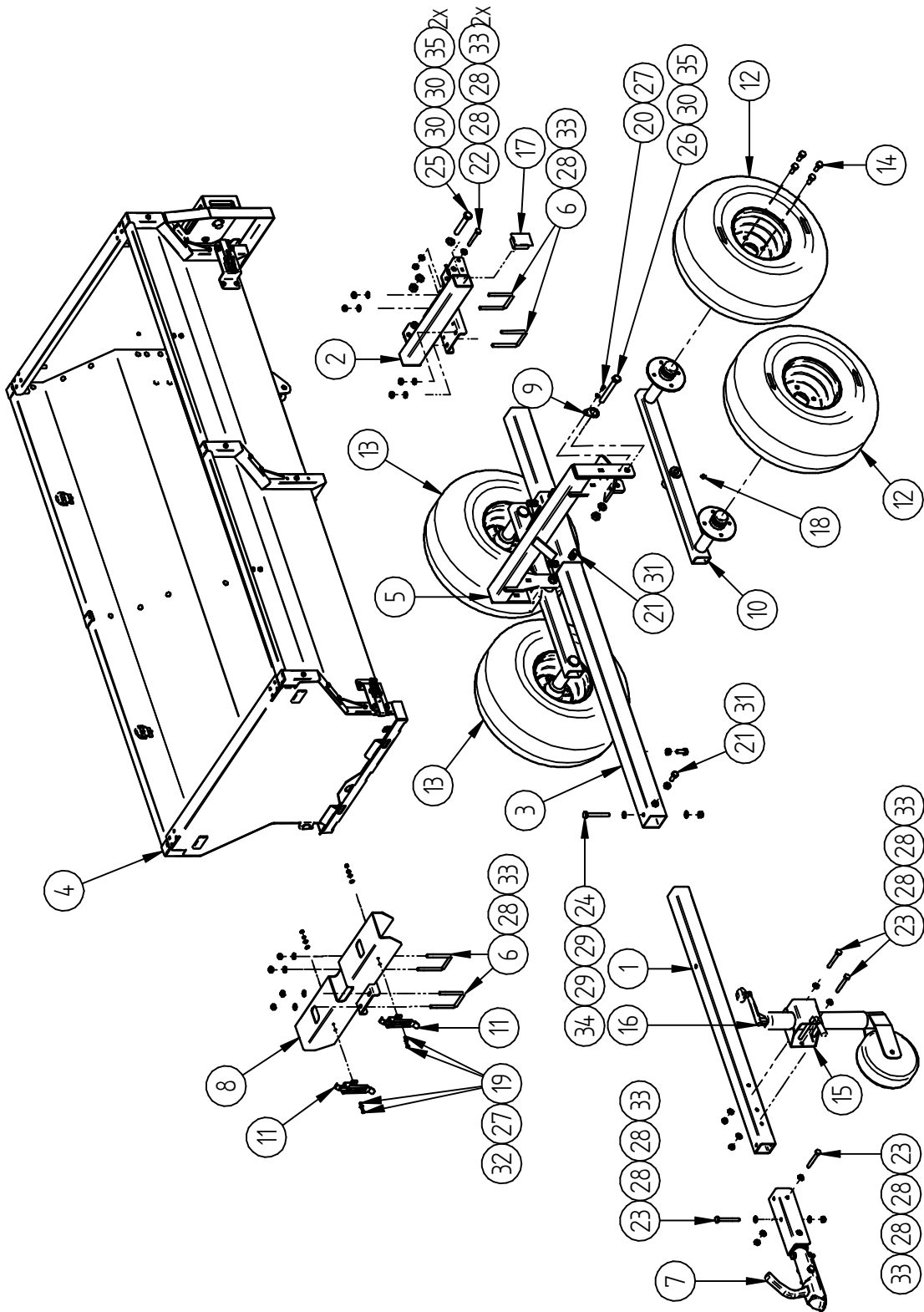

9.2. Cargo box

Pos.	Description	Code	Amount
1	Rear hatch	86.2021K	2
2	Front hatch	86.2021S	1
3	Side panel	86.2022	2
4	Frame	86.2023K	3
5	Lifting adapter	86.2025K	1
6	Bottom frame tube	86.2008K	4
7	Tilting plate	86.2010	4
8	Hatch lock	86.2011K	4
9	Lifting point bracket	86.2027	1
10	Light carrier right	86.6001	1
11	Light carrier left	86.6002	1
12	Light cover	86.6003	2
13	Bushing 8/20-10	05.7102	2
14	Rear light left FT-270	OT.10.13.040	1
15	Rear light right FT-270	OT.10.13.050	1
16	License plate base	OT.10.12.010	1
17	Cable clamp LSFG14	OT.05.02.014	2
18	Cable clamp LSFG08	OT.34.00.012	2
19	Lifting point 3/8	OT.56.00.010	1
20	Lashing ring Ø7 mm	OT.56.00.020	4
21	Tube cap 15x15	OT.10.07.003	2
22	Tube cap 40x40	OT.10.07.010	6
23	Bolt M5x16 ISO7380	OT.02.03.003	2
24	Bolt M6x14 DIN933	OT.02.02.040	14
25	Bolt M6x30 DIN933	OT.02.02.080	2
26	Bolt M8x65 DIN933	OT.02.02.255	12
27	Bolt M10x70 DIN933	OT.02.02.350	4
28	Carriage bolt M6x16 DIN603	OT.02.05.010	8
29	Carriage bolt M6x50 DIN603	OT.02.05.030	26
30	Carriage bolt M6x60 DIN603	OT.02.05.028	20
31	Carriage bolt M10x25 DIN603	OT.02.05.105	2
32	Carriage bolt M10x65 DIN603	OT.02.05.125	6
33	Washer Ø 5 DIN125	OT.04.01.010	2
34	Washer Ø6/15 SFS3738	OT.04.03.020	78
35	Washer Ø8/20 SFS3738	OT.04.03.030	24
36	Washer M10 DIN125	OT.04.01.040	16
37	Nyloc nut M5 DIN985	OT.03.02.020	2
38	Nyloc nut M6 DIN985	OT.03.02.030	70
39	Nyloc nut M8 DIN985	OT.03.02.040	12
40	Nyloc nut M10 DIN985	OT.03.02.050	12

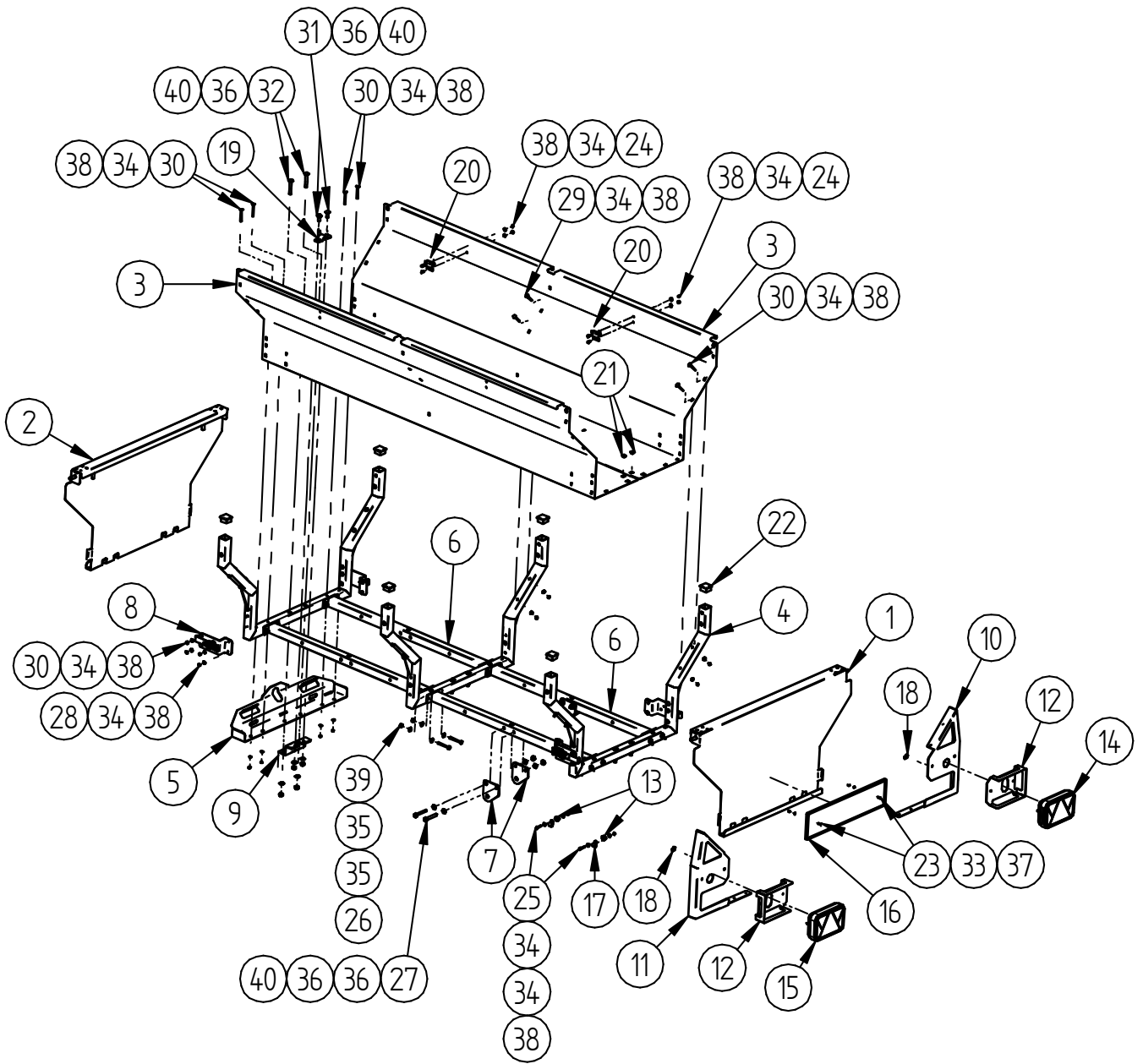

10. ASSEMBLY INSTRUCTIONS

10.1. Trailer

NB! The item numbers of the details correspond to the parts table in the "SPARE PARTS LIST – TRAILER" chapter (Page 23)

1

Install swing arms (10) to axle beam (4). Make sure that the grease nipple (18) of the swing arm is facing downwards. For fastening use M16x130 bolt (26), Ø16 mm washer (30) and M16 nyloc nut (35). Before tightening the swing-arm mounting bolt, fix it position with bolt fixing plate (9) by attaching it to the axle with M6x16 bolt (20) and Ø6 mm washer (27).

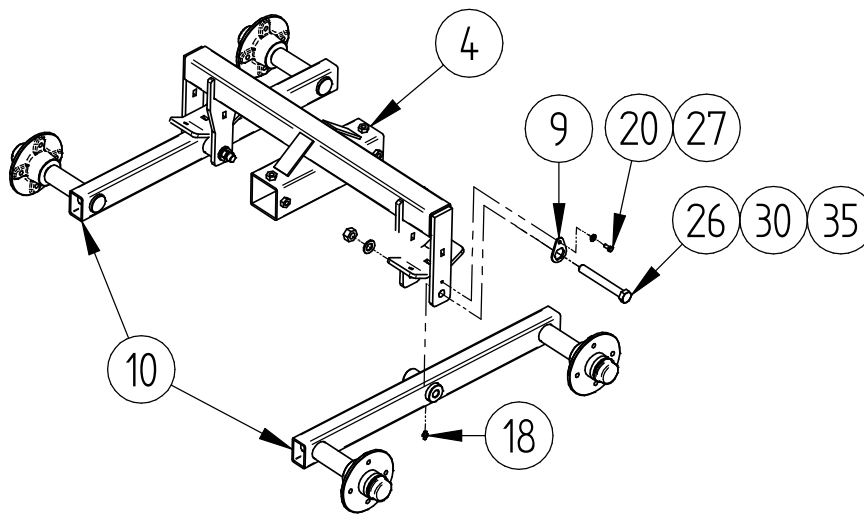

2

Install wheels (12 and 13). Watch tire direction and that the tire valve is facing outside. For fastening use wheel bolts (14).

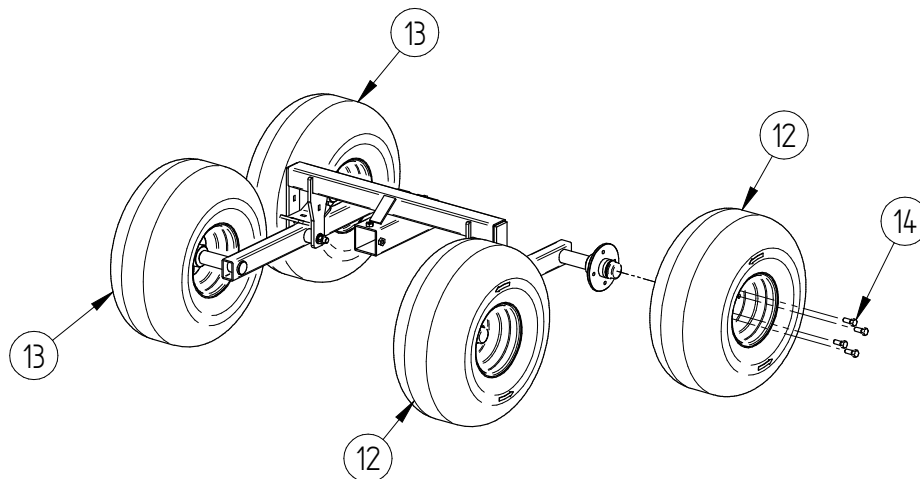

3

Install frame tube (5) to axle beam. Make sure that the drawbar mounting hole in the frame tube is vertical to ground and is on the front side of trailer! Place the axle beam in 1085 mm from the front edge of the frame tube. Secure frame tube position with M12x30 bolts (21) and lock the bolts with M12 nuts (31).

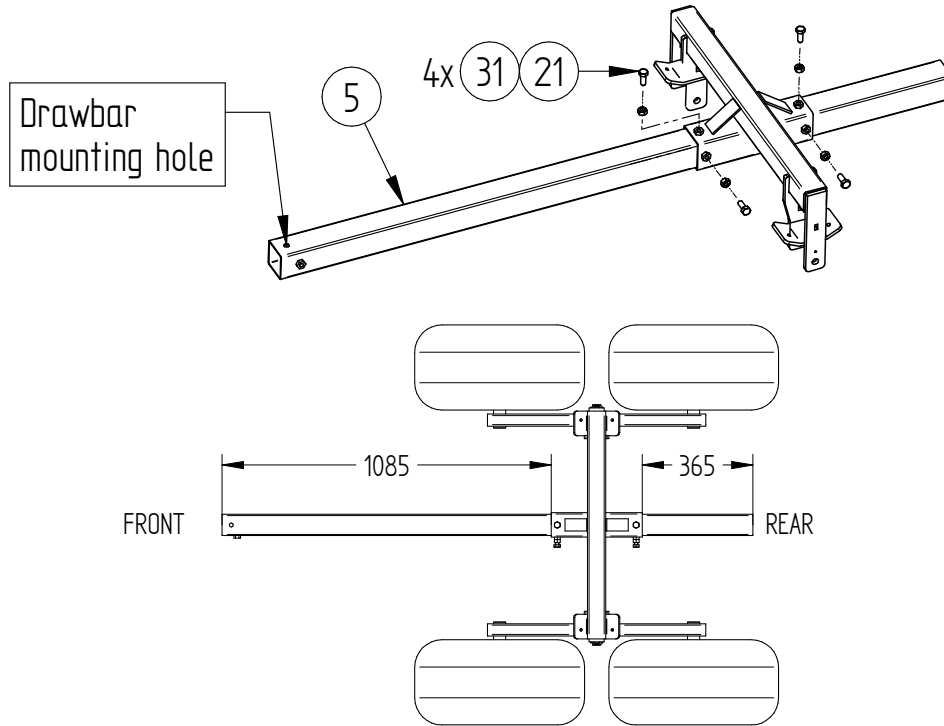

4

Install rear carrier (2) to frame tube so that the edge of the carrier is equal to edge of the frame tube. Make sure that cargo box mounting holes are on the rear side of the trailer. For fastening use 70x70 U-bolts (6), Ø10 mm washers (28) and M10 nyloc nuts (33).

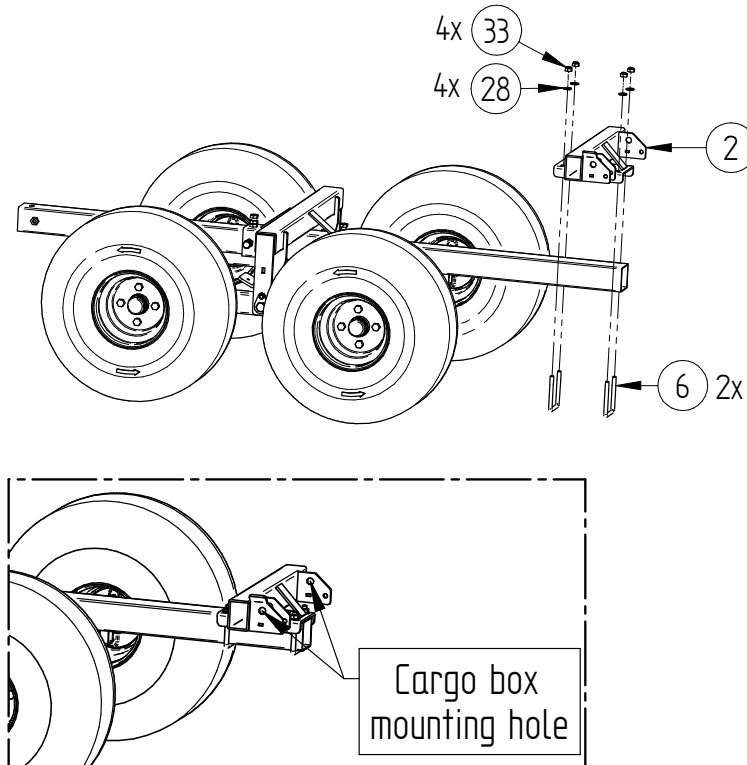

5

Install tube caps (17) and M10x80 bolts (22), Ø10 mm washers (28) and M10 nyloc nuts (33) to the rear carrier to limit the tilt angle of the cargo box.

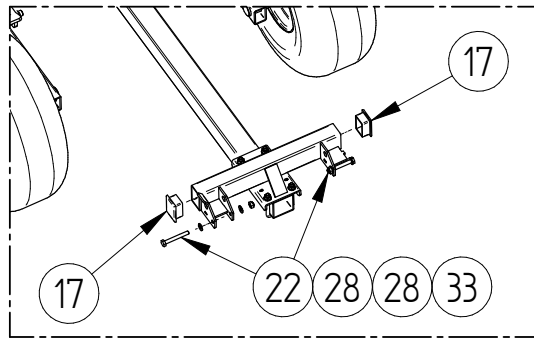

6

Install clamps (11) to the front carrier (8). For fastening use M6x12 bolts (19), Ø6 mm washers (27) and M6 nyloc nuts (32).

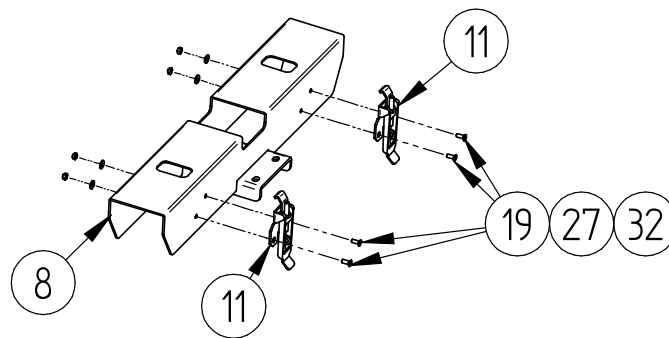

7

Install cargo box front carrier (8) to the trailer frame tube. The correct front carrier position is 1200 mm from the front edge of the rear carrier. For fastening use 70x70 U-bolts (6), Ø10 mm washers (28) and M10 nyloc nuts (33).

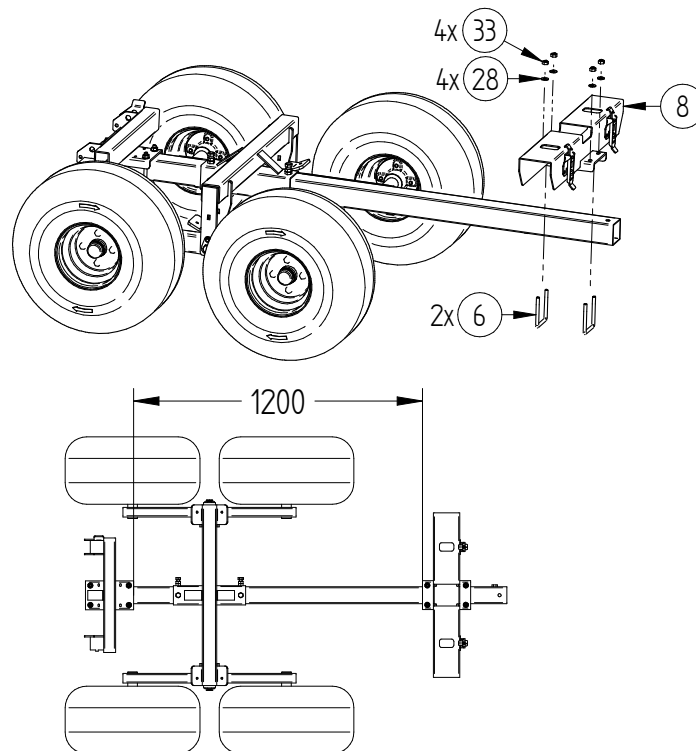

8

Install drawbar (1). For fastening use M12x90 bolt (24), Ø12 mm washers (29) and M12 nyloc nut (34). Then tighten the M12x30 bolts (21) and lock the bolt with the M12 nuts (31). Pull the rear light cables through the frame tube (5).

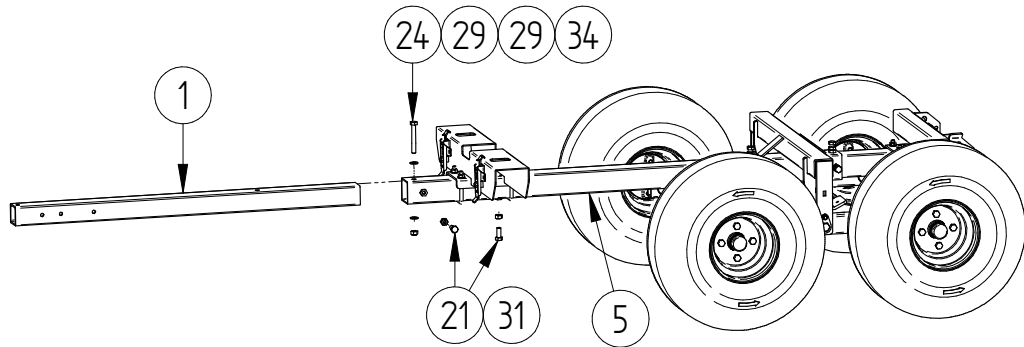

9

Install tow coupling (7) For fastening use M10x85 bolts (23), Ø10 mm washers (28) and M10 nyloc nuts (33).

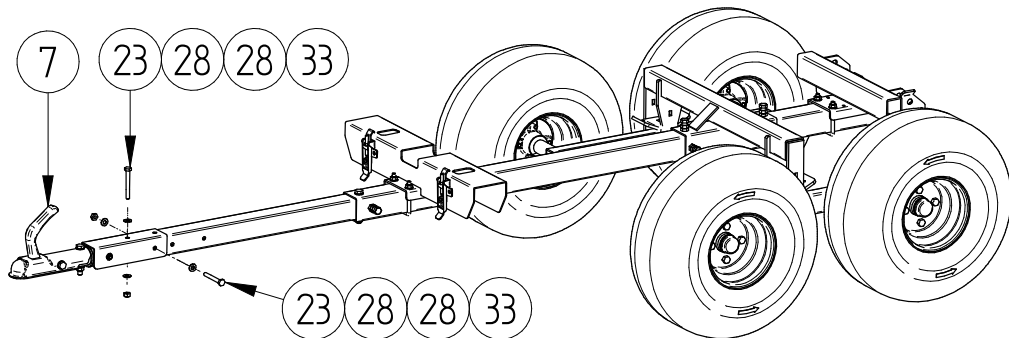

10

Install support wheel bracket (15) and support wheel (16). For fastening use M10x85 bolts (23), Ø10 mm washers (28) and M10 nyloc nuts (33).

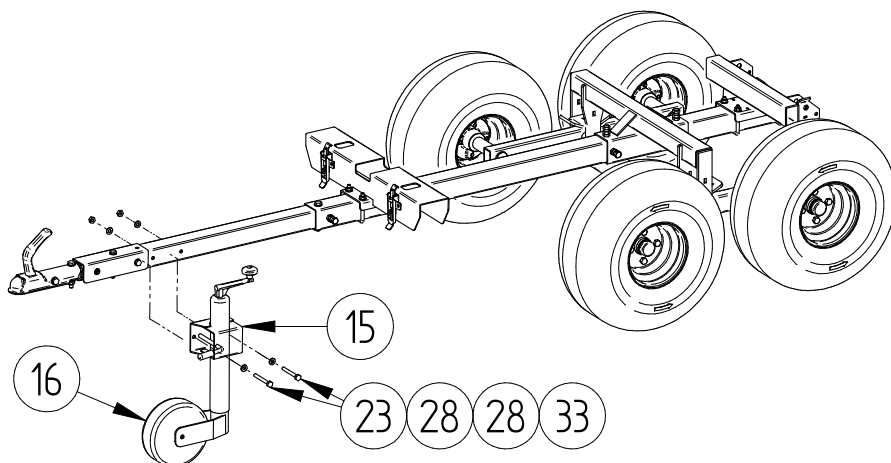

11

Install the cargo box **(3)** (see page 32 - cargo box assembling guide). For fastening the box to the rear carrier use M16x100 bolts **(25)**, Ø16 mm washers **(30)** and M16 nyloc nuts **(35)**.

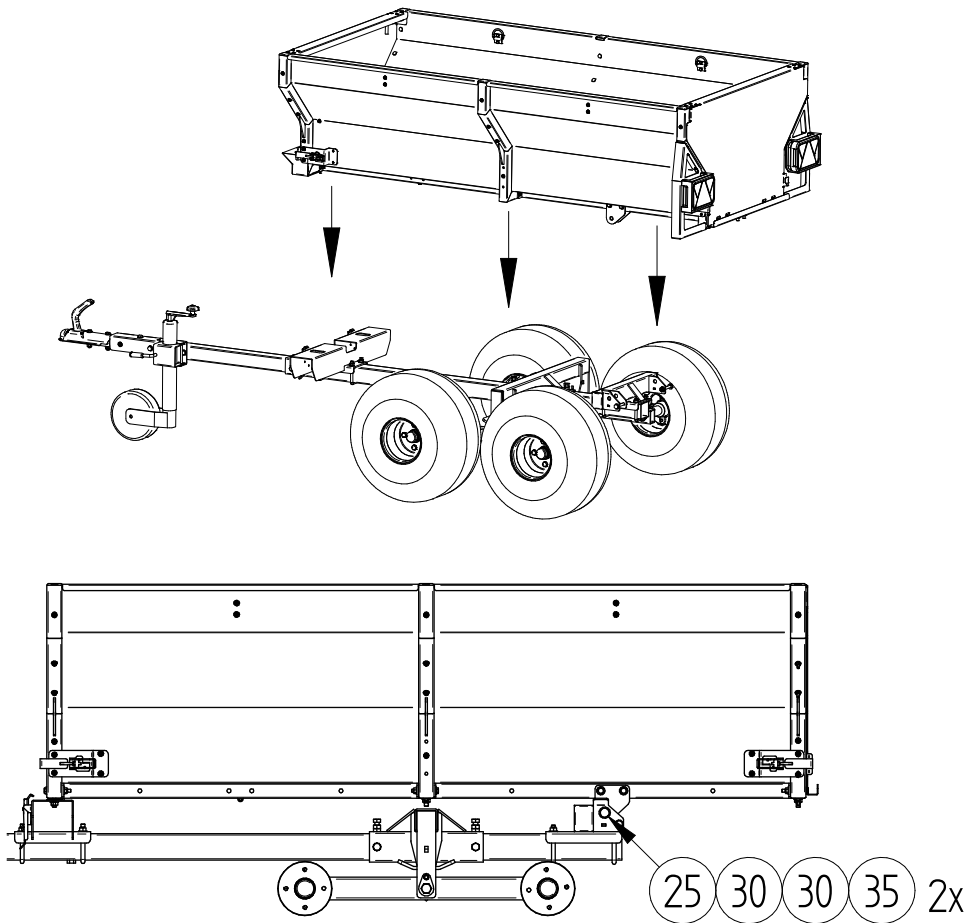
**12**

Secure the light wiring with the wire clips under the trailer box and on the light housing. When fixing, make sure that the wiring is not too tight and that there is enough room for the wire to move when tilted.

10.2. Cargo box

NB! The item numbers of the details correspond to the parts table in the "SPARE PARTS LIST – CARGO BOX" chapter (Page 25)

1

Assemble the sides of the box (3). For fastening use M6x14 bolts (24), Ø6 mm washers (34) and M6 nyloc nuts (38). Install cable clamps (17) together with bushings (13) with M6x30 bolts (25), Ø6 mm washers (34) and M6 nyloc nuts (38) into the two holes at the back of the box. NB! Do not tighten the bolts!

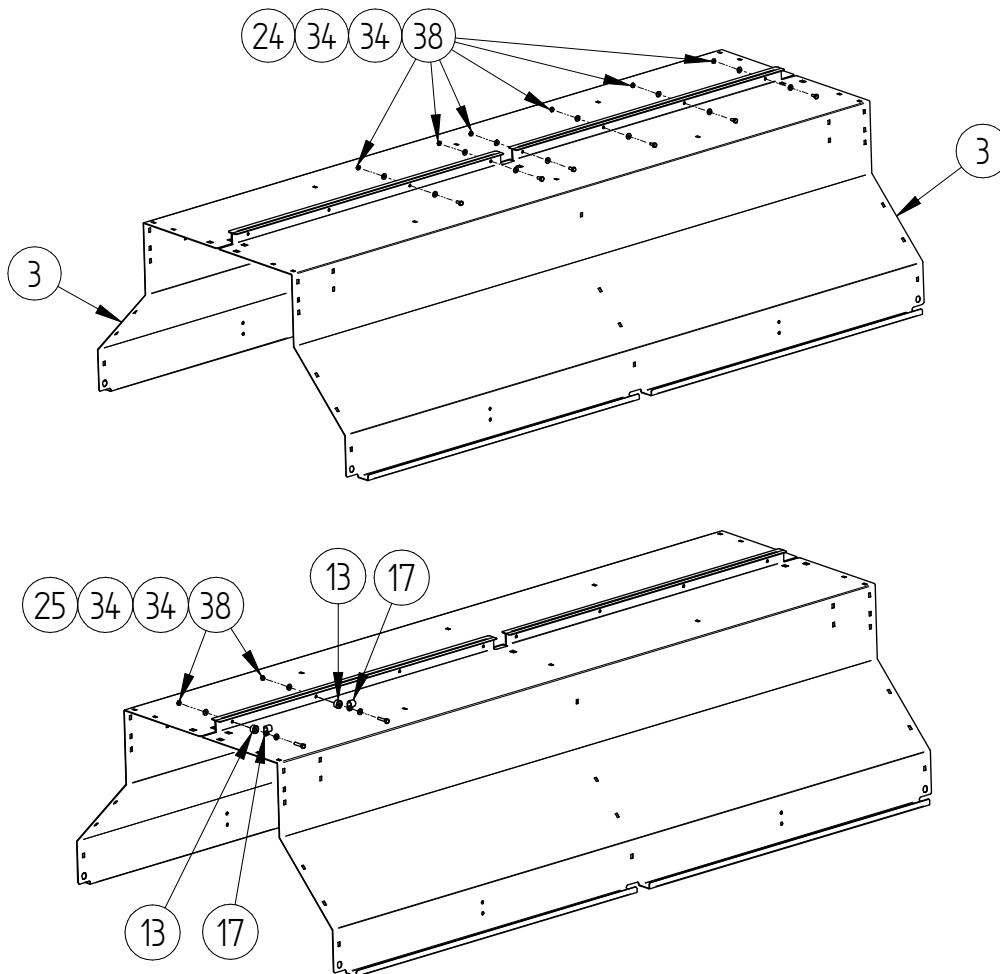

2

Install frames (4) and attach these to the sides of the box at the locations shown in the figure below. Use M6x50 carriage bolts (29), Ø6 mm washers (34) and M6 nyloc nuts (38) for fastening. NB! Do not tighten the bolts completely!

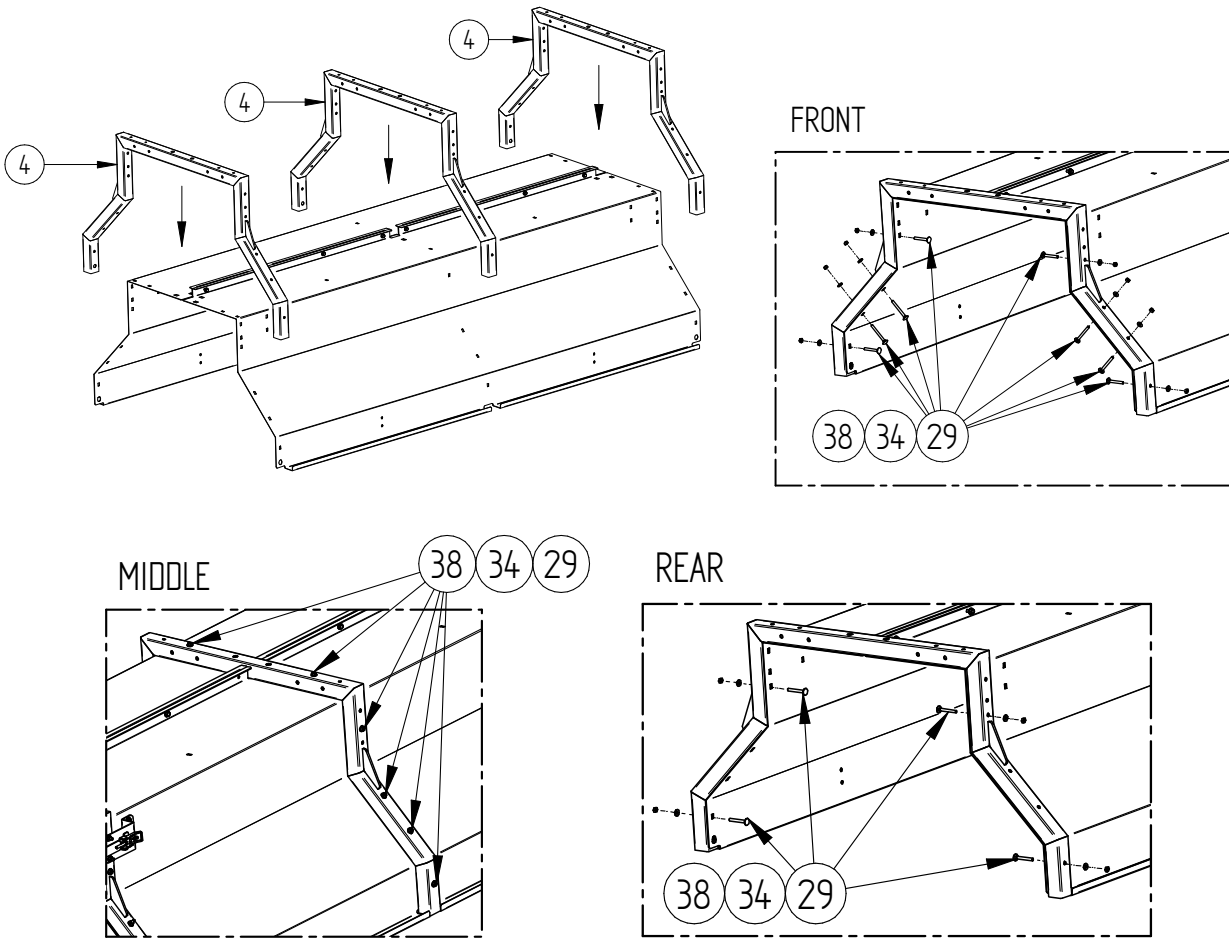

3

Install cargo box bottom frame tube (6). For fastening use M8x65 bolts (26), Ø8 mm washers (35) and M8 nyloc nuts (39).

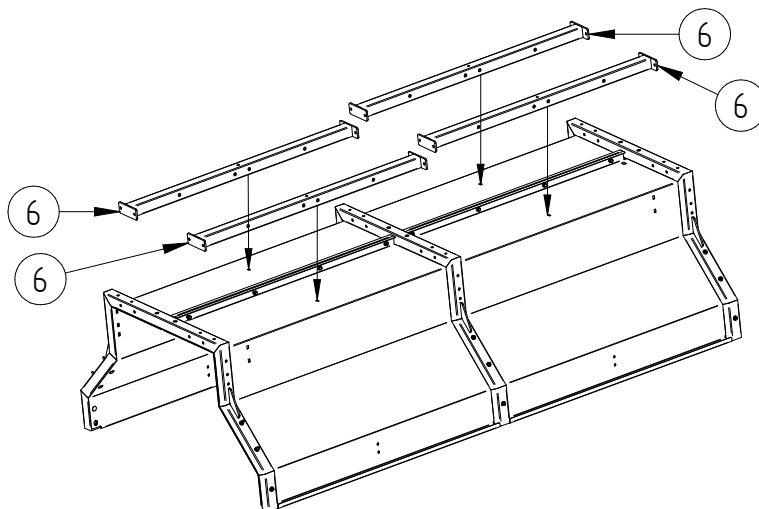

3

12x (26) (35) (35) (39)

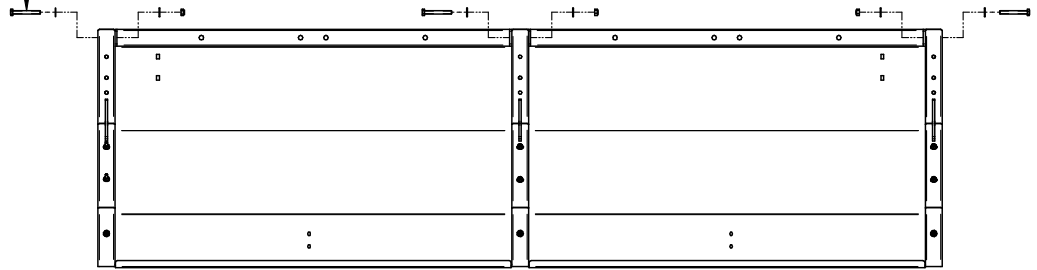

4

Install hatch locks (8). For fastening use M6x16 carriage bolts (28), M6x60 carriage bolts (30), Ø6 mm washers (34) and M6 nyloc nuts (38).

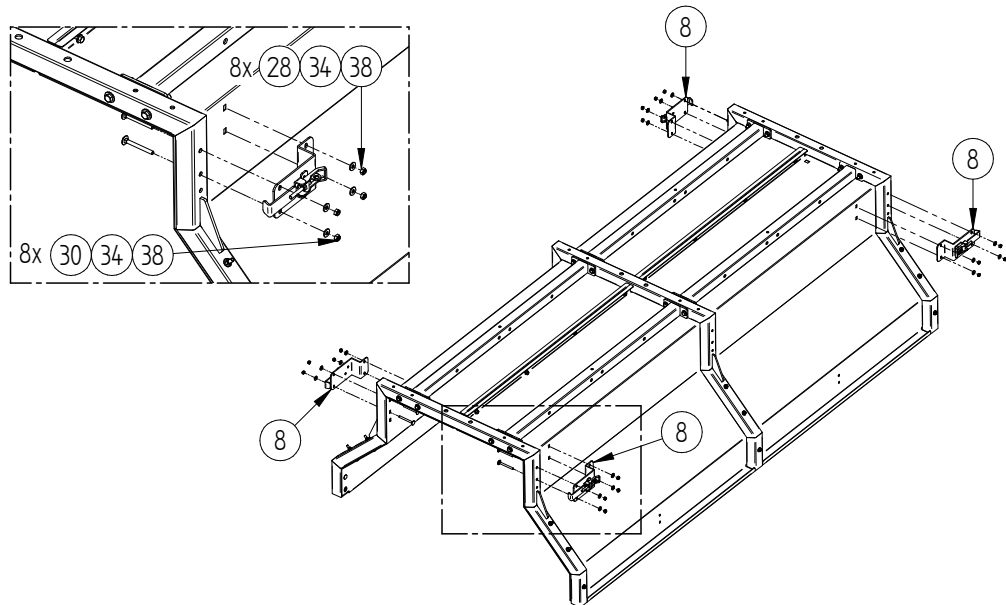

5

Install lifting adapter (5) on the front of the cargo box. For fastening use M6x60 carriage bolts (30), Ø6mm washers (34) and M6 nyloc nuts (38).

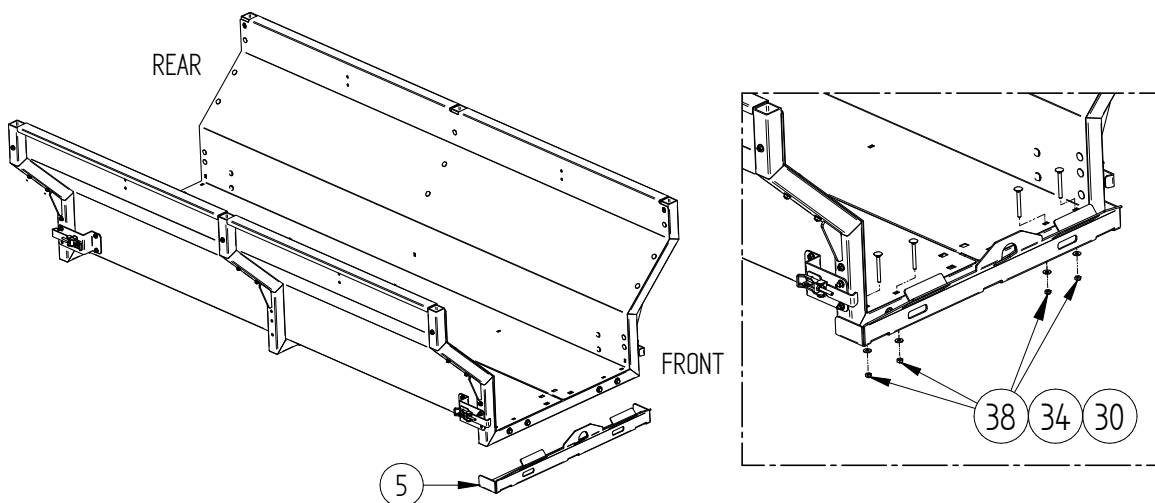

6

Install lifting point bracket (9) to lifting adapter. For fastening use M10x65 carriage bolts (32), Ø10 mm washers (36) and M10 nyloc nuts (40).

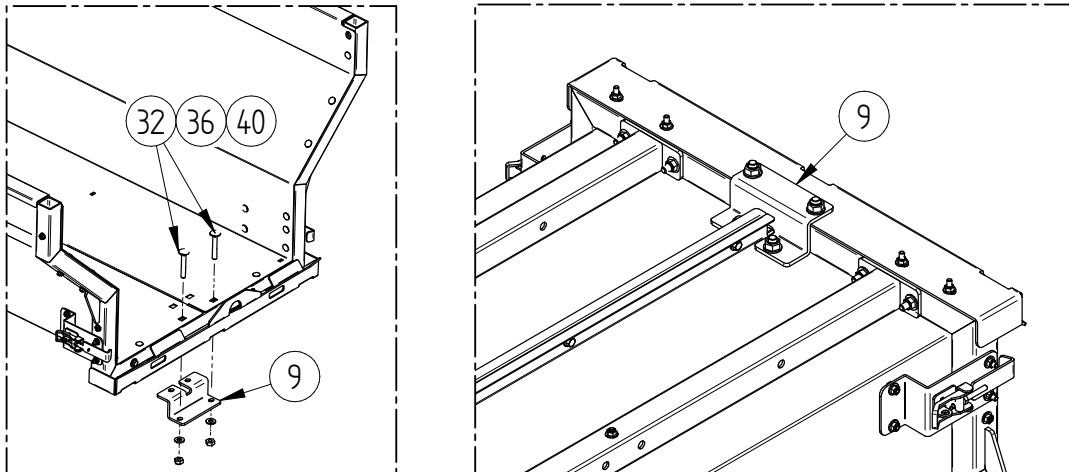
**7**

Install lifting point (19). For fastening use M10x25 carriage bolts (31), Ø10 mm washers (36) and M10 nyloc nuts (40).

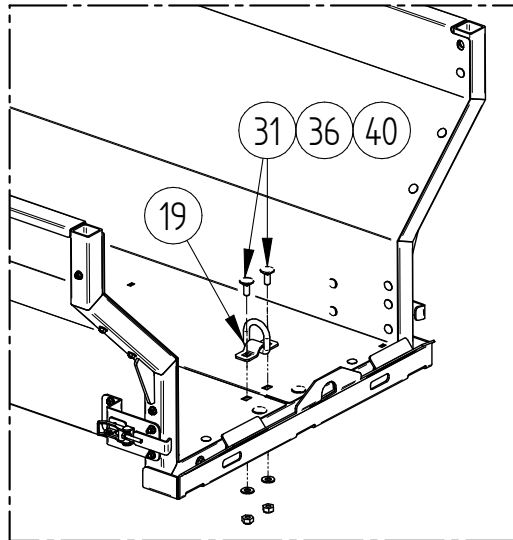
**8**

Install the light carriers (10 and 11). For fastening use M6x60 carriage bolts (30), Ø6 mm washers (34) and M6 nyloc nuts (38).

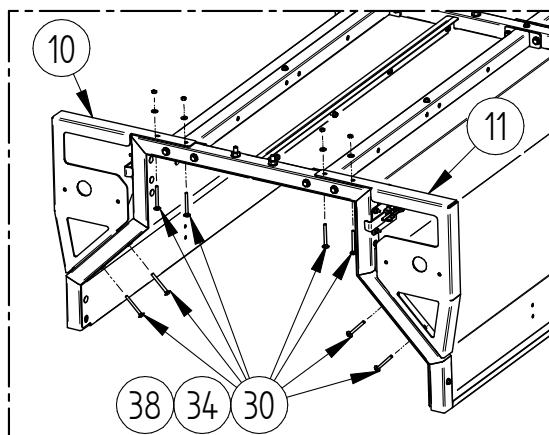

9

Install missing box frame bolts/nuts. Use M6x50 carriage bolts (29), Ø6 mm washers (34), M6 nyloc nuts (38) and M10x65 carriage bolts (32), Ø10 mm washers (36) and M10 nyloc nuts (40). Tighten all bolts/nuts described in previous steps.

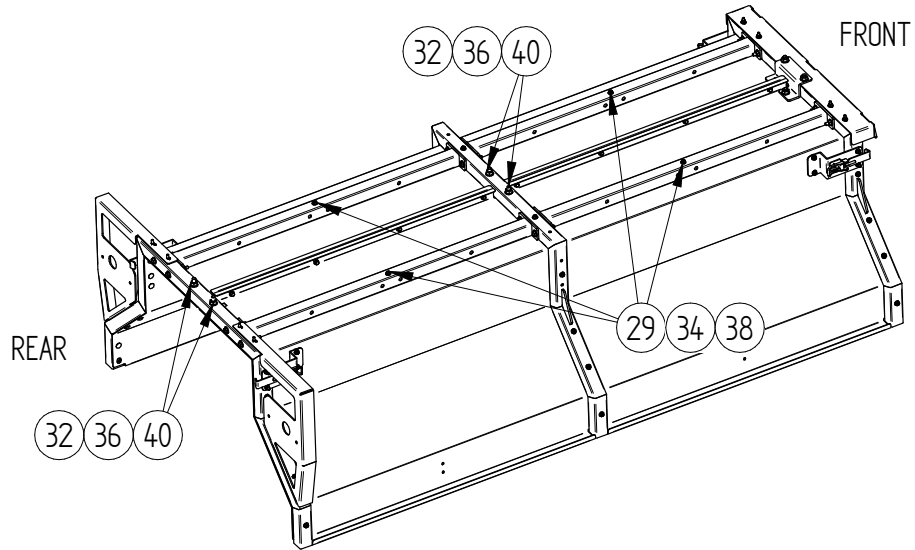
**10**

Install cargo box tilting plates (7) on the rear bottom frame tubes. For fastening use M10x70 bolts (27), Ø10 mm washers (36) and M10 nyloc nuts (40).

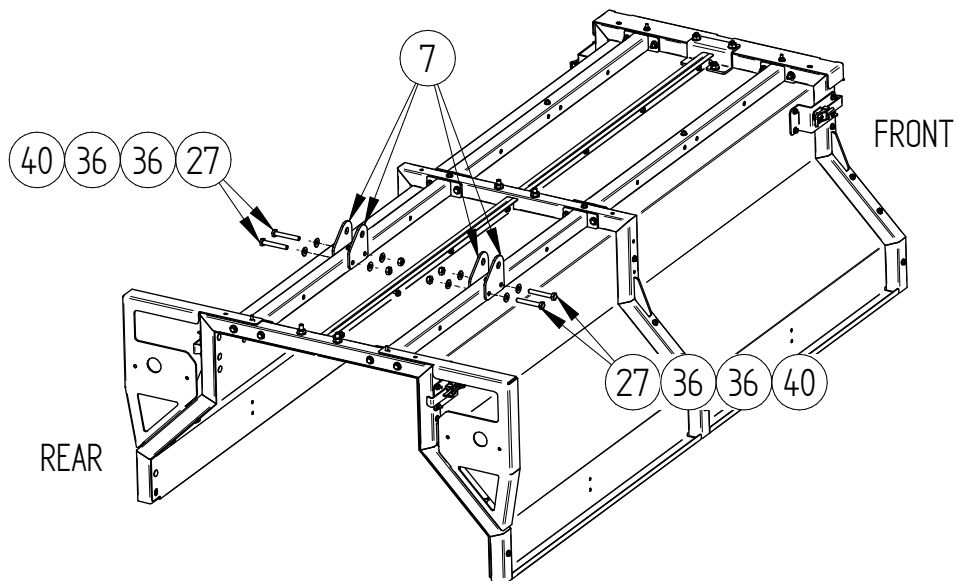

11

Install lifting points (20). For fastening use M6x14 bolts (24), Ø6 mm washers (34) and M6 nyloc nuts (38).

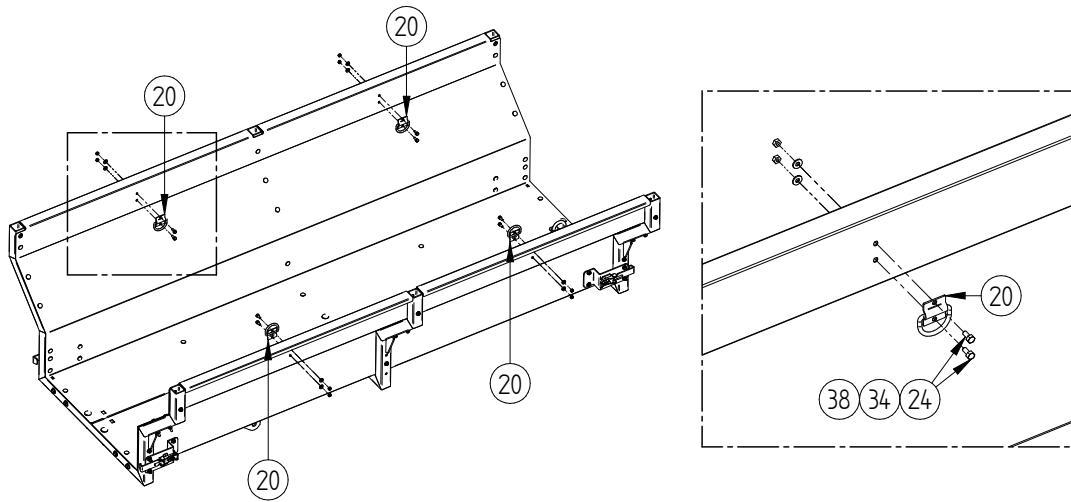

12

Install the hatches to the cargo box (1 and 2). To install, pull the latches towards the center of the hatch. Place the hatch to the box so that the latches align with the holes in the top of the cargo box. Release the latches and check that they are fully locked in the holes in the box. Lock the lower part of the hatch with the hatch locks on the box.

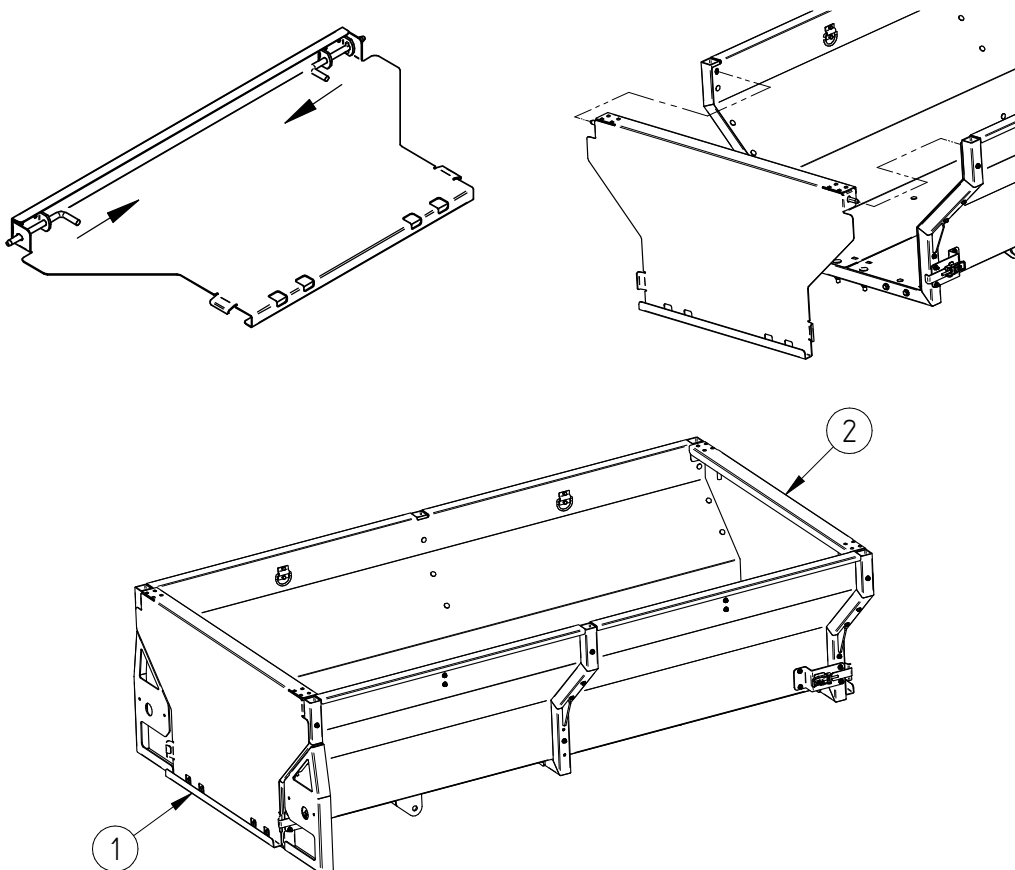

13

Install rear lights (14 and 15) together with the light covers (12). For fastening use nuts included with the lights. Under one of the nuts install cable clamp (18)

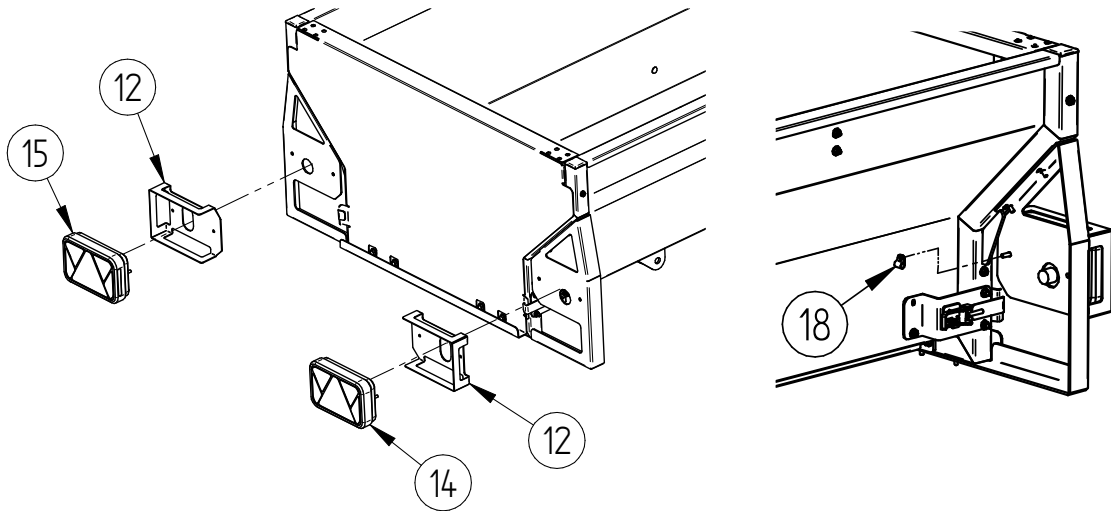

14

Drill Ø5 mm holes (2 pcs) in the cargo box hatch and install the license plate base (16) using M5x16 bolts (23), Ø5 mm washers (33) and M5 nyloc nuts (37). Make sure the license plate is in line with the taillights

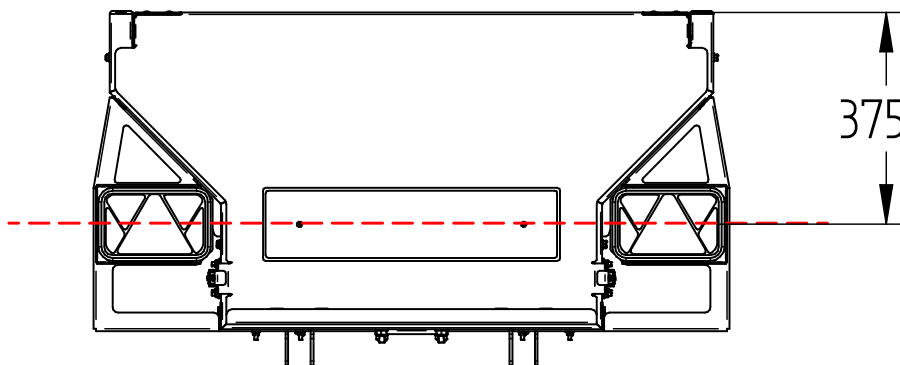
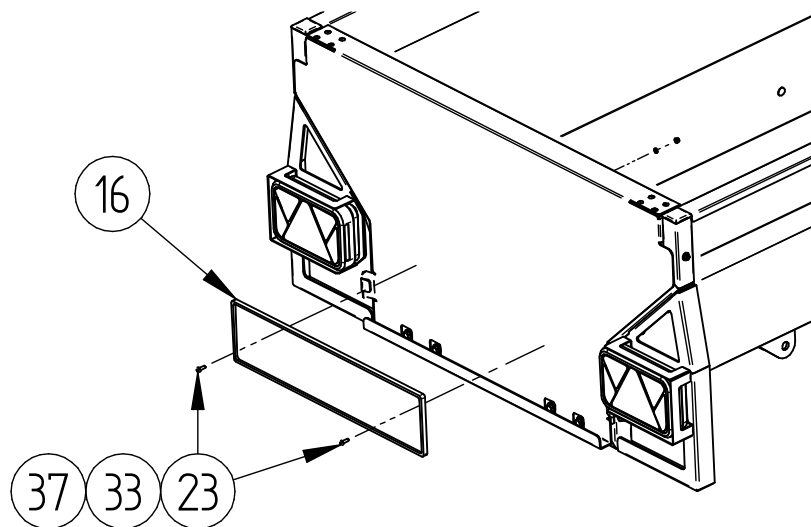

IRON BALTIC

IRON BALTIC OÜ
Joa tee 17, Vääna, Harku vald, 76903
Estonia, Europe

+372 6 533 711
sales@ironbaltic.com

www.ironbaltic.com
www.facebook.com/ironbaltic
www.youtube.com/user/ironbalticLtd

