

IRON BALTIC

VAUHTI VARIKKO

MULTILINGUAL MANUAL



code.ironbaltic.com/u/gPz8fetl

CLUTCH ROLLERS

CFMOTO CFORCE 850/1000 GEN.3

Code 80.9900

Version 26032025



Distributor **IronBaltic, Estonia**

Producer **Vauhti Varikko, Finland**

Keep this manual for future reference!

If you need any spare parts, please send this packaging data to your local dealer or to Iron Baltic sales@ironbaltic.com

SPECIFICATION

Pos.	Description	Code	Amount
1	Clutch rollers set (3pcs)	80.9901	1
2	Bolt M8x60 DIN933	OT.02.02.250	1
3	Sticker (VauhtiVarikko)	PM.13.05.024	1
4	Sticker (IronBaltic)	PM.13.05.007	1



INSTRUCTIONS

We recommend using official dealership installation services; they have the correct tools and knowledge for such installation.

1. Remove left side passenger footrest



2. Remove plastic cover



3. Open CVT cover. Remember the order of the bolts because some bolts are longer!



4. Use supplied M8x60 bolt to loosen the belt. Remove the belt and M8x60 bolt afterwards.
NB! Notice the direction the belt is on, so you can reinstall it in the same direction afterwards!

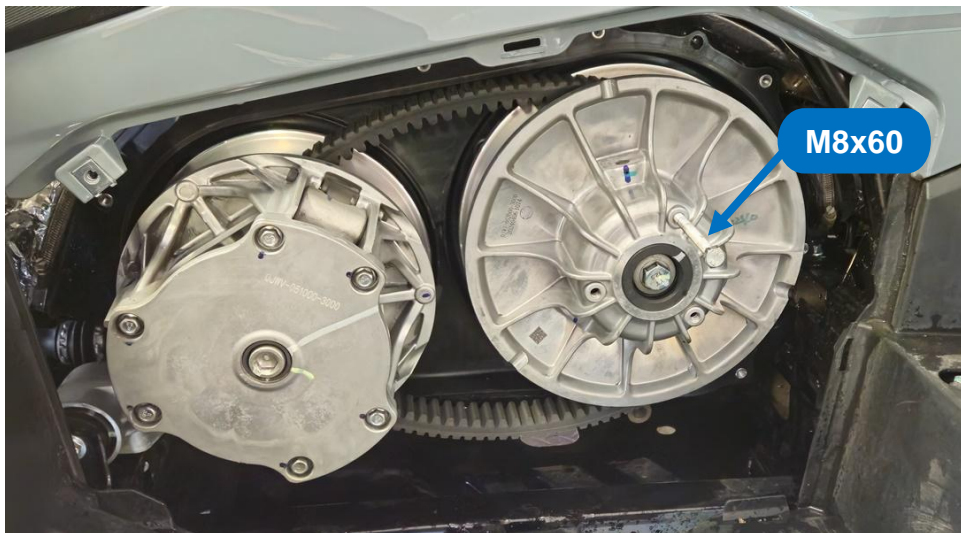

5. Remove the clutch bolt. Use 18mm socket. You can use clutch holding tool 80.2300 to hold the clutch in place.

Remove the clutch from the shaft.

NB! There might be distance washer behind the secondary clutch, make sure not to lose it!

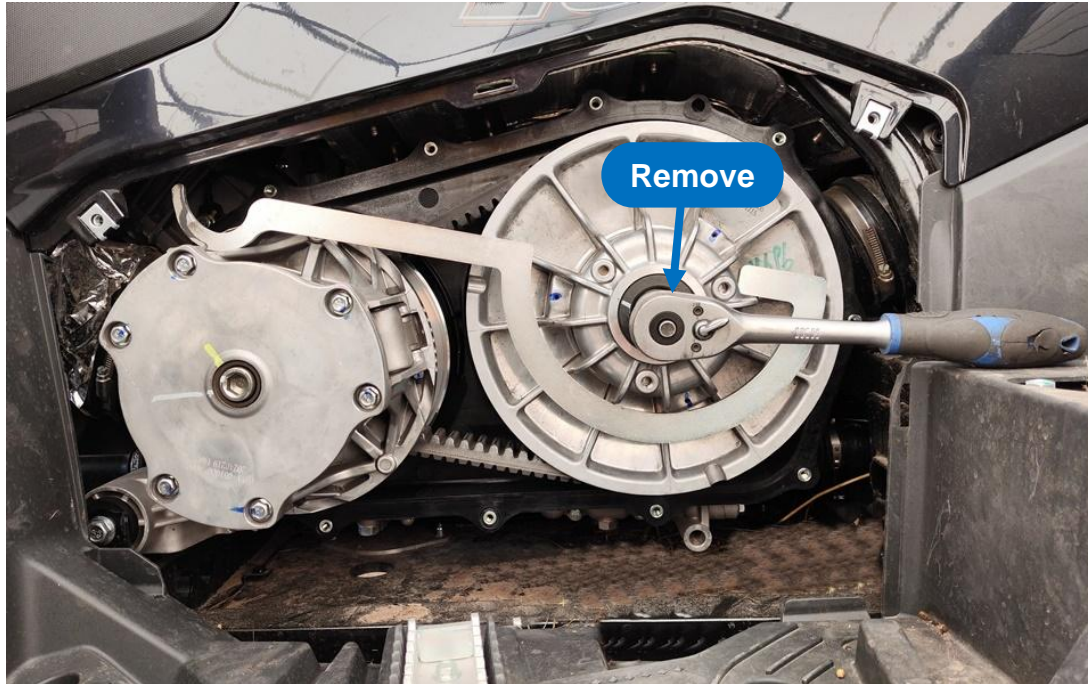

6. Mark the position of clutch sheaves! Remove 3 bolts holding the clutch sheave and separate two halves.



7. Compress* the spring and remove the circlip. Slowly remove the tension from the spring and remove the support washer, spring and helix.

**A special tool (clutch spring compression tool: 80.400) is required.*



8. Remove old rollers and install new ones. NB! Make notice which way the rollers are installed!

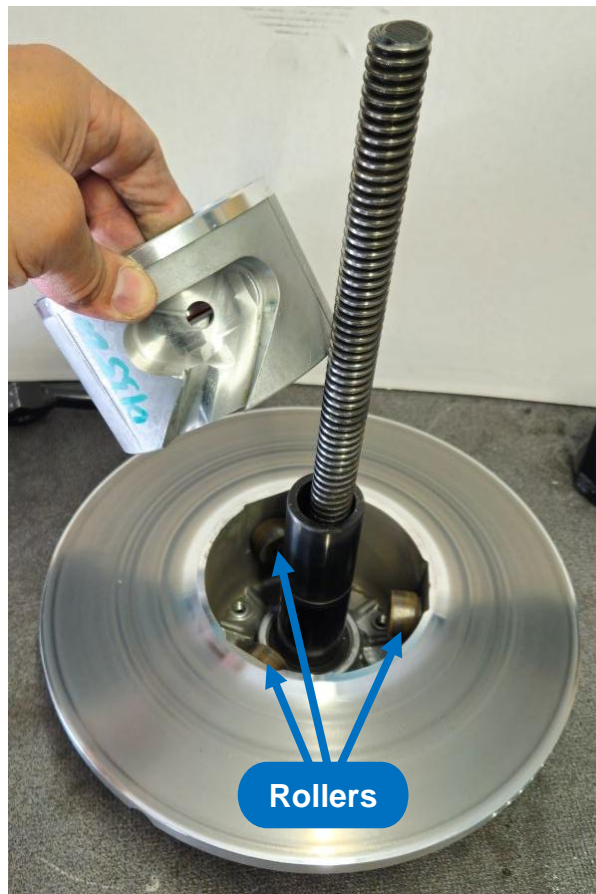

9. Install helix and spring back. Place the support washer and circlip on top of the new spring.



10. Compress the spring with compression tool (80.400) and reinstall the circlip. Slowly remove the tension from the spring.



11. Connect two halves of secondary clutch. Make sure that two marks align or are close to each other!
Torque the bolts to 70Nm!

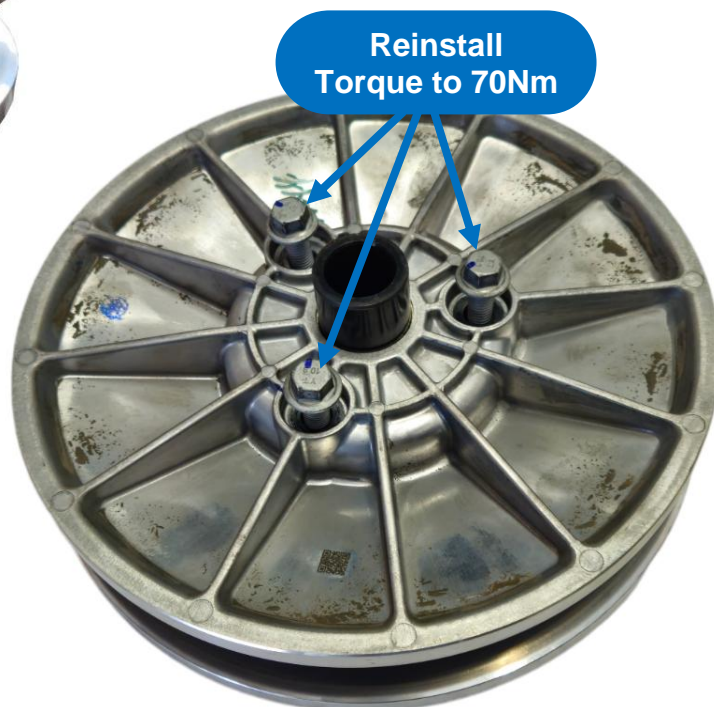
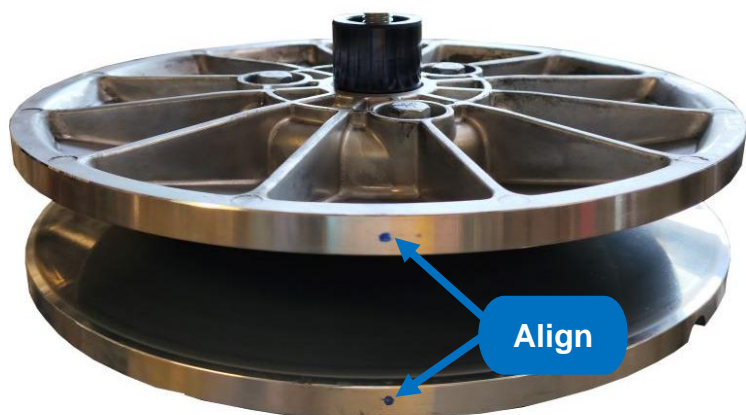

12. Reinstall the secondary clutch to ATV. Torque the bolt to 110Nm!
You can use clutch holding tool 80.2300 to hold the clutch in place.

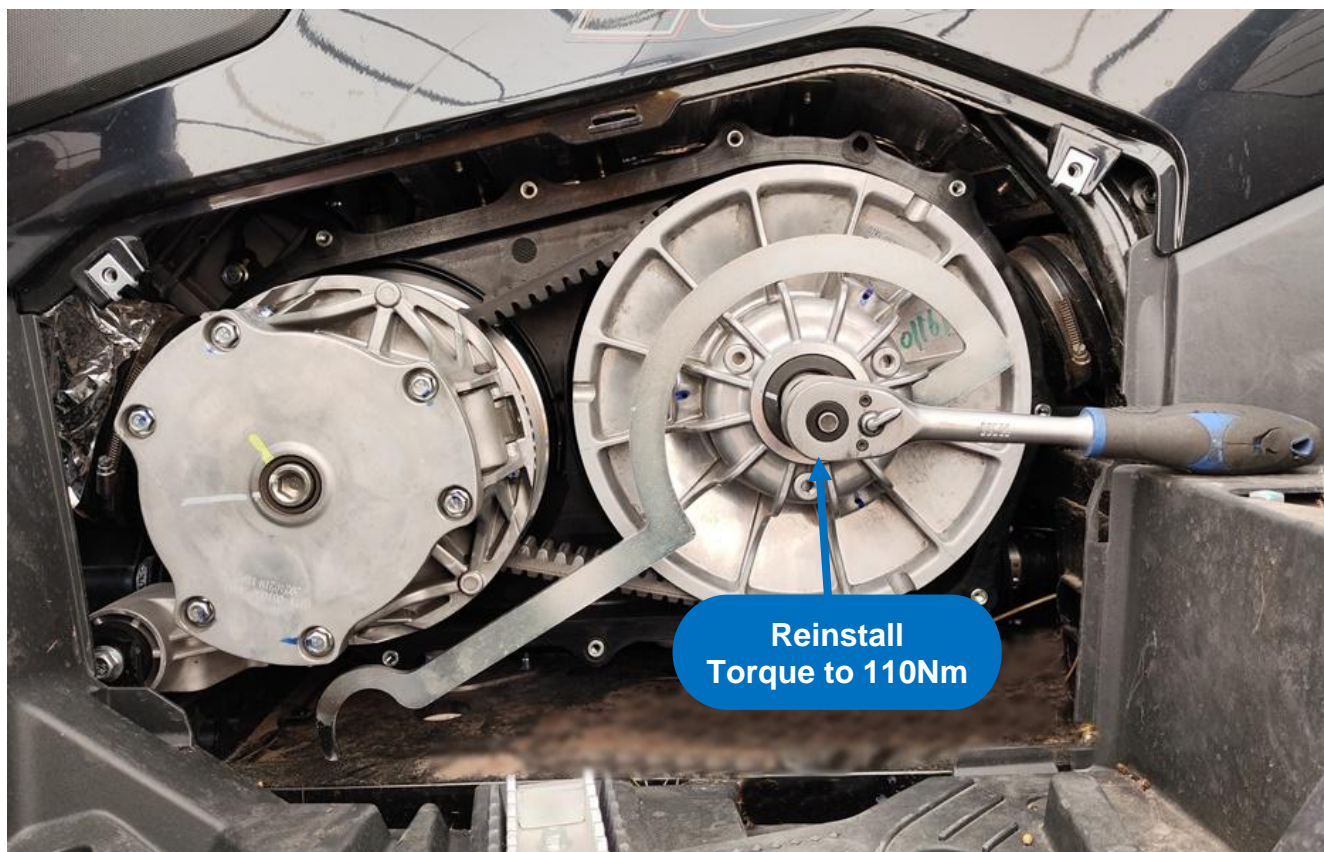

13. Screw in the M8x60 bolt to secondary clutch and reinstall the belt.
NB! Notice the direction of the belt when reinstalling!

14. Reinstall the CVT cover.

15. Reinstall the plastic cover.

16. Reinstall the passenger footrest.

You are ready to test drive!

IRON BALTIC

IRON BALTIC OÜ
Joa tee 17
Vääna 76903
Estonia / Europe

+372 6 533 711
sales@ironbaltic.com

www.ironbaltic.com
www.facebook.com/ironbaltic
www.youtube.com/user/ironbalticld