

MID-MOUNT ADAPTER

AODES

800 / Assailant Zeus

Code 03.9100

Version 10112023



Keep this manual for future reference!

If you need any spare parts, please send this packaging data to your local dealer or to Iron Baltic sales@ironbaltic.com

DOWNLOAD MULTILINGUAL
USER MANUAL



code.ironbaltic.com/u/Thq7ivE2

SPECIFICATION

Pos.	Description	Code	Amount
1	Adapter	03.9101K	1
2	U-Bolt (longer)	14.009	2
3	U-Bolt M8x38	OT.05.01.030	2
4	Pin 10x40 mm DIN 1444	14.003	2
5	Locking pin 2 mm DIN 11024	OT.07.01.010	2
6	Bolt M6x20 DIN 933	OT.02.02.060	4
7	Washer 6/15 SFS 3738	OT.04.03.020	4
8	Washer 8/20 SFS3738	OT.04.03.030	8
9	Nut M8 Nyloc DIN 985	OT.03.02.040	8

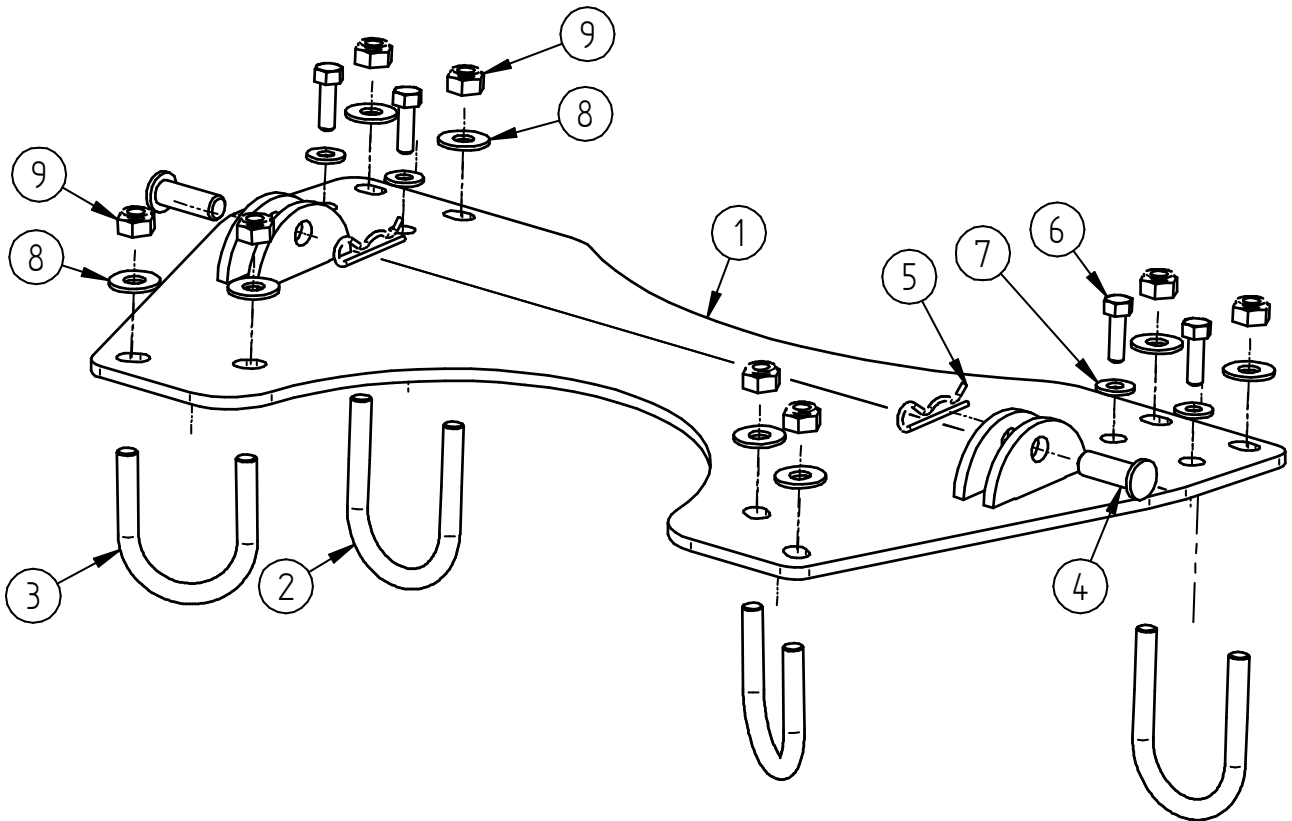

FITTING INSTRUCTIONS

Step 1

Remove original plastic protector or drill holes for adapter.

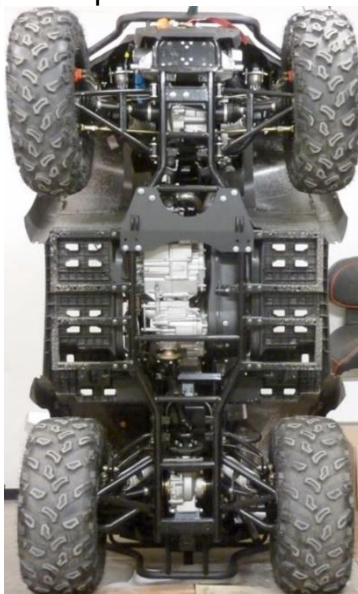

Step 2

Install plow adapter. If you use IronBaltic skide plate, remove bolts indicated with arrows. On aluminium skid plate reinstall connecting plates through holes on adapter, use supplied M6x20 bolts with M6/15 washer (Pos.6;7). On plastic skid plate remove the connecting plates, U-bolts go through connecting plate holes!

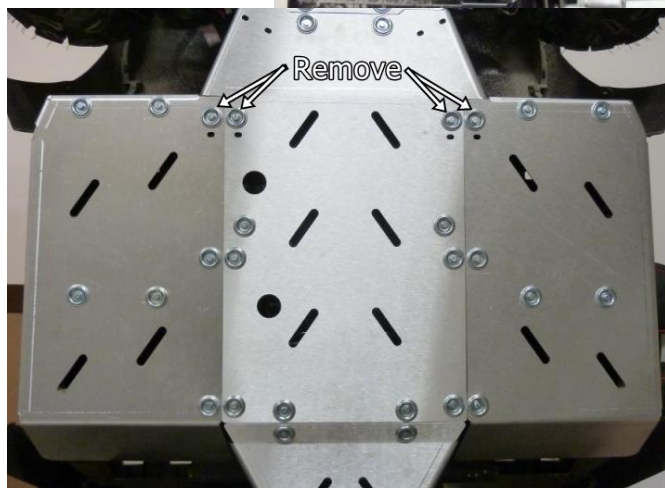
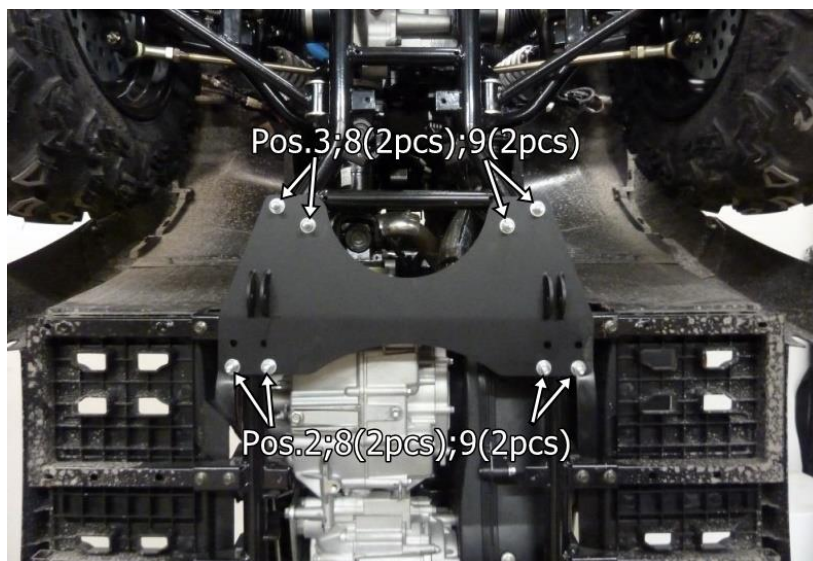

ALUMINIUM

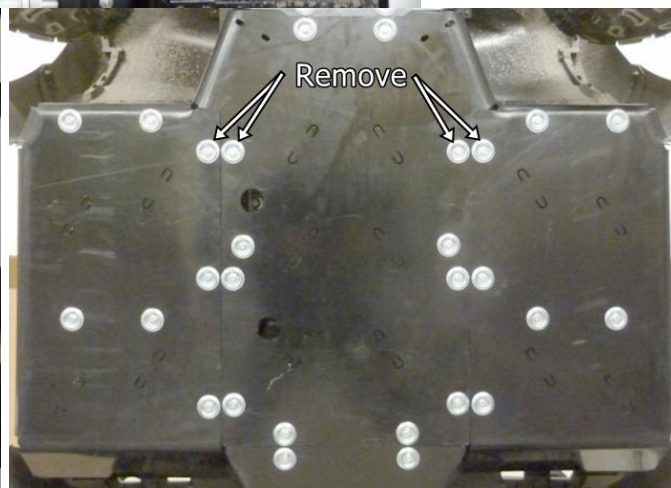

PLASTIC

IRON BALTIC

IRON BALTIC OÜ
Joa tee 17
Vääna 76903
Estonia / Europe

+372 6 533 711
sales@ironbaltic.com

www.ironbaltic.com
www.facebook.com/ironbaltic
www.youtube.com/user/ironbalticLtd

