

# IRON BALTIC

DOWNLOAD MULTILINGUAL  
USER MANUAL



[code.ironbaltic.com/u/HXiiccV6](https://code.ironbaltic.com/u/HXiiccV6)

## PLASTIC SKID PLATE

# SEGWAY SNARLER AT10 L

Code 02.34300

Version 02062025



**Keep this manual for future reference!**

If you need any spare parts, please send this packaging data to your local dealer or to Iron Baltic  
[sales@ironbaltic.com](mailto:sales@ironbaltic.com)

# SPECIFICATION

Pos.	Description	Code	Amount
1	Front protection (1)	02.34302K	1
2	Front protection (2)	02.34303K	1
3	Middle protection	02.34304	1
4	Oil filter cover plate	02.27505K	1
5	Rear protection	02.34305K	1
6	Right side protection	02.34306K	1
7	Left side protection	02.34307K	1
8	Front right arm protection	02.34308	1
9	Front left arm protection	02.34309	1
10	Rear right arm protection	02.34310	1
11	Rear left arm protection	02.34311	1
12	Connecting plate	02.5006	12
13	Installation bracket	02.6408	6
14	Clamp for front arm protection	02.8210	2
15	Conical washer Ø6	14.502	2
16	Dished washer	14.503	63
17	Bolt M6x14 DIN933	OT.02.02.040	30
18	Bolt M6x20 DIN933	OT.02.02.060	12
19	Bolt M6x25 DIN933	OT.02.02.070	18
20	Bolt M6x30 DIN933	OT.02.02.080	7
21	Bolt M6x45 DIN933	OT.02.02.110	2
22	Bolt M8x50 DIN931	OT.02.01.011	2
23	Bolt M6x25 DIN7991	OT.02.04.040	2
24	Bolt M10x1,25-30 DIN912 ZP	OT.02.06.055	2
25	Washer Ø6/15 SFS3738	OT.04.03.020	63
26	Washer Ø6/18 DIN9021	OT.04.02.020	12
27	Washer Ø8/20 SFS3738	OT.04.03.030	2
28	Nyloc nut M6 DIN985	OT.03.02.030	6

- **Designing the skid plate, original/factory tires were taken into consideration (front: 27x9.00-14 and rear: 27x11.00-14).**



## TOOLS REQUIRED FOR INSTALLATION:

- Hex key 4 mm
- Hex key 5 mm
- Hex key 8 mm
- Spanner 10 mm
- Spanner 13 mm
- Socket wrench 10 mm
- Socket wrench 13 mm

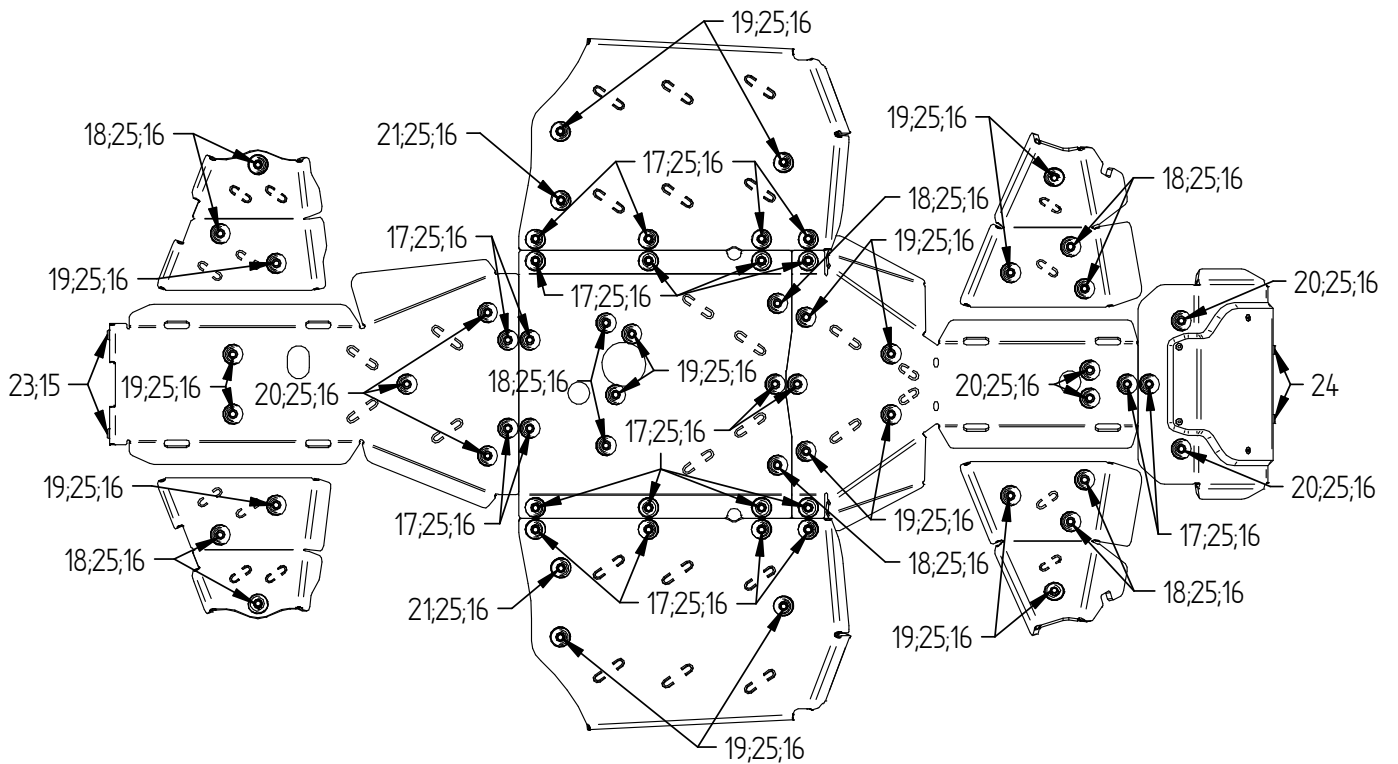
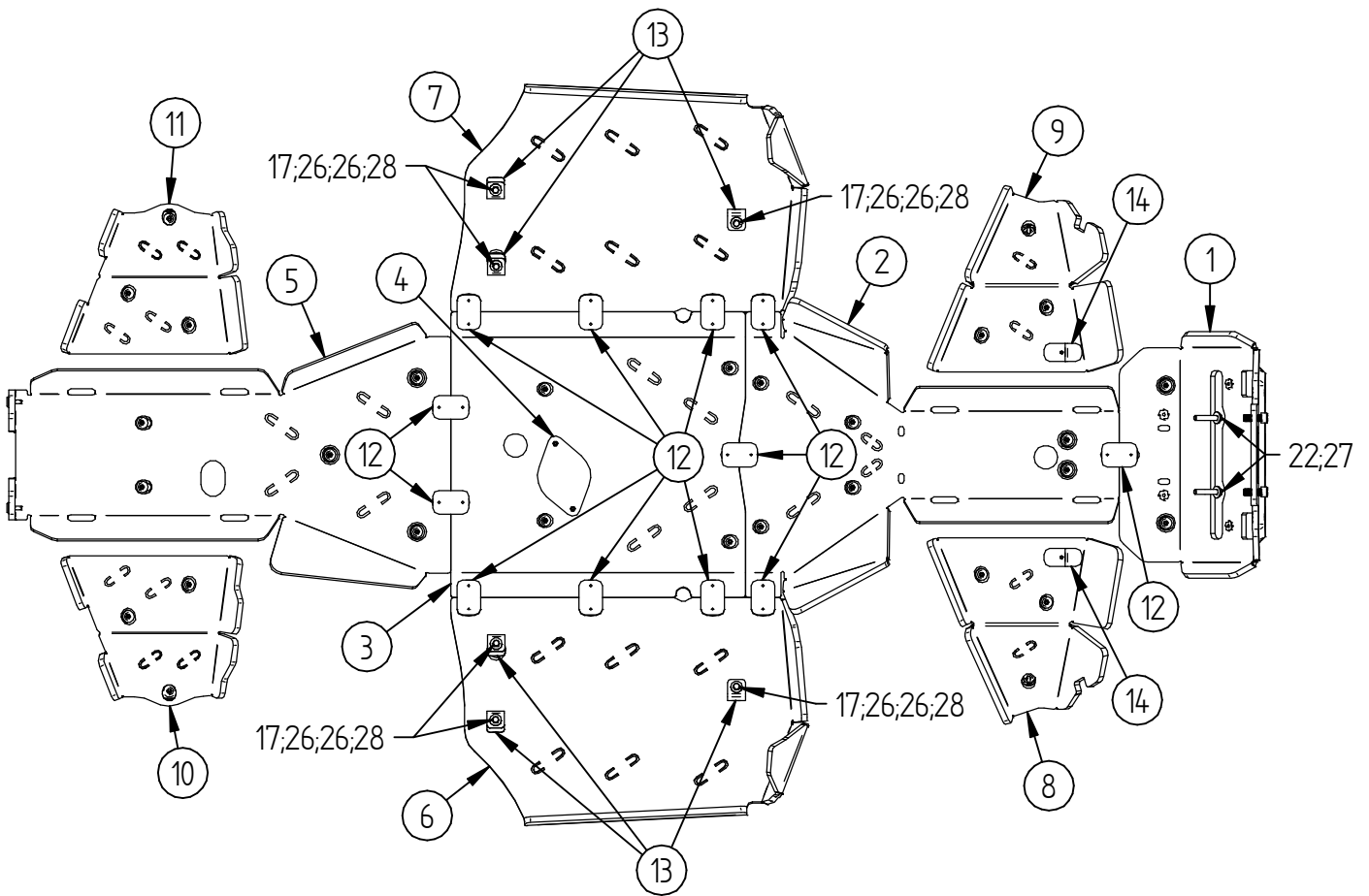

*\* Numbers on drawing correspond to Pos numbers on specification table.*

# FITTING INSTRUCTIONS



## NB!

**We recommend using thread lock fluid on the bolts!  
Bolts tend to loosen with vibration from ATV.**

**All pictures in this manual are for illustration purposes only and may differ from real product due to the changes made to the product during improvements!**

## Step 1

Remove original skid plate parts and control arm protections. Also remove two lower original winch fixing bolts with washers and use M8x50 bolts (Pos.22) and Ø8 mm washers (Pos.27) instead.

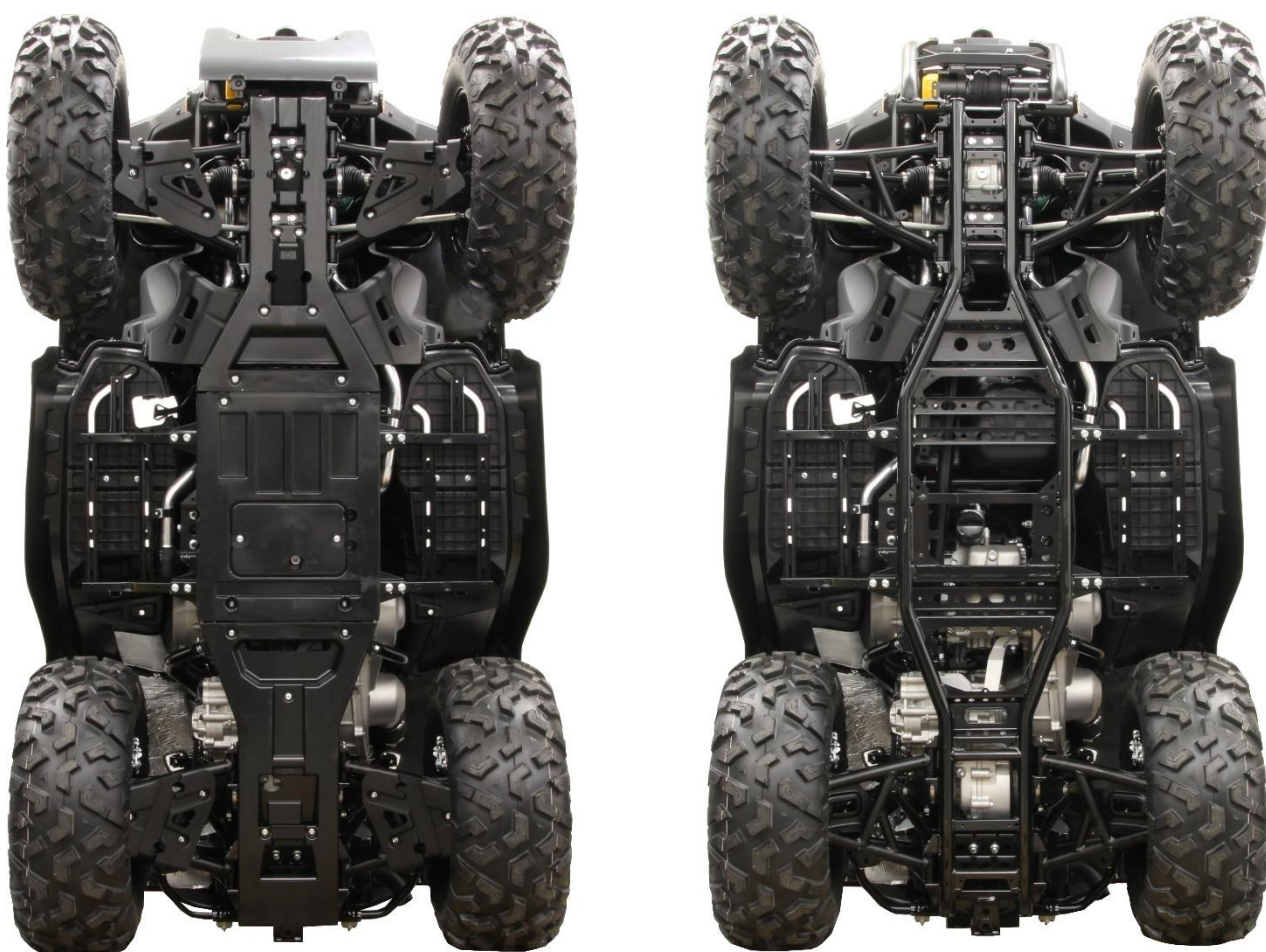

## Step 2

Install the installation brackets (Pos.13). For fastening use M6x14 bolts (Pos.17), Ø6/18 mm washers (Pos.26) and M6 nyloc nuts (Pos.28). When installing the upper bracket, you may need more space. Remove the original plastic bolts and push the plastic cover aside. Afterward, reinstall original bolts.

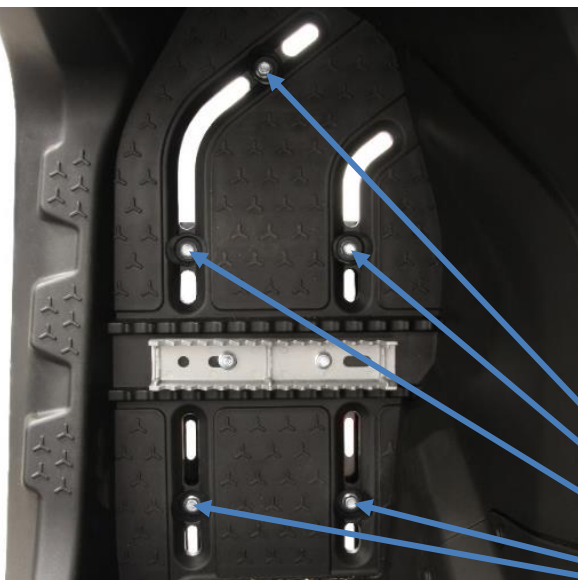
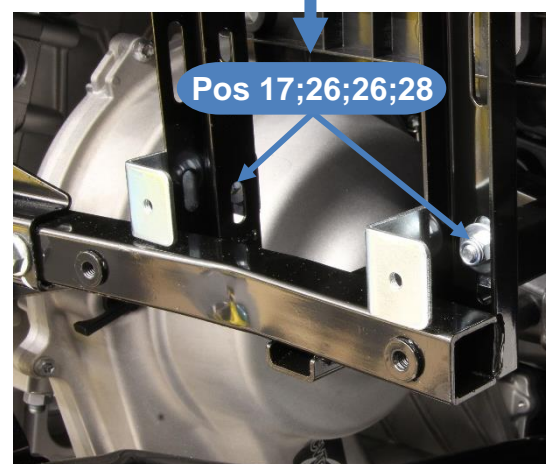
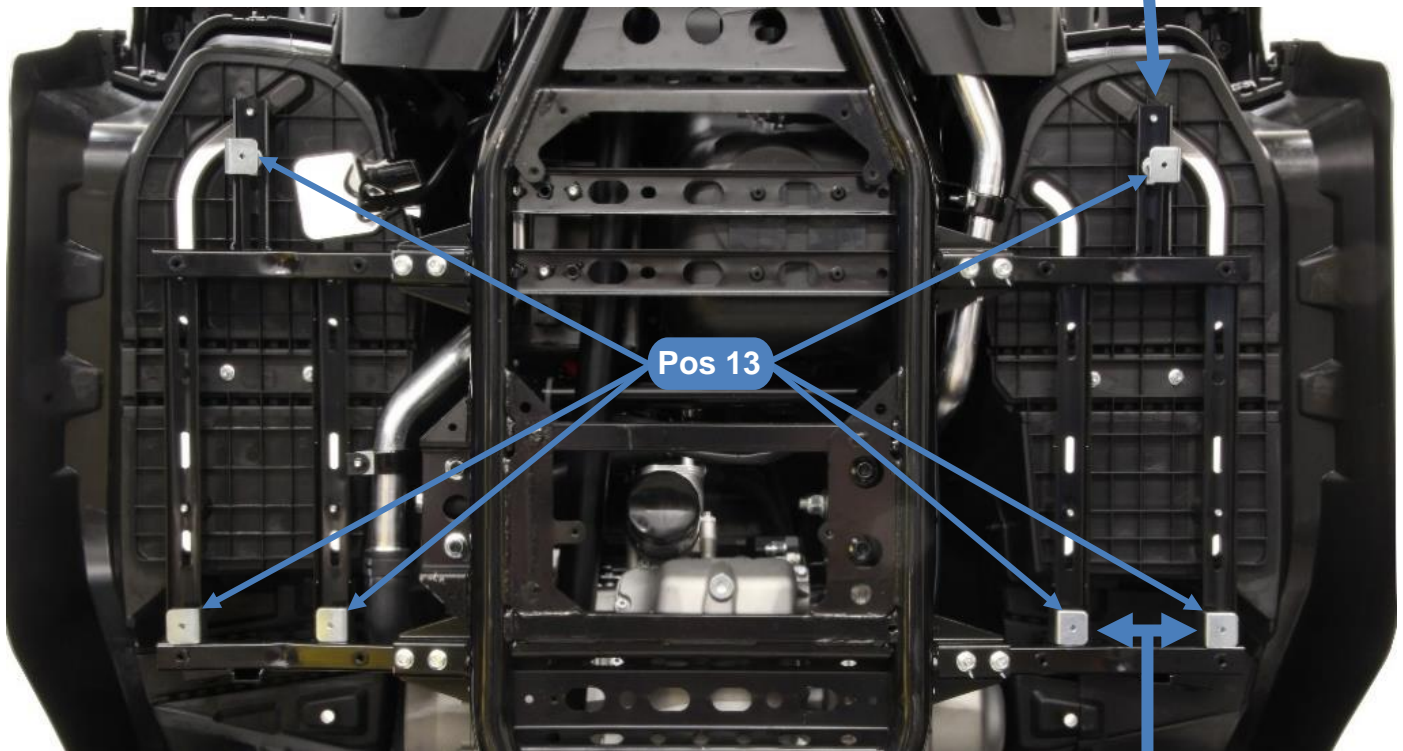

Remove  
(if necessary)

### Step 3

Install the oil filter plate (Pos.4) to the middle protection (Pos.3). For fastening use M6x25 bolts (Pos.19), Ø6 mm washers (Pos.25) and dished washers (Pos.16).

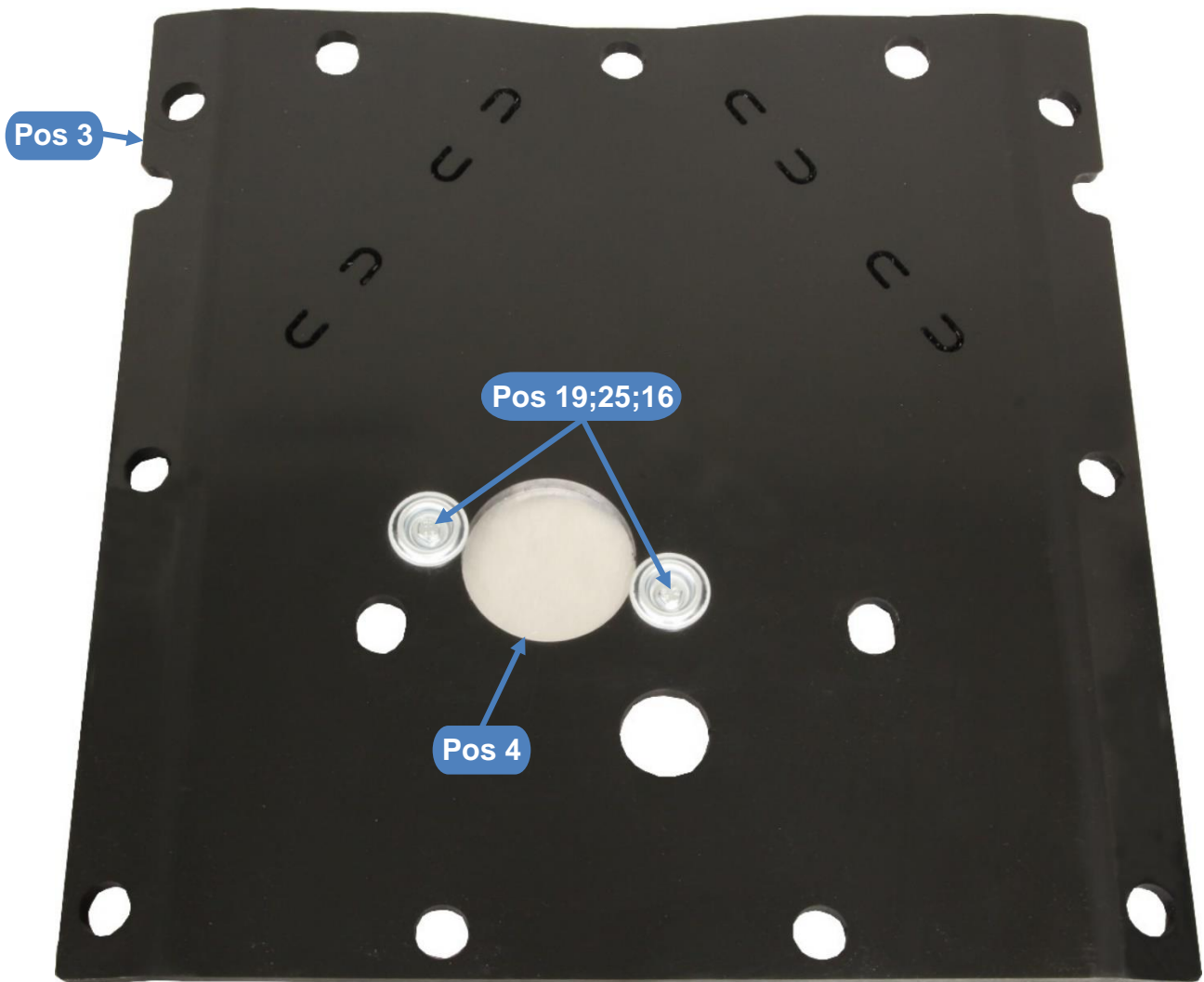

## Step 4

Install the front protection 2 (Pos.2). For fastening use M6x25 bolts (Pos.19), M6x30 bolts (Pos.20), Ø6 mm washers (Pos.25) and dished washers (Pos.16).

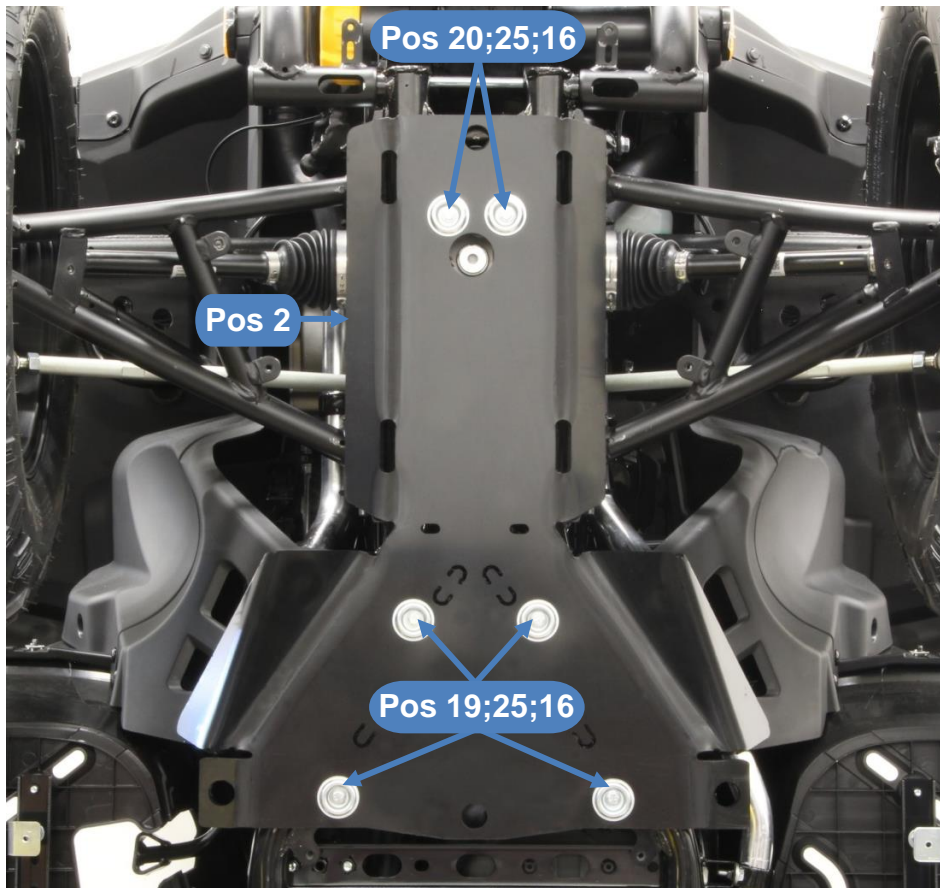

## Step 5

Install the connecting plates (Pos.12) to the front protection. For fastening use M6x14 bolts (Pos.17), Ø6 mm washers (Pos.25) and dished washers (Pos.16).

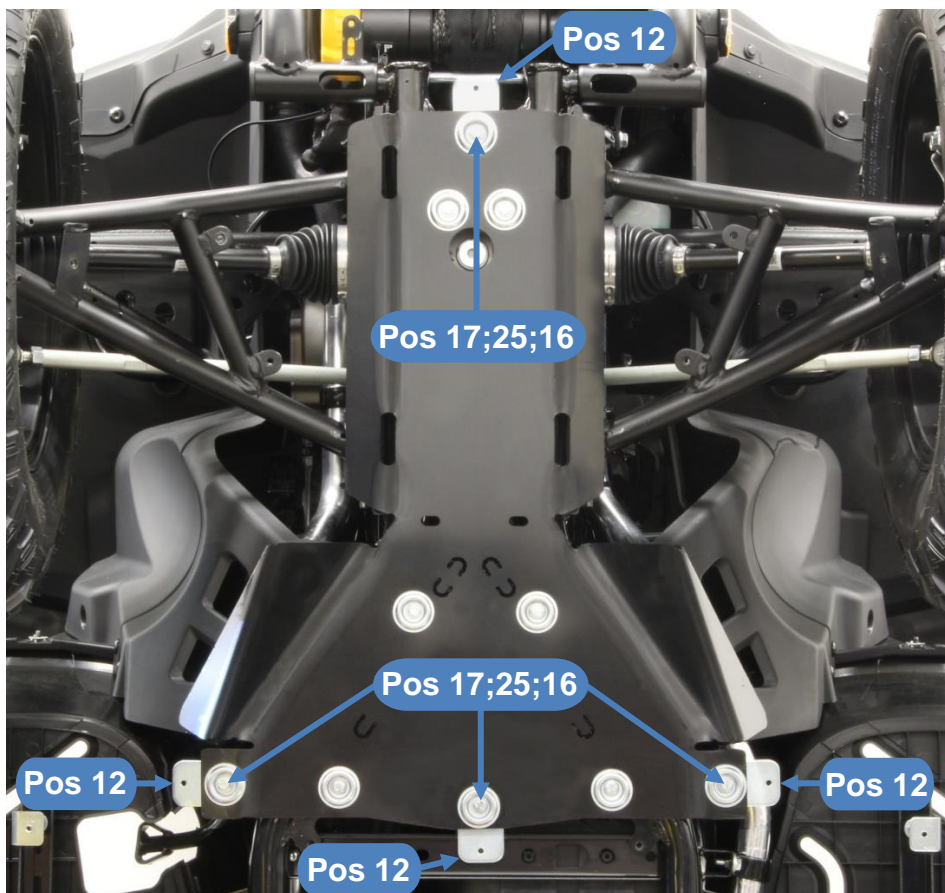

## Step 6

Install the front protection (Pos.1) and winch fairlead. For fastening use M6x14 bolt (Pos.17), M6x30 bolts (Pos.20), M10x30 bolts (Pos.24), Ø6 mm washers (Pos.25) and dished washers (Pos.16).

**NB! Install all bolts in place before tightening them!**

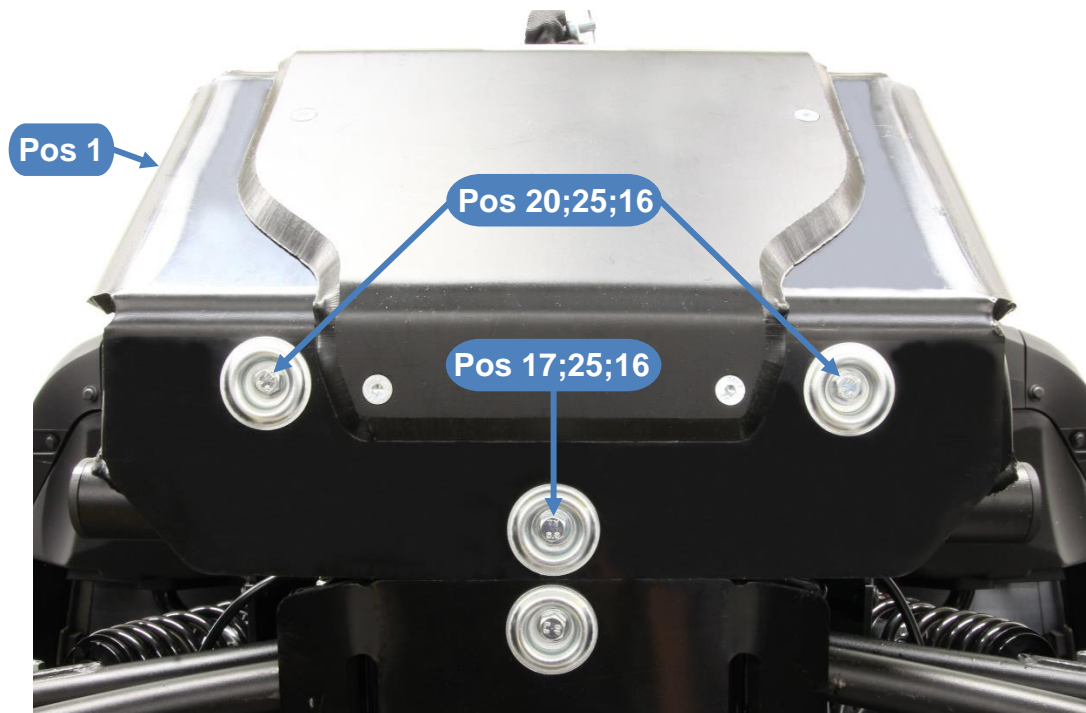

## Step 7

Install the middle protection (Pos.3). For fastening use M6x14 bolt (Pos.17), M6x20 bolts (Pos.18), Ø6 mm washers (Pos.25) and dished washers (Pos.16).

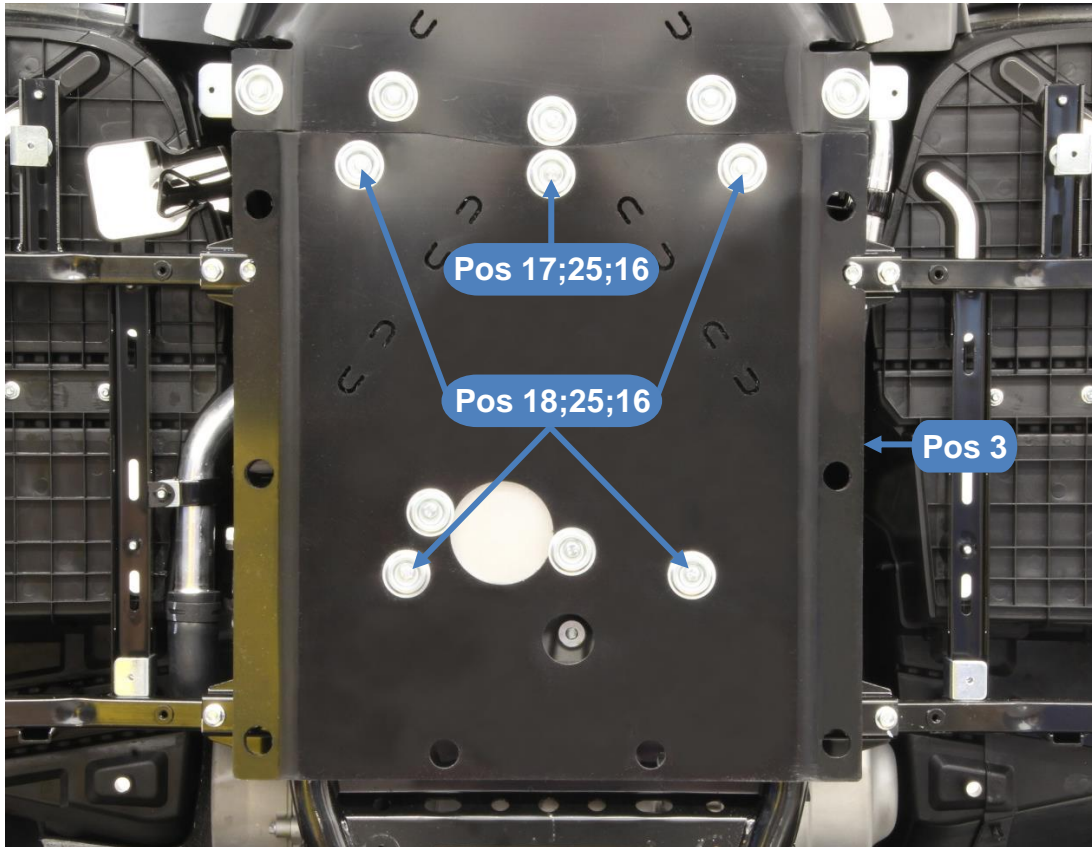

## Step 8

Install the connecting plates (Pos.12) to the middle protection. For fastening use M6x14 bolts (Pos.17), Ø6 mm washers (Pos.25) and dished washers (Pos.16).

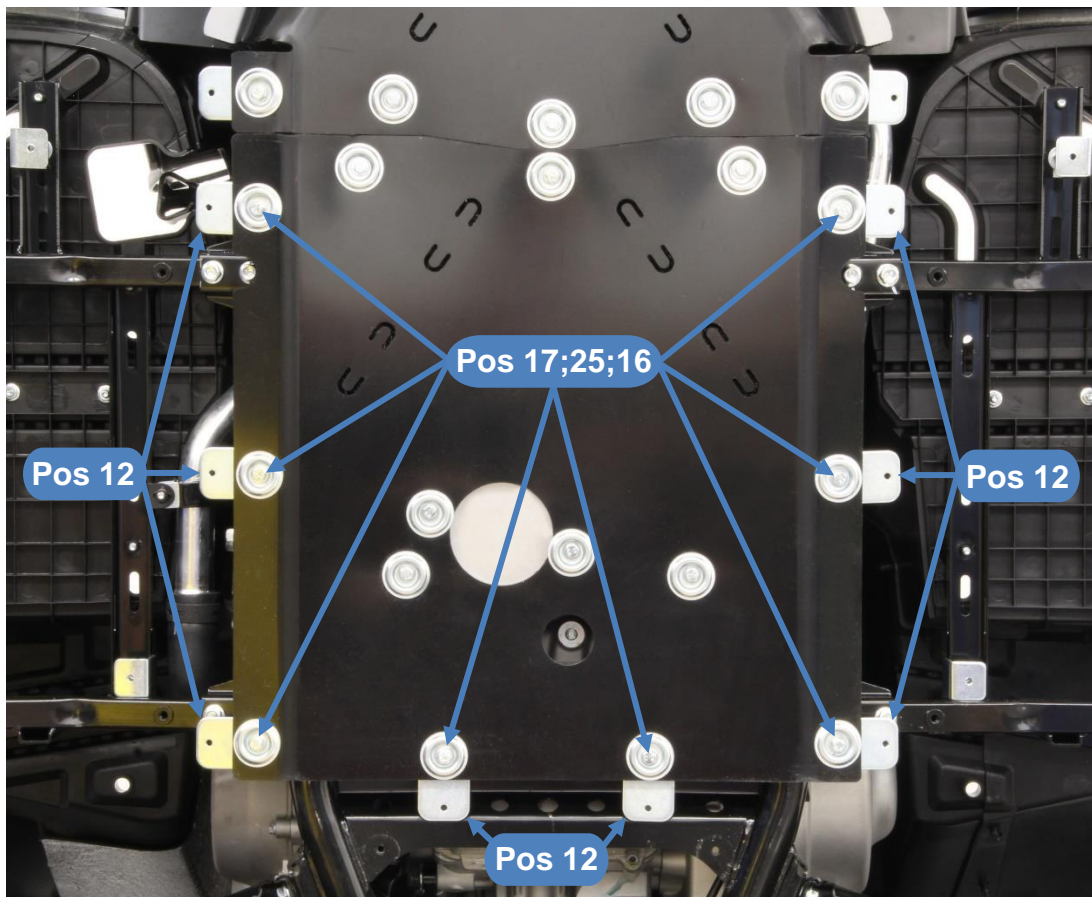

## Step 9

Install the rear protection (Pos.5). For fastening use M6x14 bolts (Pos.17), M6x25 bolts (Pos.19; Pos.23), M6x30 bolts (Pos.20), Ø6 mm washers (Pos.25), Ø6 mm conical washers (Pos.15) and dished washers (Pos.16).

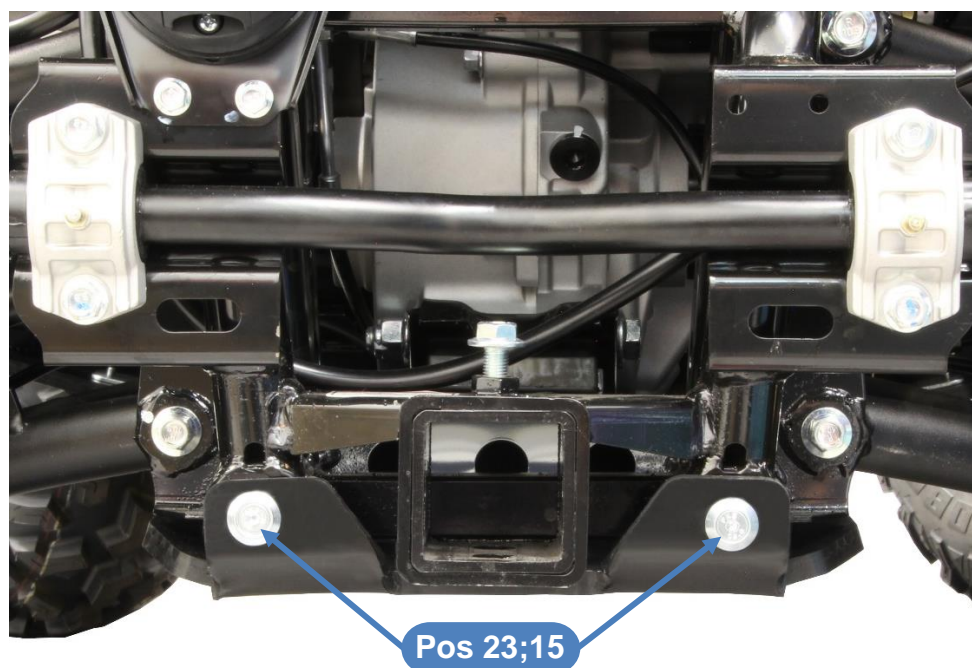
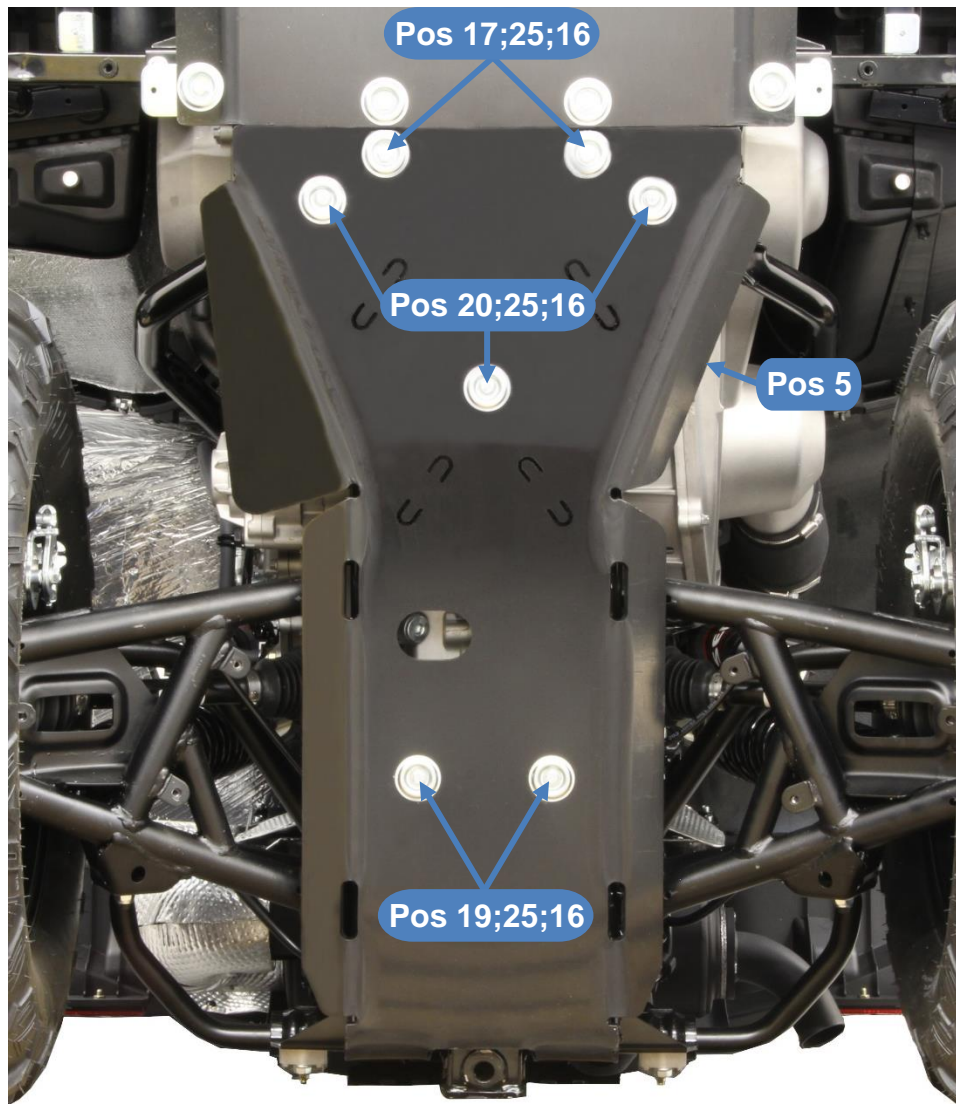

## Step 10

Install the side protections (Pos.6; Pos.7). For fastening use M6x14 bolts (Pos.17), M6x25 bolts (Pos.19), M6x45 bolts (Pos.21), Ø6 mm washers (Pos.25) and dished washers (Pos.16). The edges of skid plate edge go outwards. If necessary, press the side protection or the edge of the ATV's original plastic inward to ensure proper fit.

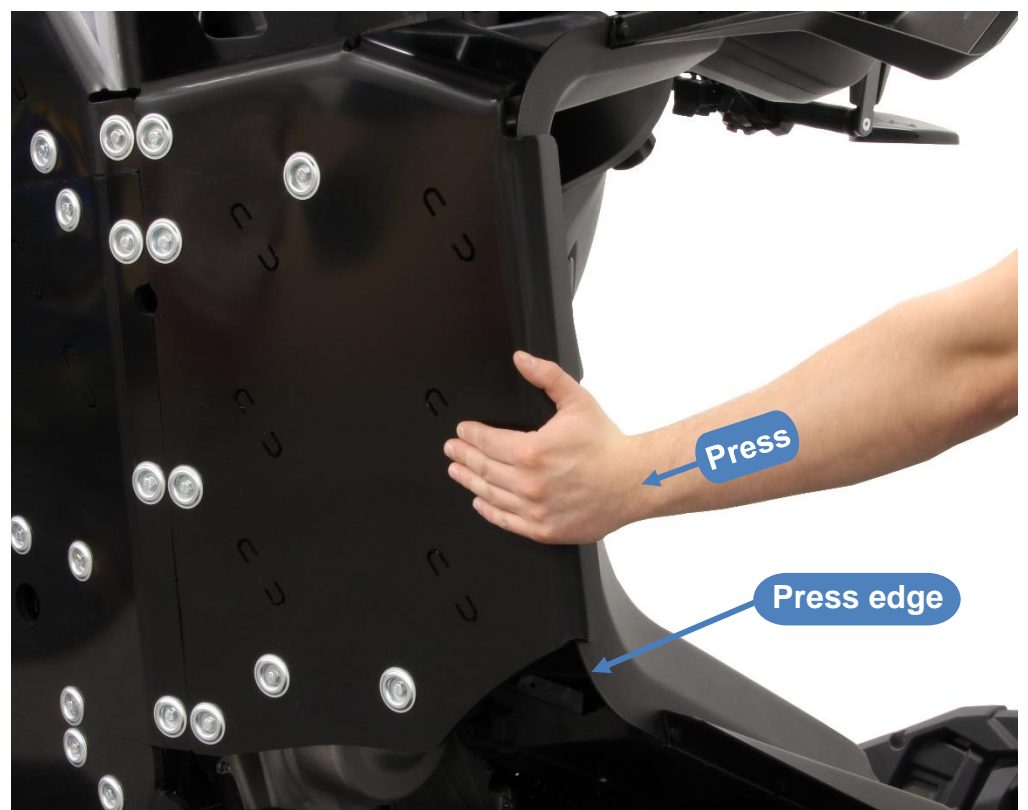
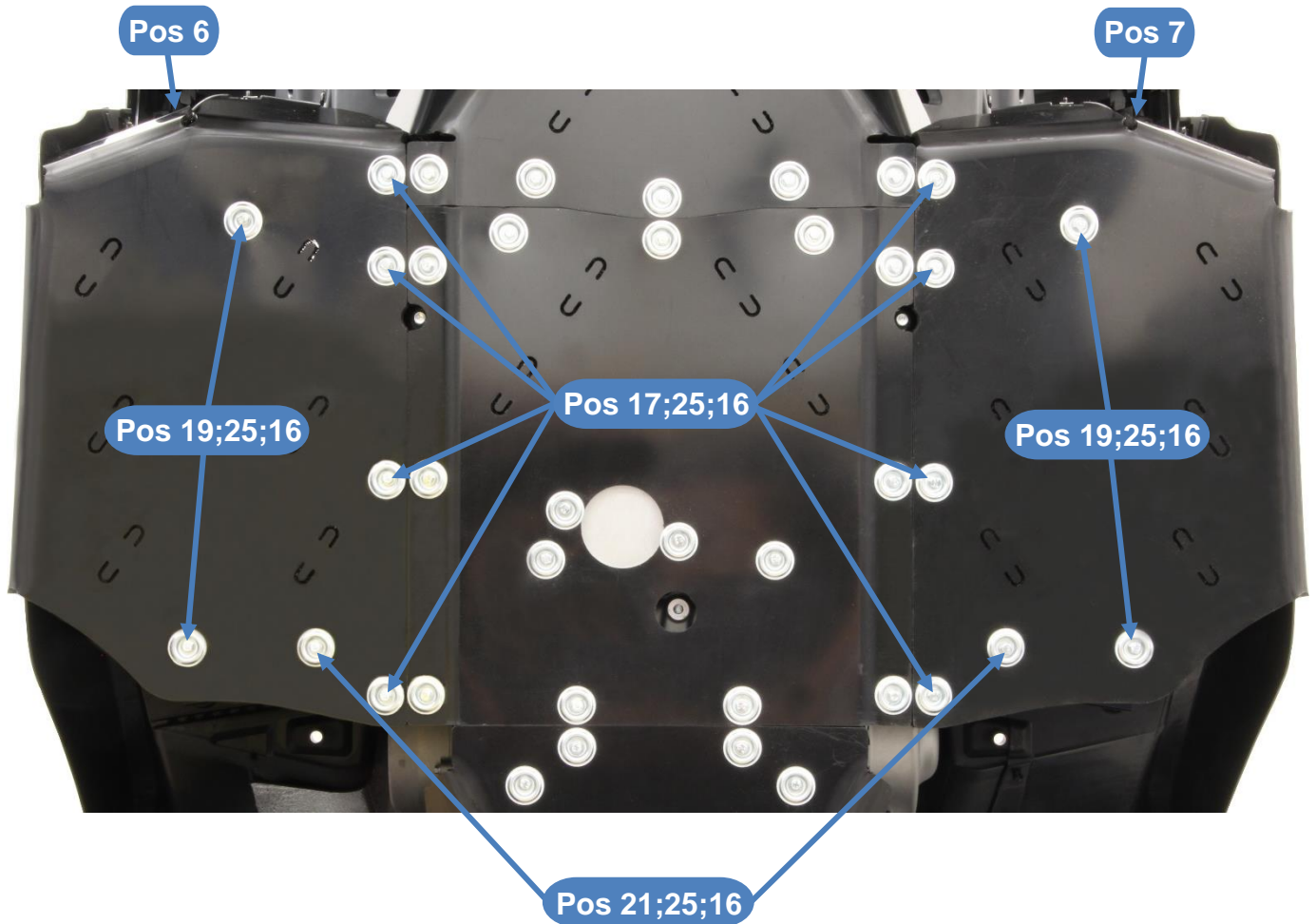

## Step 11

Install front arm protections (Pos.8; Pos.9). For fastening use M6x20 bolts (Pos.18), M6x25 bolts (Pos.19), Ø6 mm washers (Pos.25), dished washers (Pos.16) and clamps (Pos.14).

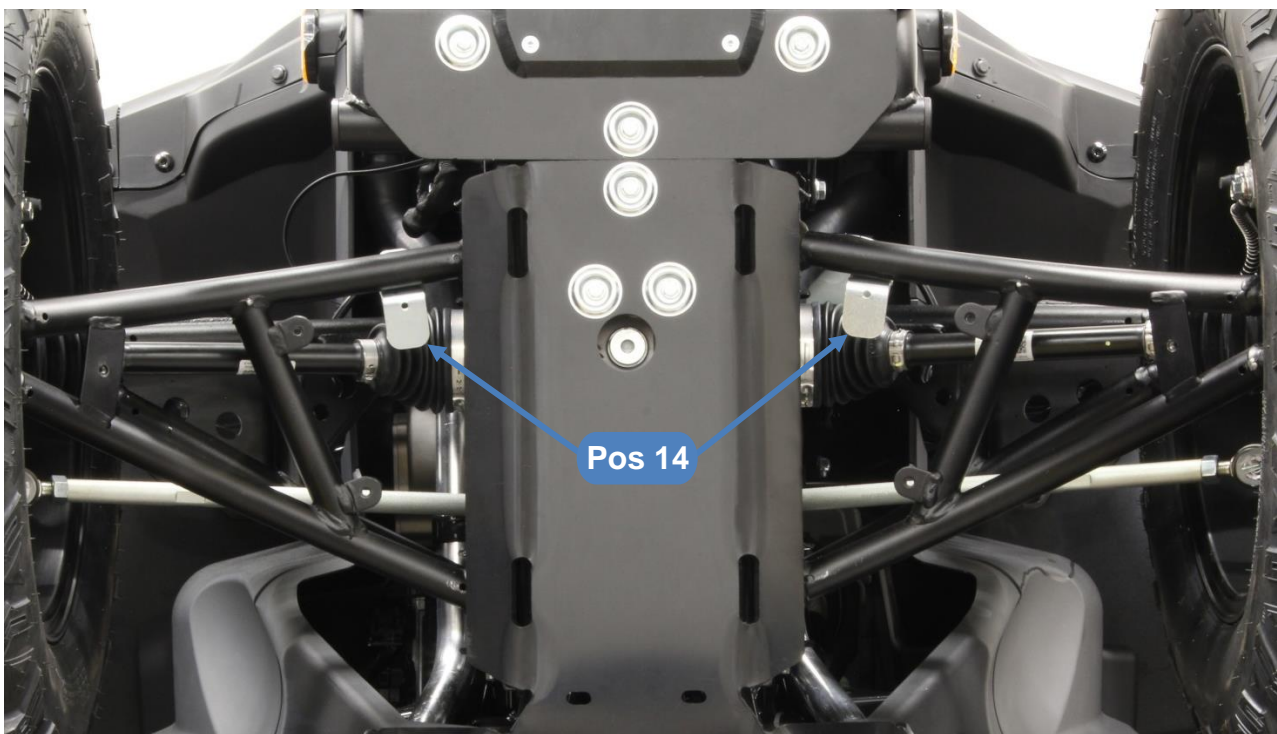
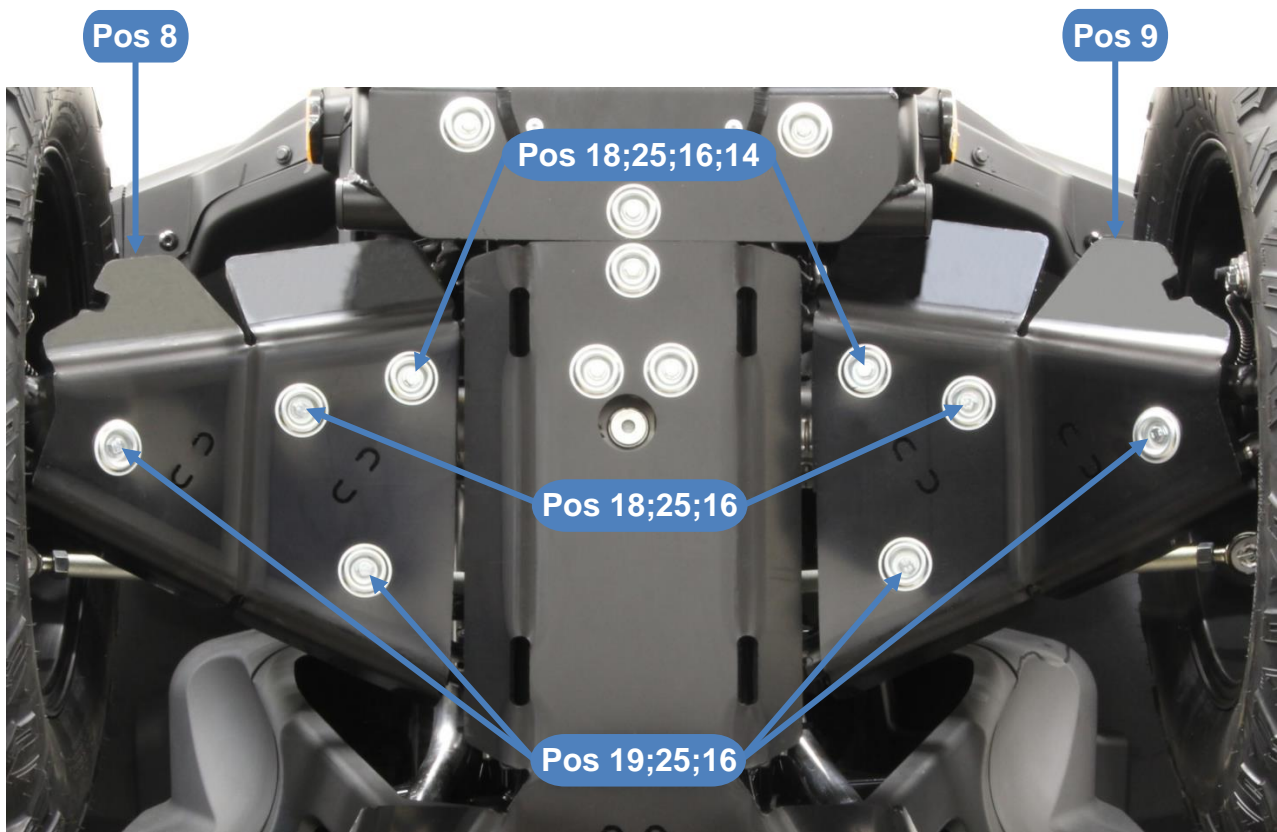

## Step 12

Install rear arm protections (Pos.10; Pos.11). For fastening use M6x20 bolts (Pos.18), M6x25 bolts (Pos.19), Ø6 mm washers (Pos.25) and dished washers (Pos.16).

Remove the bolt holding the brake hose clamp, rotate the clamp 180 degrees so that the hose runs along the control arm tube, as shown in the picture, and then reinstall the bolt.

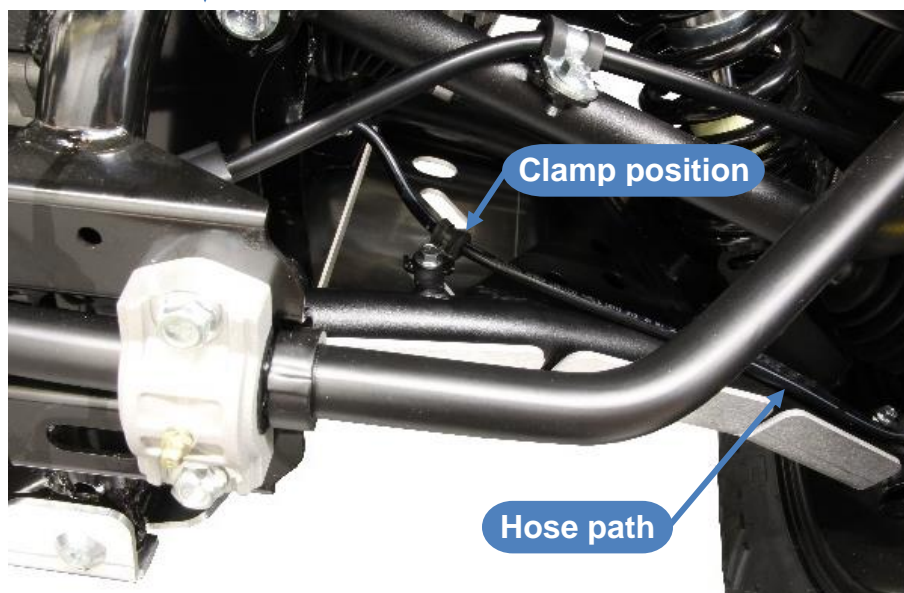
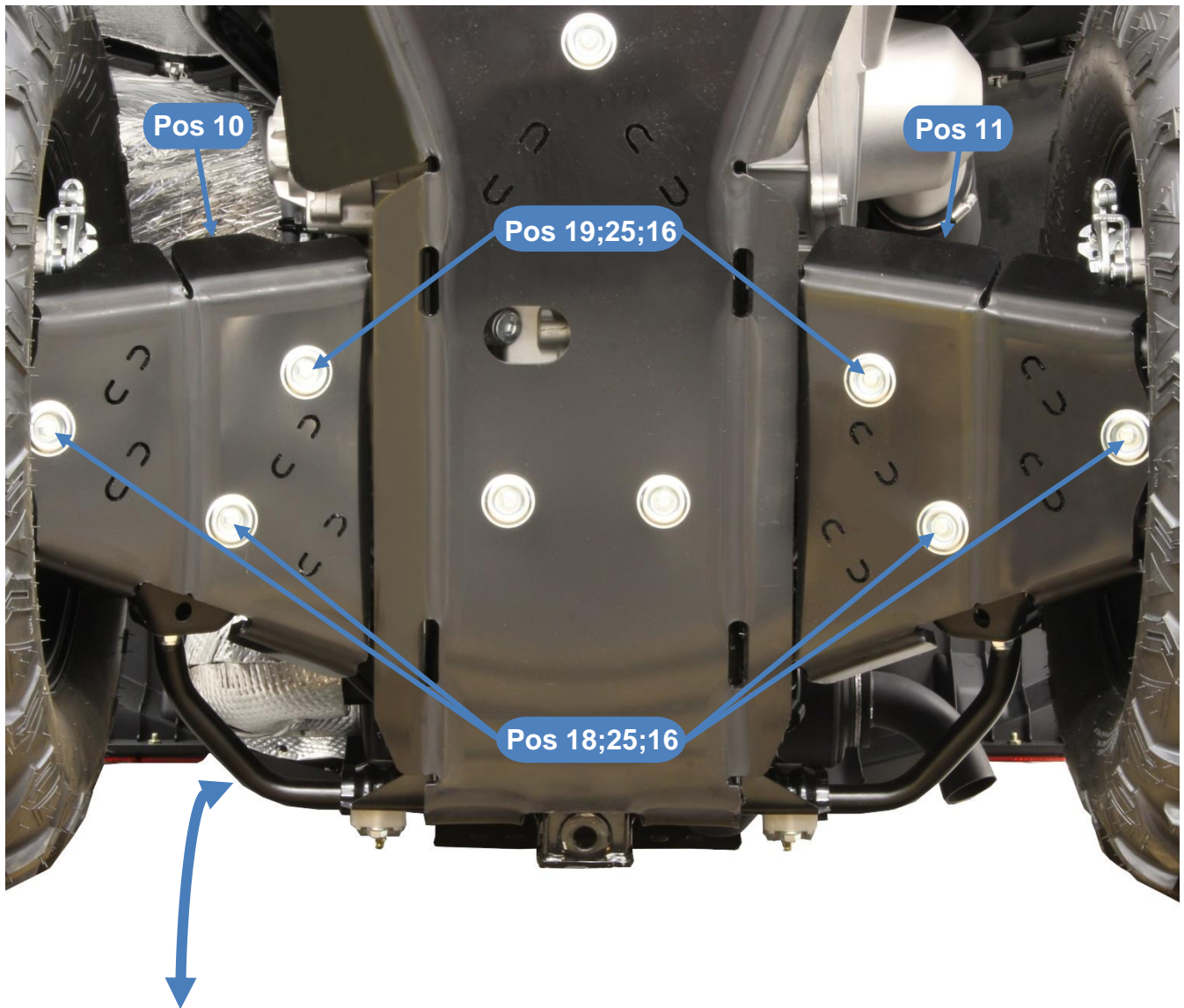

### Step 13

To remove the oil cover plate, remove the bolts indicated by the arrows and loosen the other bolts. Then remove the plate from the right side of ATV, as shown in the pictures.

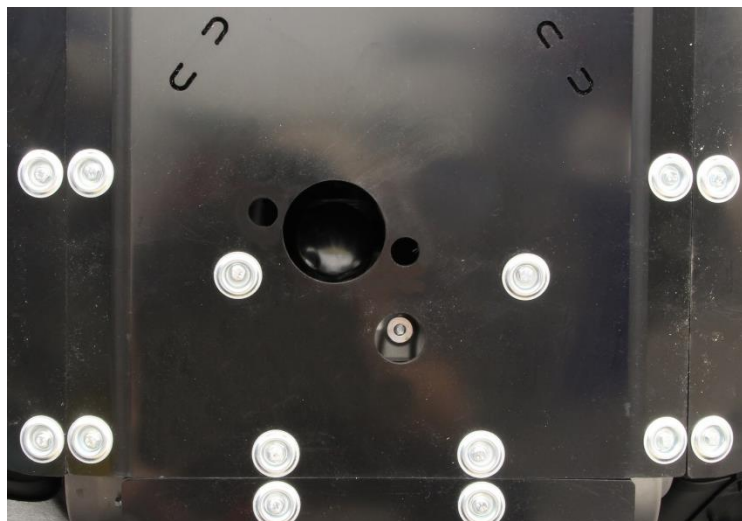
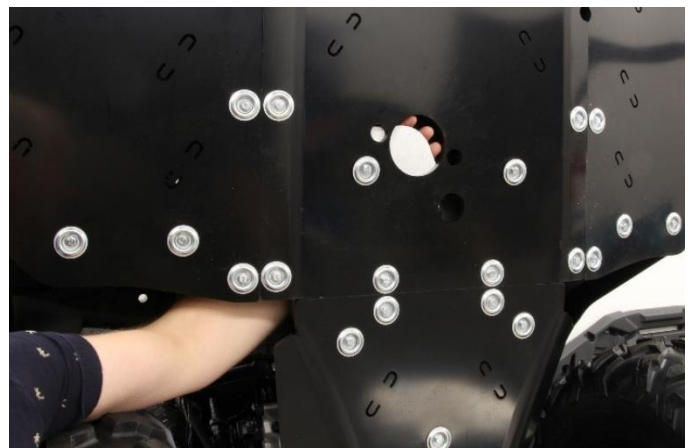
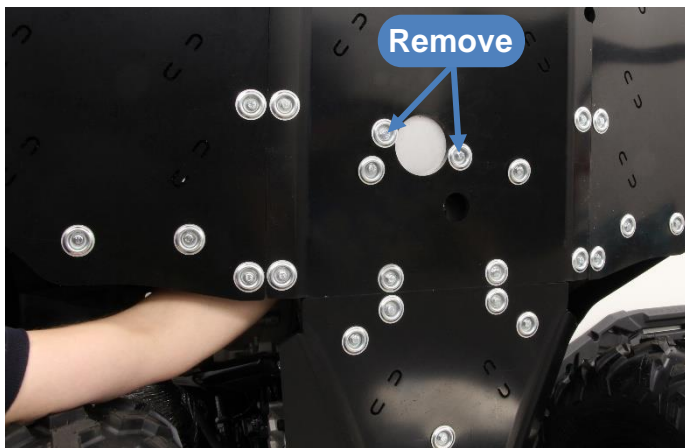
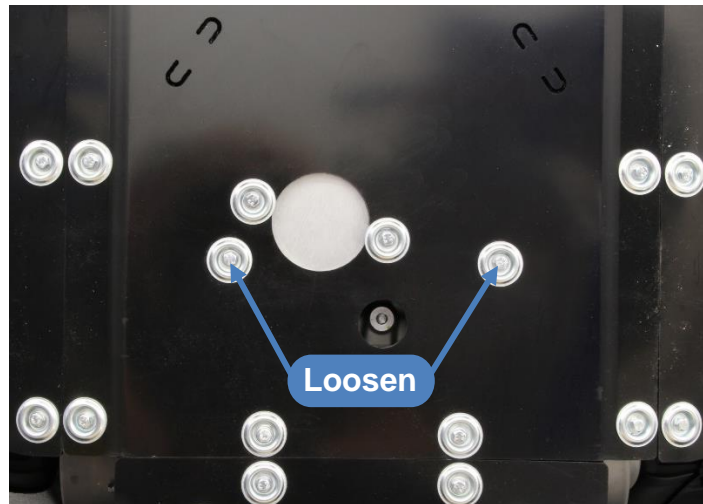



# IRON BALTIC

IRON BALTIC OÜ  
Joa tee 17  
Vääna 76903  
Estonia / Europe

+372 6 533 711  
[sales@ironbaltic.com](mailto:sales@ironbaltic.com)

[www.ironbaltic.com](http://www.ironbaltic.com)  
[www.facebook.com/ironbaltic](https://www.facebook.com/ironbaltic)  
[www.youtube.com/user/ironbalticLtd](https://www.youtube.com/user/ironbalticLtd)