

IRON BALTIC

PLASTIC SKID PLATE

POLARIS

500 Sportsman

Code 02.2350

Version 01102023

DOWNLOAD MULTILINGUAL
USER MANUAL



code.ironbaltic.com/u/66AnsGuX

Keep this manual for future reference!

If you need any spare parts, please send this packaging data to your local dealer or to Iron Baltic
sales@ironbaltic.com

SPECIFICATION

Pos.	Description	Code	Amount
1	Skid plate	02.2351	1
2	Front left arm protection	02.1412	1
3	Front right arm protection	02.1413	1
4	Rear left arm protection	02.1414	1
5	Rear right arm protection	02.1415	1
6	Intallation plate (150mm x 250mm)	02.1605K	1
7	Intallation plate (250mm x 250mm)	02.2302K	1
8	Intallation plate (40mm x 40mm)	02.2304	2
9	Intallation plate (30mm x 30mm)	02.2305	2
10	Clamp (right)	02.1416	1
11	Clamp (left)	02.1417	1
12	Clamp	02.1418	2
13	Installation part	02.4011	2
14	Screw 3/16" UNC 1" x 16	DIN912	4
15	Bolt M6x30 DIN7991	OT.02.04.050	12
16	Bolt M6x25 DIN7991	OT.02.04.040	8
17	Bolt M8x35 DIN7991	OT.02.04.180	15
18	Washer Ø5/15 DIN9021	OT.04.02.010	4
19	Washer Ø6/18 DIN9021	OT.04.02.020	8
20	Conical washer Ø6	14.502	12
21	Washer Ø8/20 SFS3738	OT.04.03.020	3
22	Conical washer Ø8	14.501	15
23	Nyloc nut M6 DIN985	OT.03.02.030	8
24	Nyloc nut M8 DIN985	OT.03.02.040	3

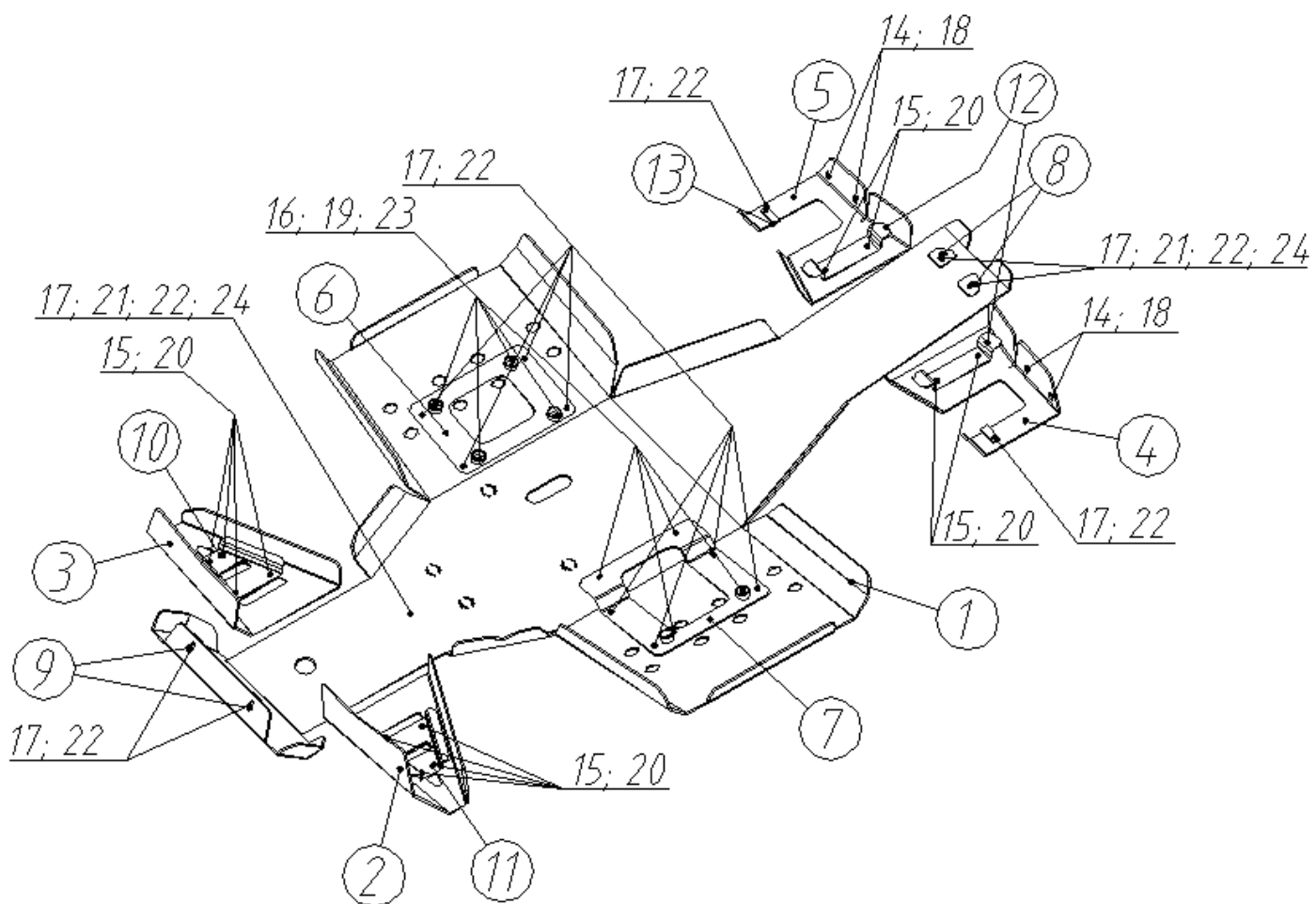

IRON BALTIC

IRON BALTIC OÜ
Joa tee 17
Vääna 76903
Estonia / Europe

+372 6 533 711
sales@ironbaltic.com

www.ironbaltic.com
www.facebook.com/ironbaltic
www.youtube.com/user/ironbalticLtd

