

# IRON BALTIC

## PLASTIC SKID PLATE

# GOES

## Iron/ Cobalt (MAX)

Code 02.19700

Version 11092023

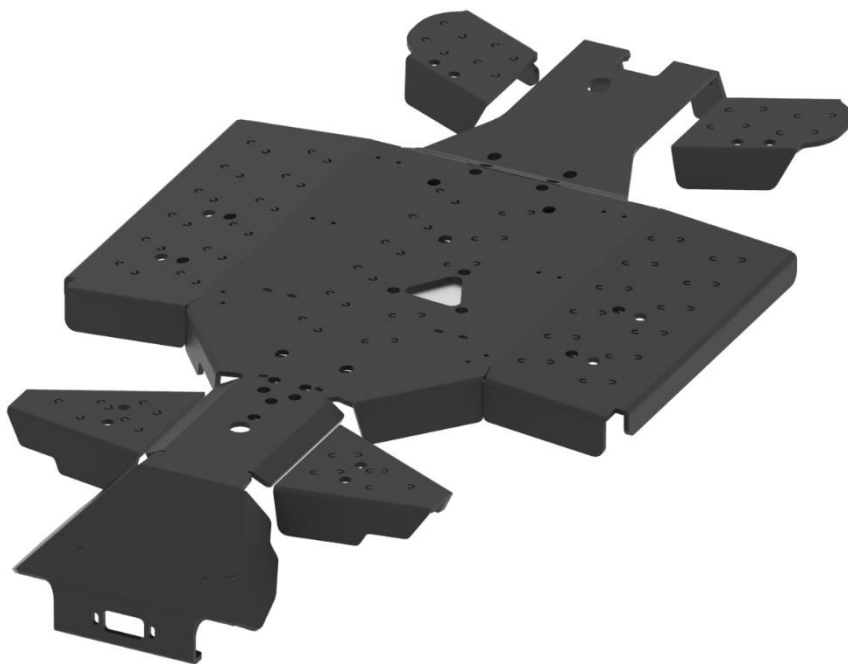

**Keep this manual for future reference!**

If you need any spare parts, please send this packaging data to your local dealer or to Iron Baltic  
[sales@ironbaltic.com](mailto:sales@ironbaltic.com)

Iron Baltic Ltd | +372 653 3711 | [sales@ironbaltic.com](mailto:sales@ironbaltic.com) | [www.ironbaltic.com](http://www.ironbaltic.com)

DOWNLOAD MULTILINGUAL  
USER MANUAL



[code.ironbaltic.com/u/uI9yyISB](http://code.ironbaltic.com/u/uI9yyISB)

# SPECIFICATION

Pos.	Nimetus	Kood	Kogus
1	Middle part	02.19701K	1
2	Front part	02.19702	1
3	Rear part	02.19703K	1
4	Front left arm protection	02.1137V+	1
5	Front right arm protection	02.1137P+	1
6	Rear left arm protection	02.1138V+	1
7	Rear right arm protection	02.1138P+	1
8	Right side protection	02.11004	1
9	Left side protection	02.11005	1
10	Oil drain cover	02.15006	1
11	Front protection bracket	02.19604	1
12	Installation plate	02.718	3
13	Plate	02.5006	8
14	Bracket	02.6408	4
15	Plate (20)	02.8311	2
16	Angle	03.1502	2
17	Clamp 38mm	OT.05.04.030	2
18	Dished washer	14.503	32
19	Screw 4,8x25 DIN 7504-K	OT.01.02.055	2
20	Bolt M6x16 DIN 933	OT.02.02.050	22
21	Bolt M6x25 DIN 933	OT.02.02.070	7
22	Bolt M6x45 DIN 933	OT.02.02.110	4
23	Bolt M6x55 DIN 933	OT.02.02.130	2
24	Bolt M6x65 DIN 933	OT.02.02.145	4
25	Bolt M8x30 DIN 933	OT.02.02.200	2
26	Bolt M6x20 DIN 7991	OT.02.04.030	12
27	Bolt M6x25 DIN 7991	OT.02.04.040	2
28	Bolt M8x25 DIN 7991	OT.02.04.160	2
29	Conical washer Ø6	14.502	14
30	Conical washer Ø8	14.501	2
31	Washer Ø5/15 DIN 9021	OT.04.02.010	2
32	Washer Ø6/15 SFS 3738	OT.04.03.020	47
33	Washer Ø8/20 SFS 3738	OT.04.03.030	2
34	Nyloc nut M6 DIN 985	OT.03.02.030	8

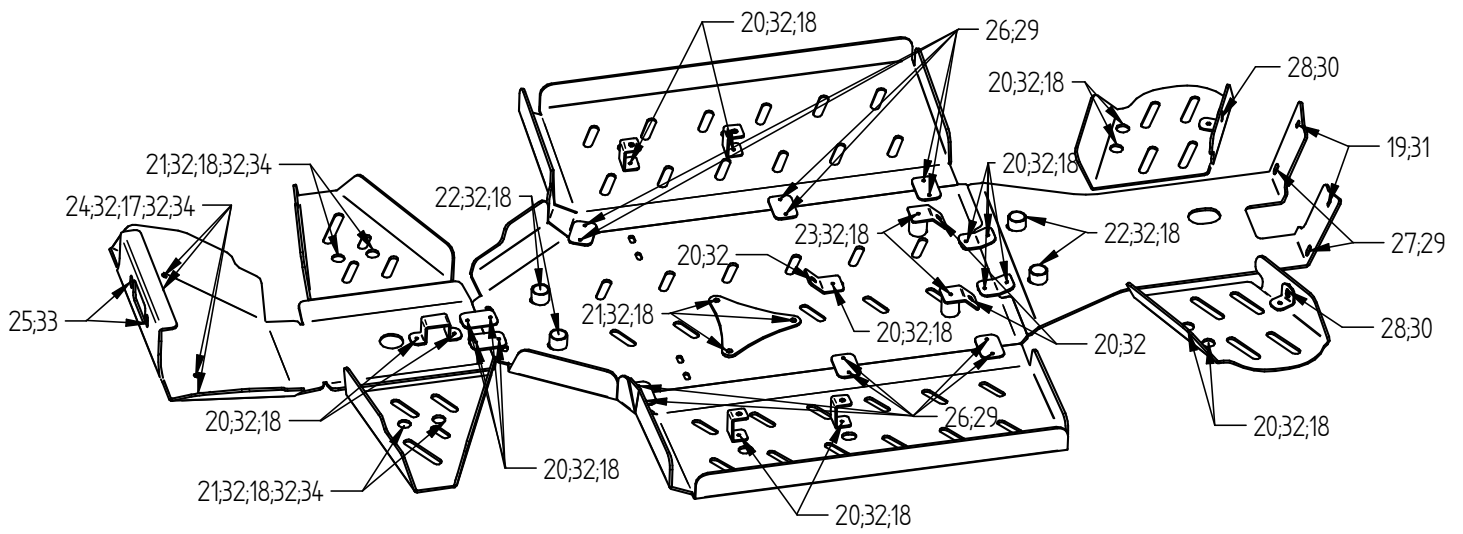
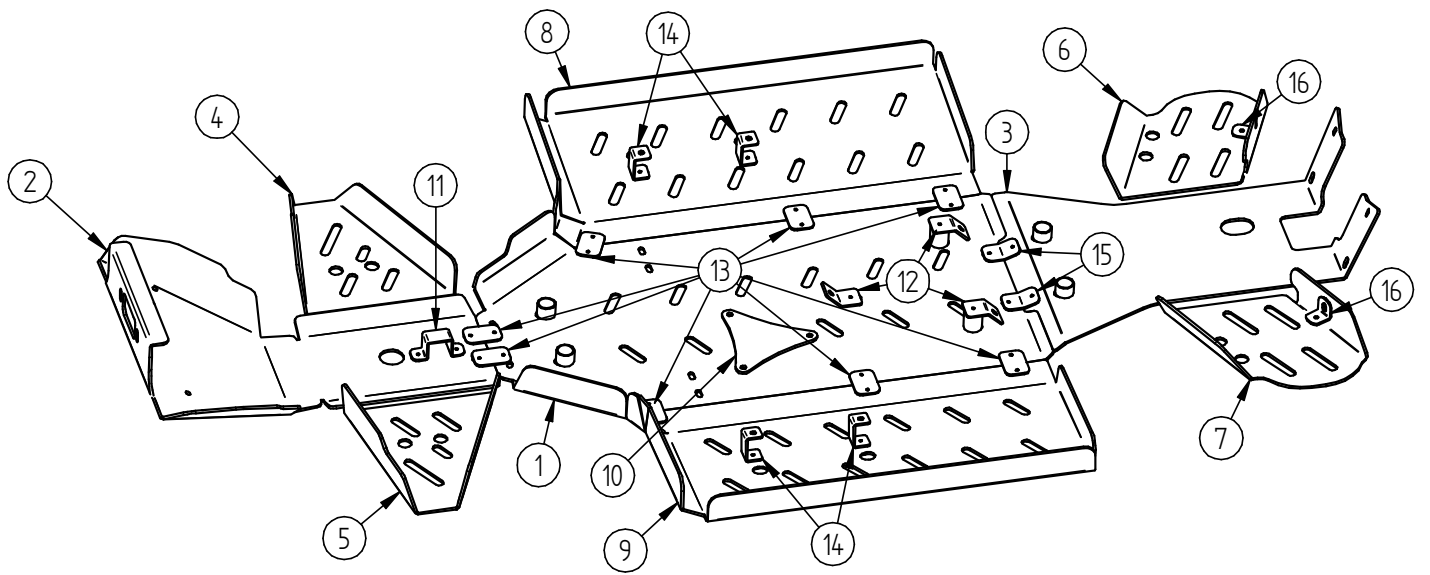

# FITTING INSTRUCTIONS

**Step 1** Remove all standard plastic covers and roller.



02.19700 Plastic skid plate Goes Iron / Cobalt (MAX)

**Step 2** Install installation plates 02.718 and 02.6408.

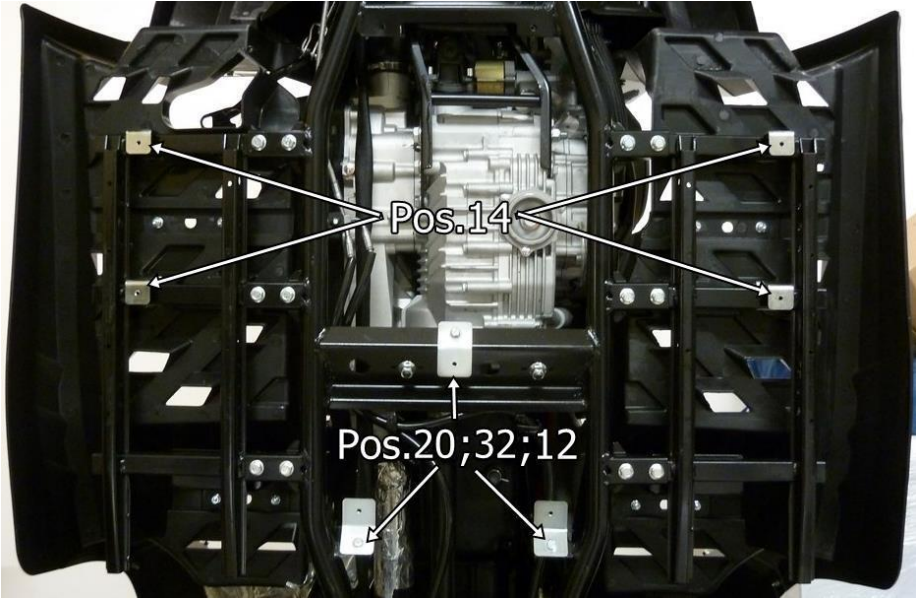
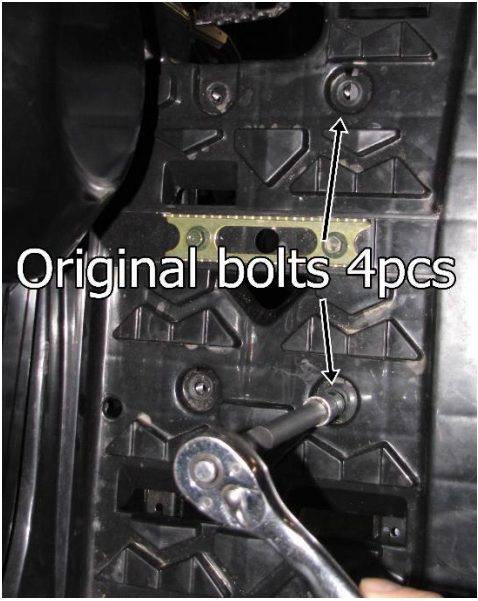

**Step 3** Install front a-arm protectors 02.1137V+ ja 02.1137P+.

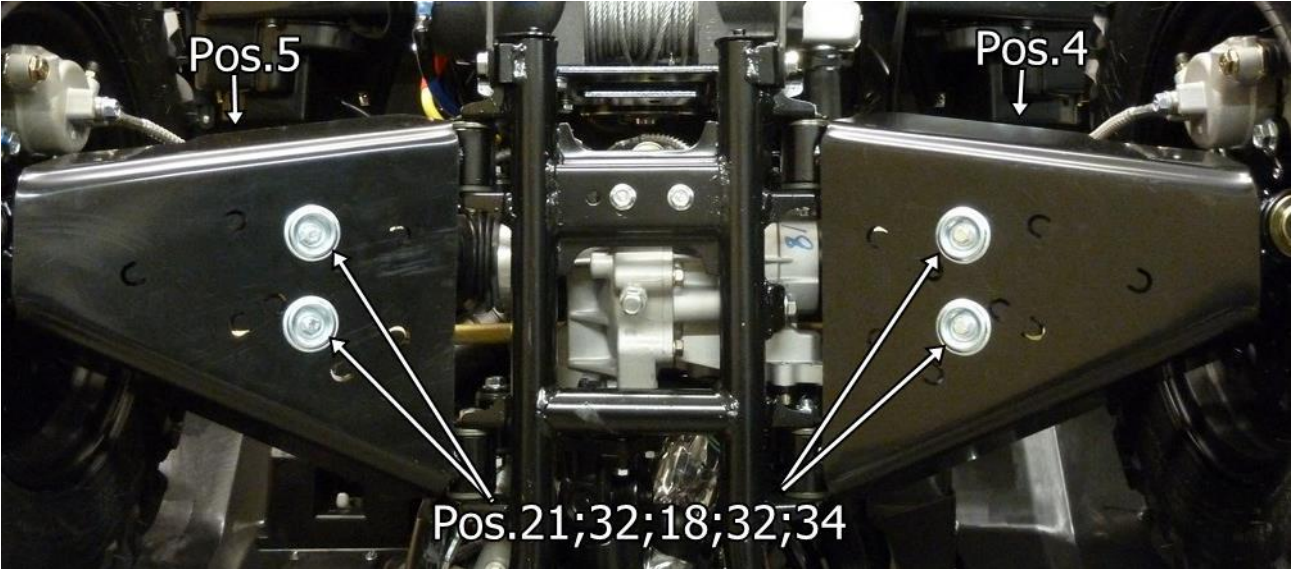

**Step 4** Install rear a-arm protectors 02.1138V+ ja 02.1138P+.

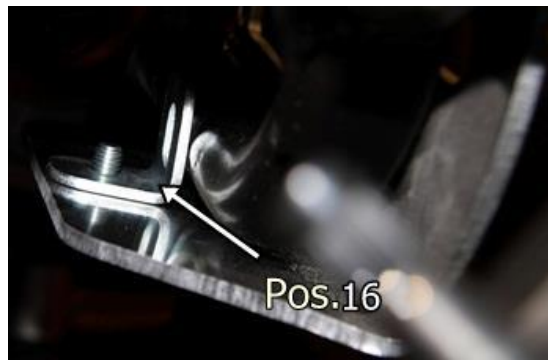
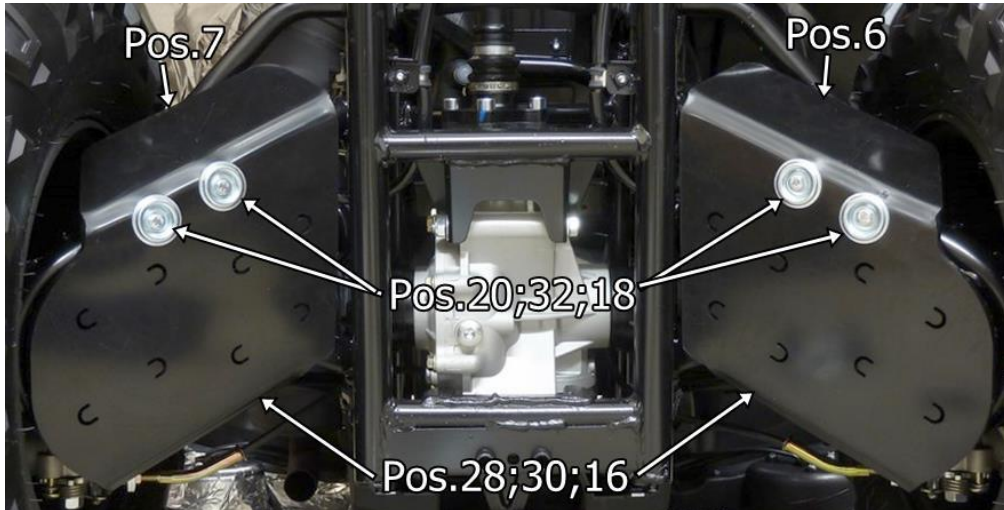

**Step 5** Install oil drain hole cover 02.15006 and install middle protection 02.19601K.



**Step 6** Install plates 02.5006 and 02.8311 to the middle part.

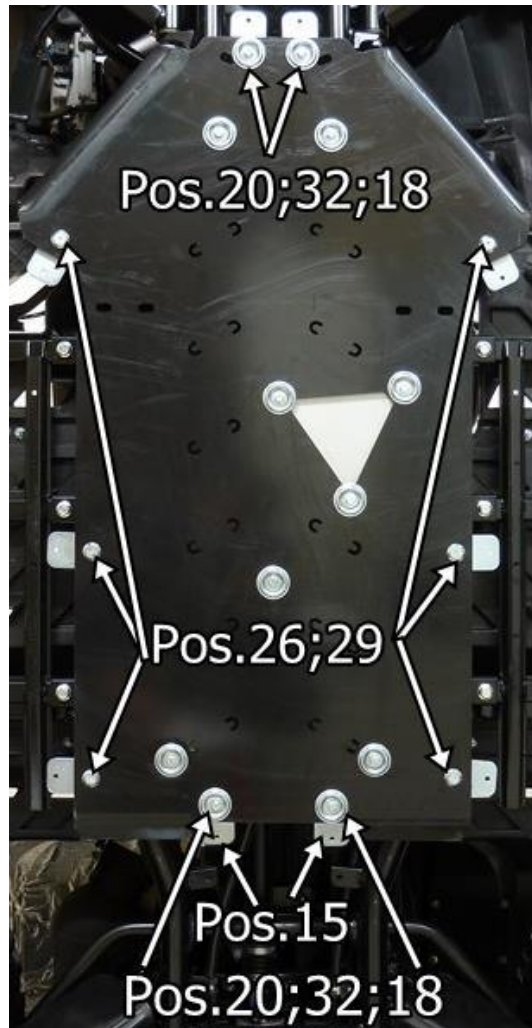

**Step 7** Install rear part 02.19703K.

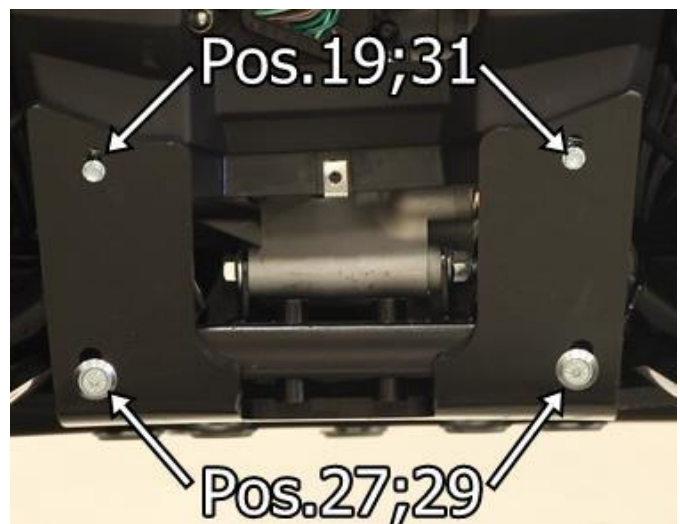
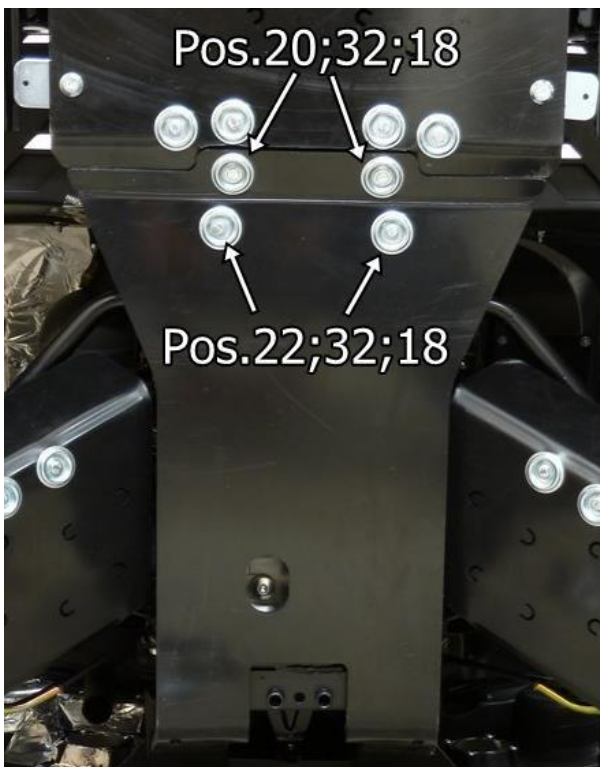

**Step 8** Install front protection 02.19702.

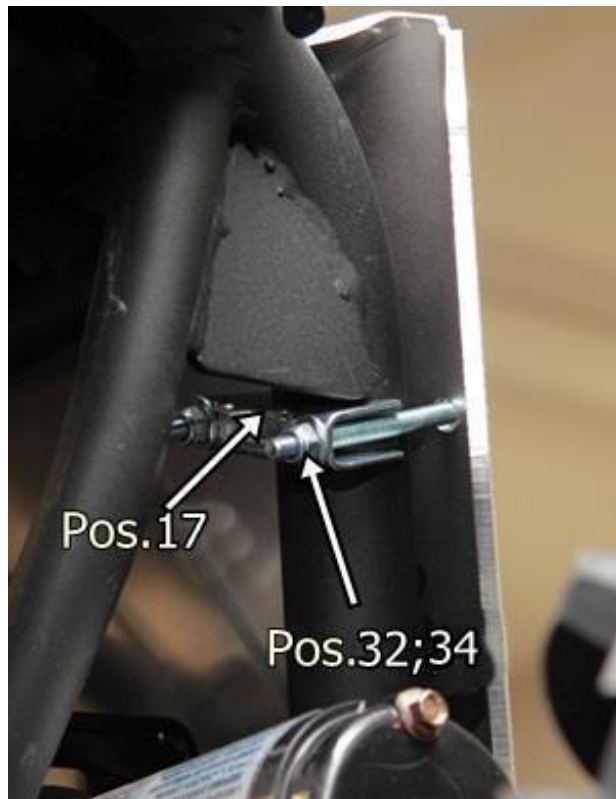

**Step 9** Install side protection 02.11004 and 02.11005.

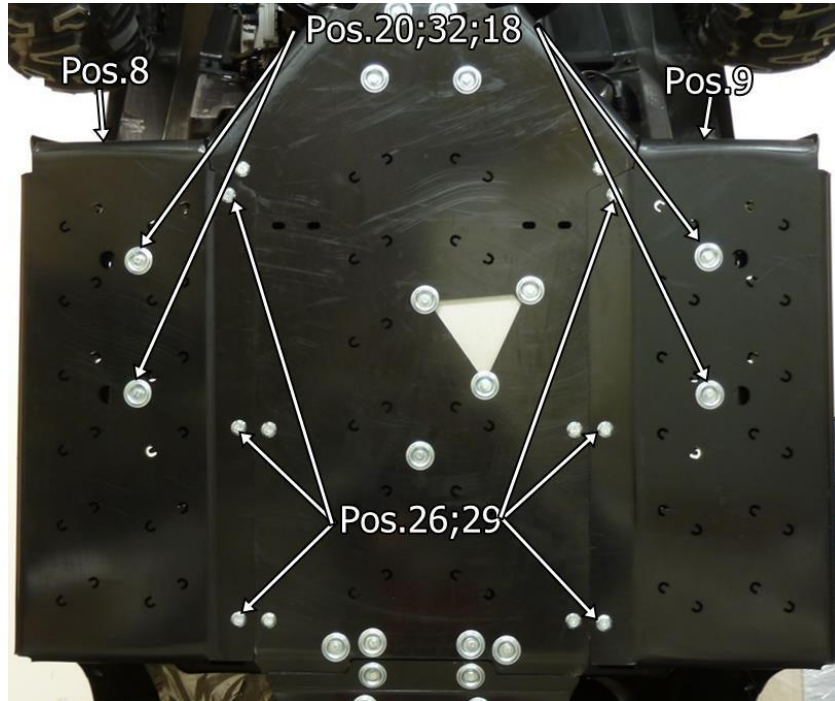

**Step 10** To remove the oil cover plate, remove two bolts indicated with arrows and loosen the third bolt. Slide the plate away.

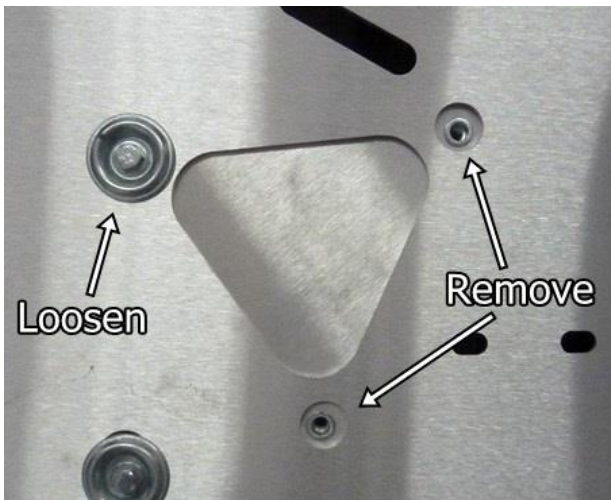





# IRON BALTIC

IRON BALTIC OÜ  
Joa tee 17  
Vääna 76903  
Estonia / Europe

+372 6 533 711  
[sales@ironbaltic.com](mailto:sales@ironbaltic.com)

[www.ironbaltic.com](http://www.ironbaltic.com)  
[www.facebook.com/ironbaltic](https://www.facebook.com/ironbaltic)  
[www.youtube.com/user/ironbalticLtd](https://www.youtube.com/user/ironbalticLtd)

